

FLAT 2

FLATS 1,2 & 6 'MOONRAKERS', GARRISON LANE,  
ST MARY'S, ISLES OF SCILLY.

GROUND FLOOR FLAT 2

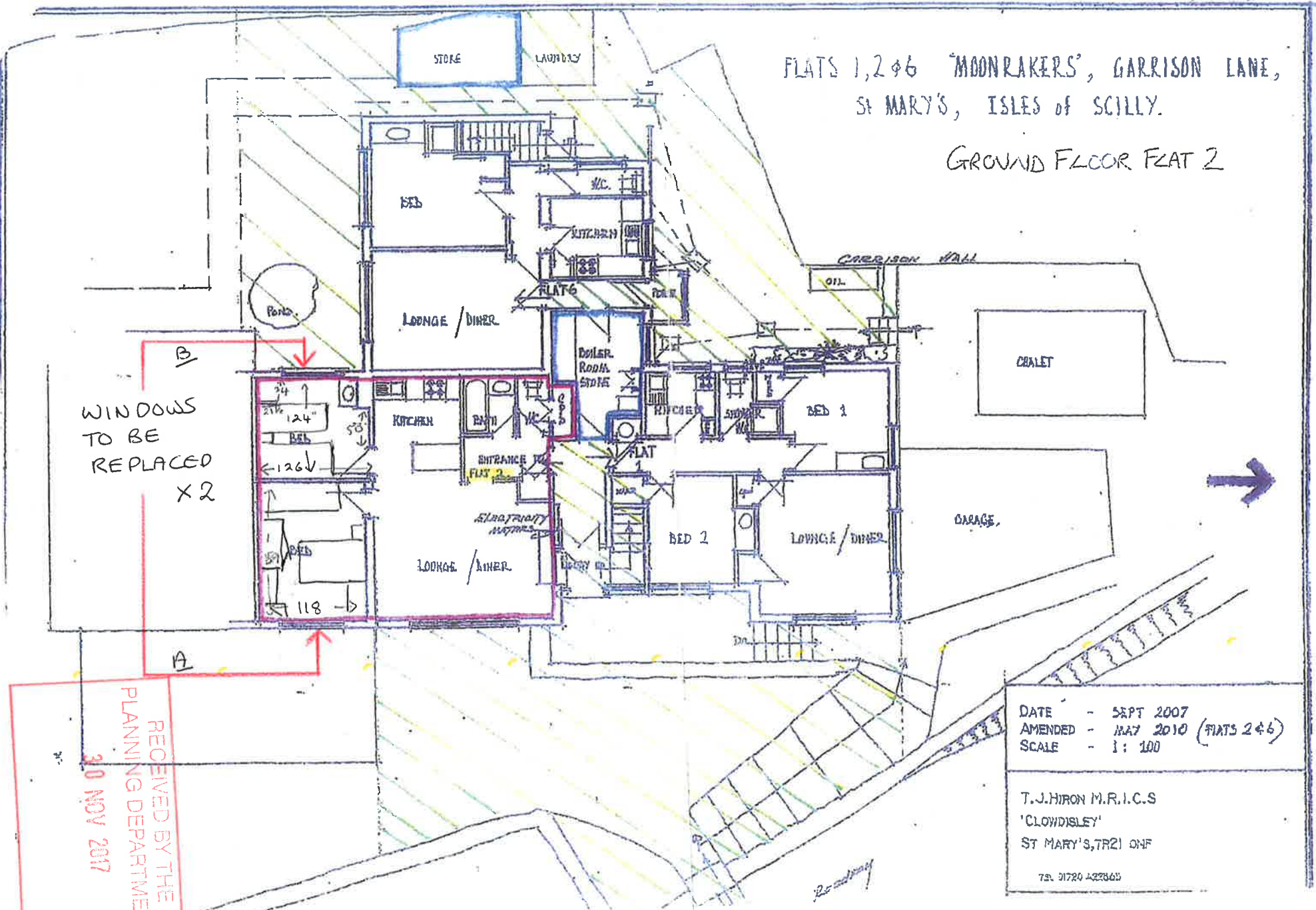

WINDOWS  
TO BE  
REPLACED  
X 2

RECEIVED BY THE  
PLANNING DEPARTMENT  
30 NOV 2017

DATE	- SEPT 2007
AMENDED	- MAY 2010 (FLATS 2 & 6)
SCALE	- 1:100

T.J.HIRON M.R.I.C.S  
'CLOWDISLEY'  
ST MARY'S, TR21 0NF

73. 01720 423665

P-97-107