

NOTES

Do not scale from this drawing unless for planning purposes. Figure dimensions only are to be used. All dimensions must be checked on site by the Contractor prior to the commencement of any fabrication or road works. In conjunction with specialist consultant drawings any discrepancy between drawings is to be brought to the attention of Smiths Gore prior to the commencement of any fabrication or building works. This drawing is for information only and may not be reproduced without their expressed permission.

REV	NOTE / DRAWN BY	DATE
A	Walkway added (DB)	25.03.12

CLIENT: DUCHY OF CORNWALL

PROJECT TITLE: HARBOURSIDE BUILDINGS THE QUAY, ST. MARY'S ISLES OF SCILLY

PROPOSED SEWAGE TREATMENT PLAN

SCALE: 1 : 250 @ A1

DRAWING STATUS: PLANNING

DRAWN BY: MS/DB

CHECKED BY: PWO

DATE: MARCH 12



smithsgore.co.uk

CLIENT: DUCHY OF CORNWALL

PROJECT TITLE: HARBOURSIDE BUILDINGS THE QUAY, ST. MARY'S ISLES OF SCILLY

PROPOSED SEWAGE TREATMENT PLAN

SCALE: 1 : 250 @ A1

DRAWING STATUS: PLANNING

DRAWN BY: MS/DB

CHECKED BY: PWO

DATE: MARCH 12

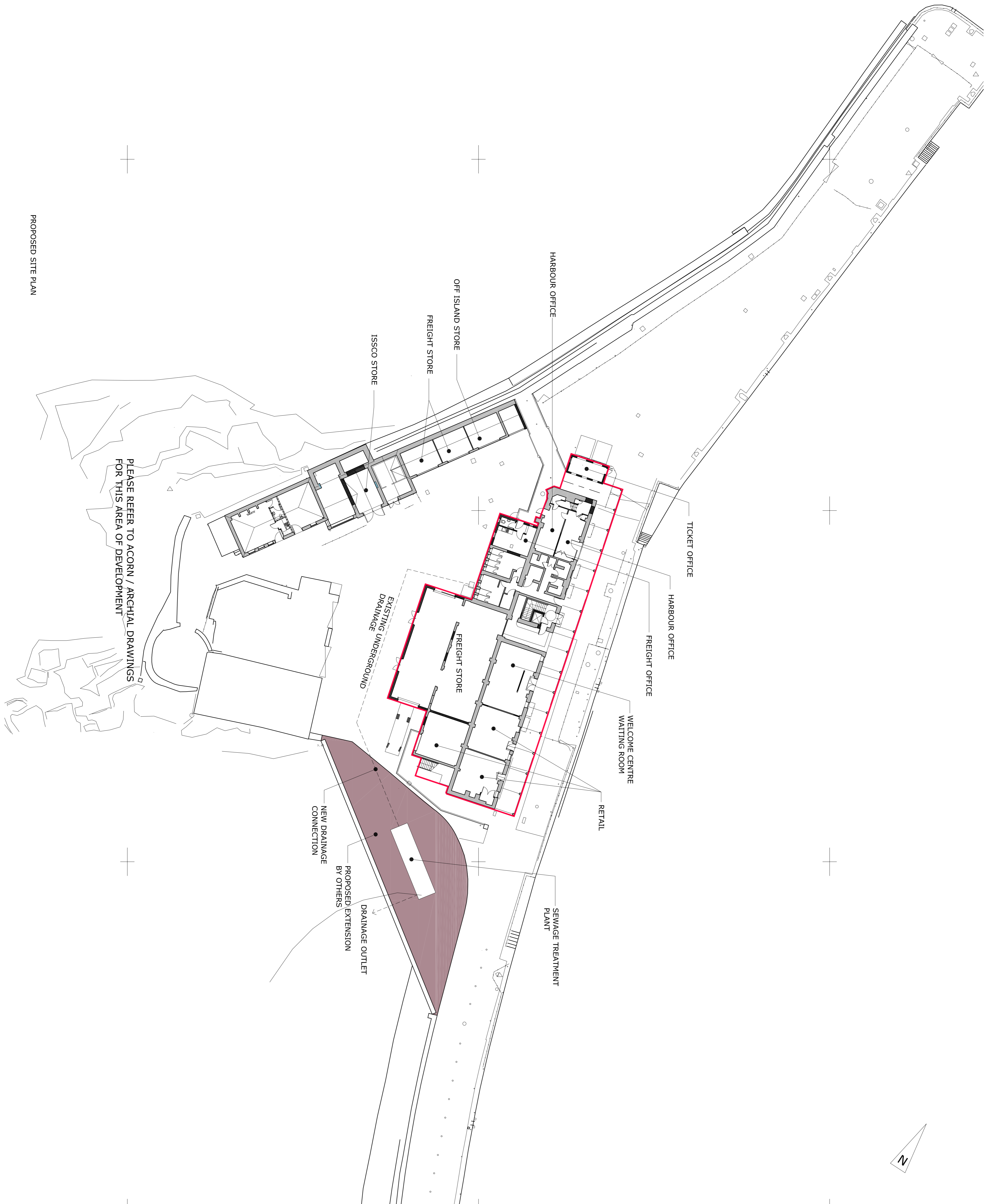

PLEASE REFER TO ACORN / ARCHIVAL DRAWINGS FOR THIS AREA OF DEVELOPMENT

PROPOSED SITE PLAN