

NOTES

Do not scale from this drawing unless for Planning purposes. Figured dimensions only are to be used. All dimensions must be checked on site by the Contractor prior to the commencement of any fabrication or building works. Where applicable, dimensions and details are to be read in conjunction with specialist consultants' drawings; any disparity between drawings is to be brought to the attention of Smiths Gore prior to the commencement of any fabrication or building works. This drawing is the property of Smiths Gore and may not be reproduced without their expressed permission.

REVISIONS

REV	NOTE / DRAWN BY	DATE
A	Walkway added (DB)	25.07.12
B	Revisions to Harbourside Building (DB)	06.09.12

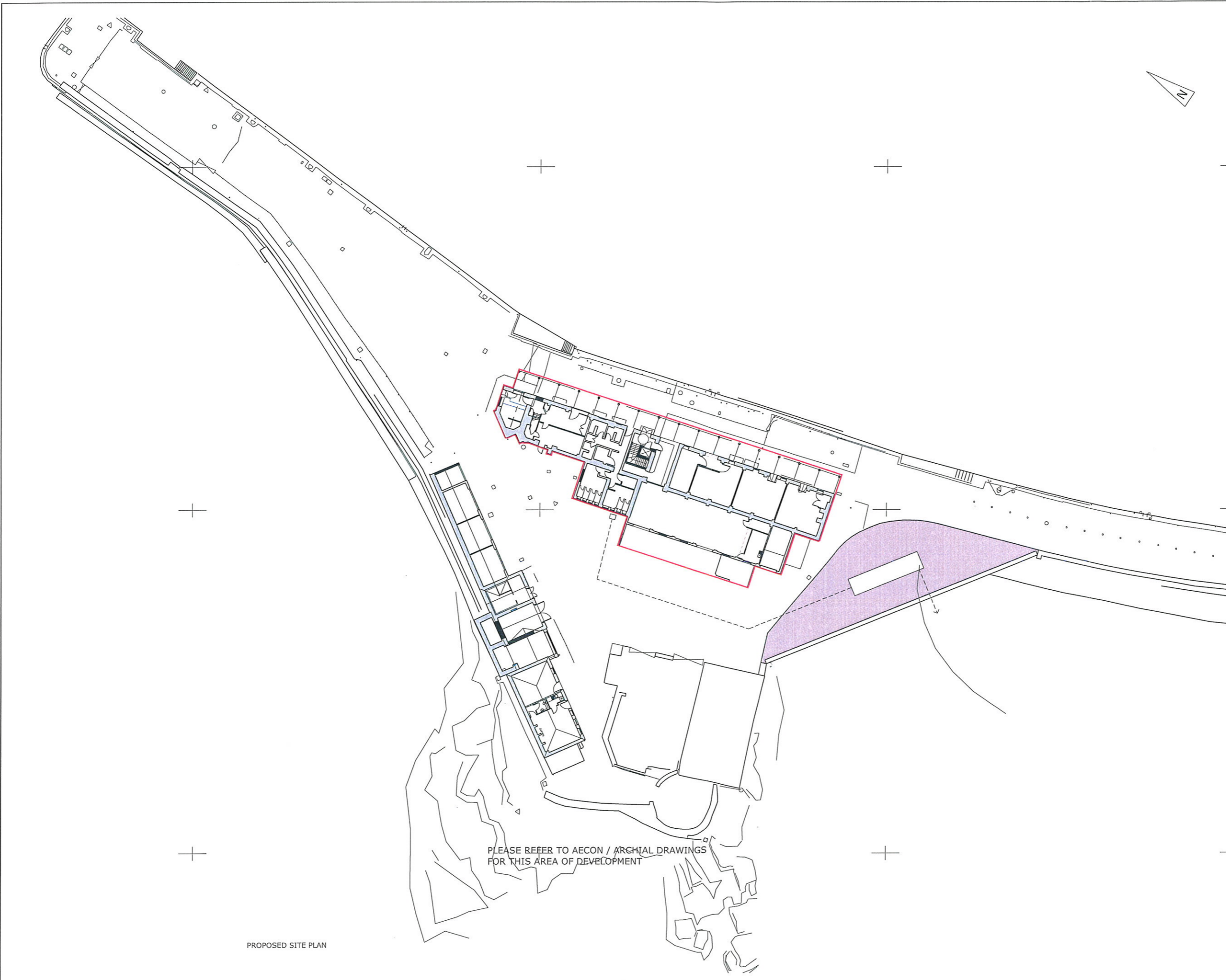

PLEASE REFER TO AECON / ARCHITECTURAL DRAWINGS FOR THIS AREA OF DEVELOPMENT

PROPOSED SITE PLAN



PROJECT TITLE
 HARBOURSIDE BUILDINGS
 THE QUAY, ST. MARY'S
 ISLES OF SCILLY

CLIENT
 DUCHY OF CORNWALL

DRAWING TITLE
SITE PLAN

PROPOSED SEWAGE TREATMENT PLAN

SCALE	PAPER SIZE	DRAWING NUMBER	REVISION
1 : 250 @A1		1033268/16	B

DRAWING STATUS
 PLANNING APPLICATION
 DRAWN BY MS/DB CHECKED BY PWO DATE MARCH 12

