

PROPOSED FARM BUILDING at SEAWAYS FARM, PORTHLOD,
 St MARY for A. MAY ESQ.

RECEIVED BY THE
 PLANNING DEPARTMENT
 20 APR 2015

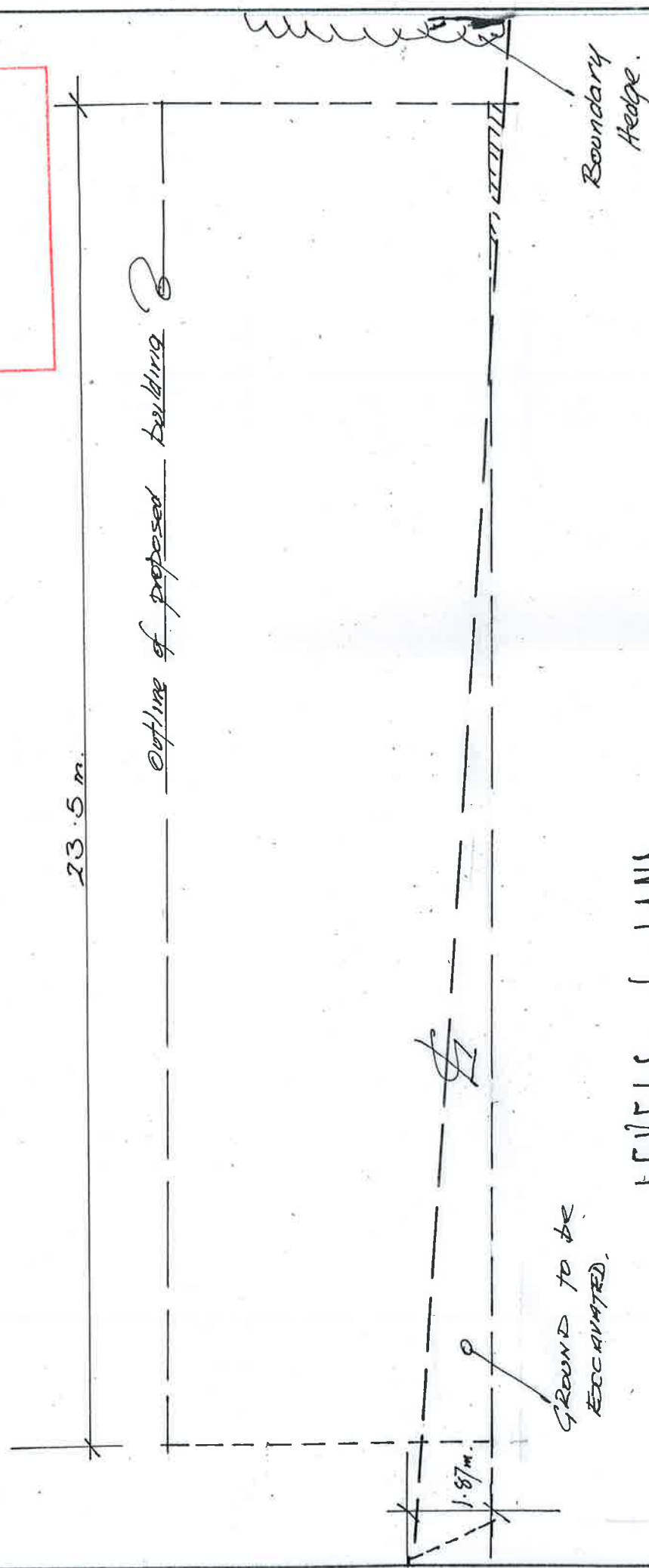

LEVELS of LAND

T.J. HILDON
 CLONDISLEY
 St MARY S
 Terry.hiron@virgin.net

SF 5