

6194

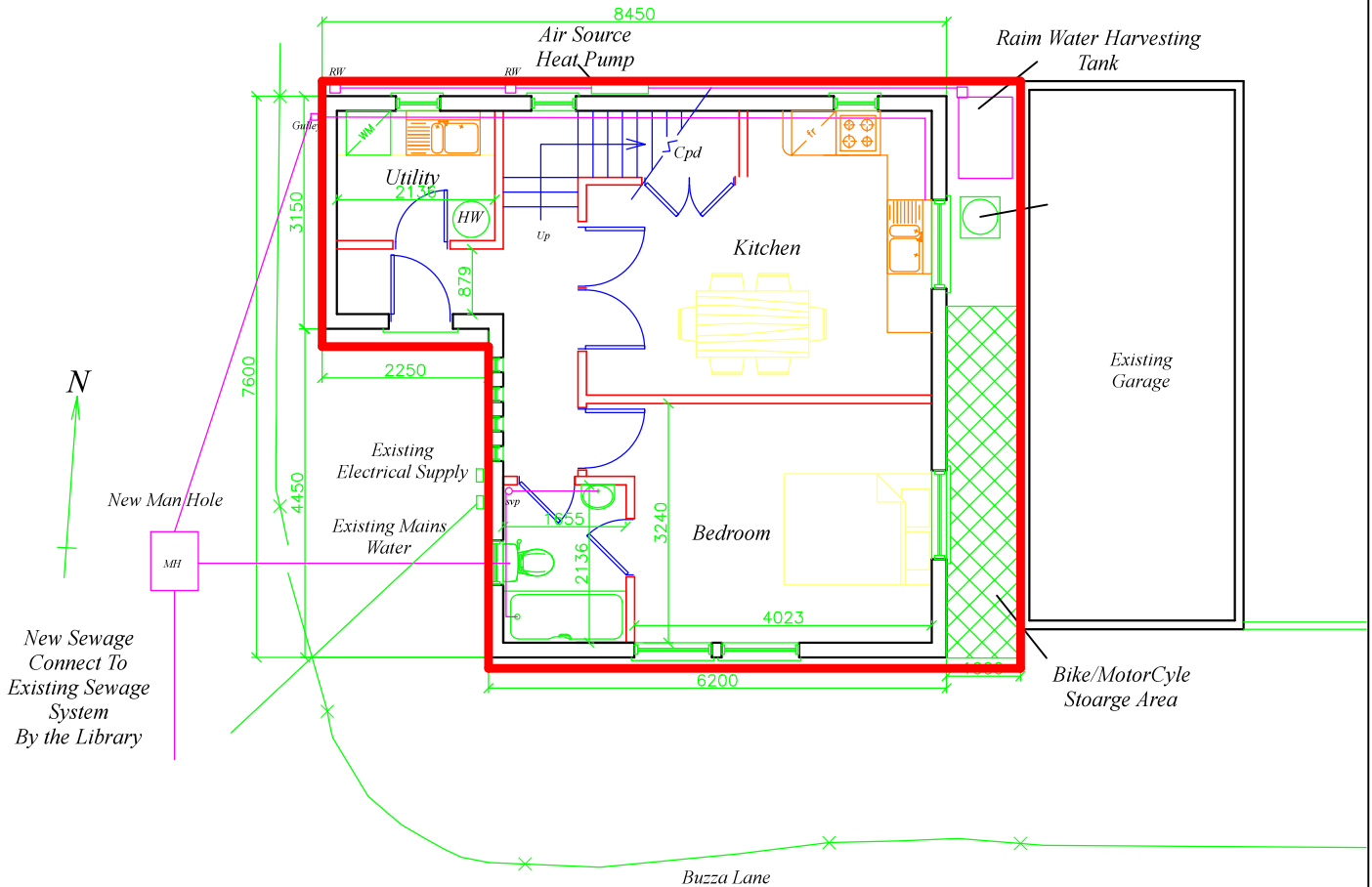

***N.B.***-No measurements to be scaled from this drawing unless specified. Whilst all efforts are made to insure accurate measurements Any discrepancies should be reported immediately to the architect.

**LAND AT  
PORTHCRESSA  
ST. MARY'S  
ISLES OF  
SCILLY**

**Boundary  
Detail**

Date - January 2017  
Amended -  
Scale - 1 : 100

PAUL OSBORNE  
CARN THOMAS  
ST. MARY'S, ISLES of SCILLY.  
TR21 0PT Tel (01720) 423066  
Email: paul@sailsilly.com

**TF-HD-B1a**