

Dimensions are not to be scaled from this drawing

Rev	Date	Description	Author
-	06 Dec 16	Draft for comment	ha
A	12 Dec 16	Revised layout to reflect comments for review.	ha
B	14 Dec 16	Issued to Planning	ha

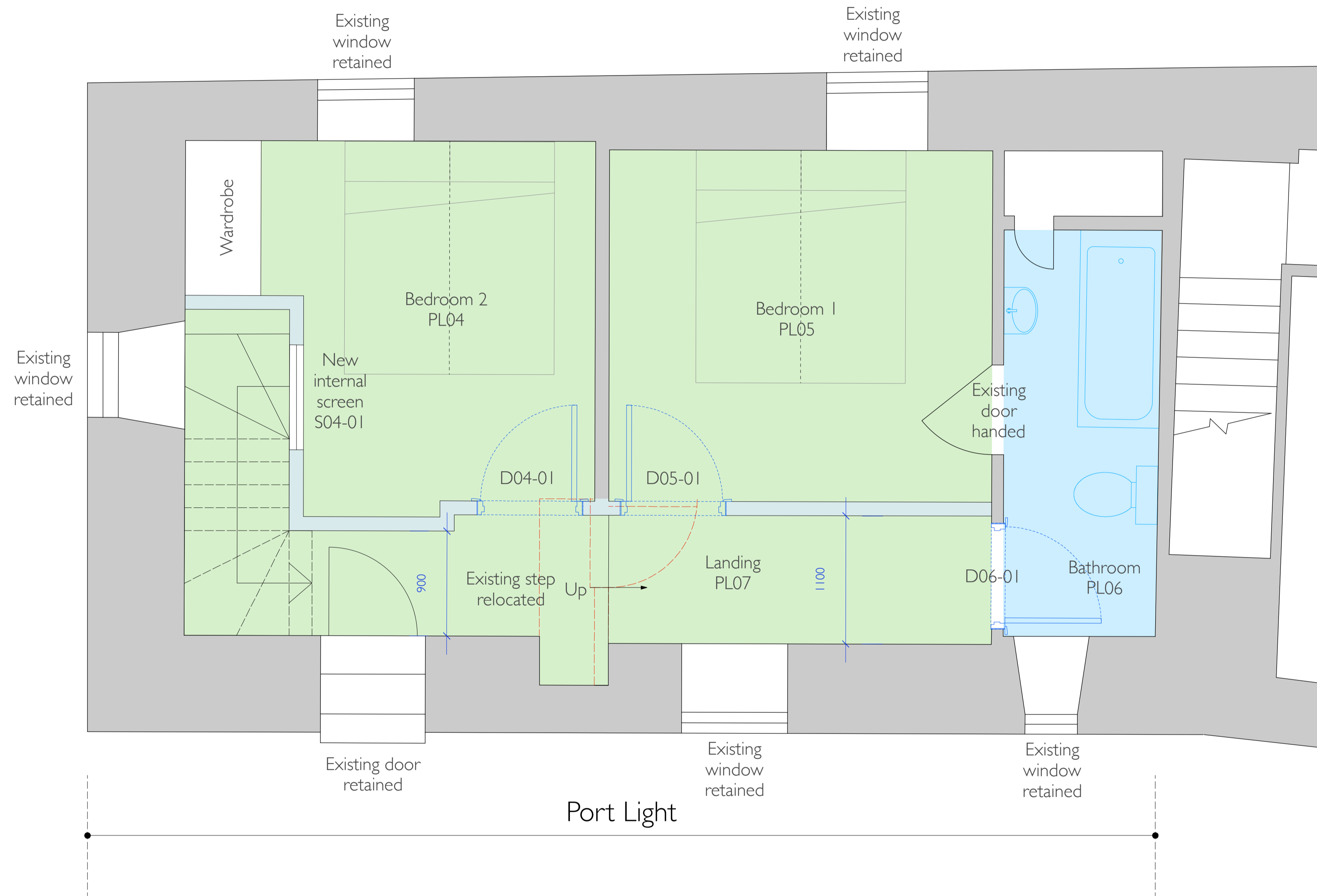

APPROVED
By Craig Dryden at 4:13 pm, Feb 07, 2017

PLANNING

Tregarthen Hotel
Isles of Scilly

Portlight
Proposed First Floor

Scale: 1:25 @ A1 (1:50 @ A3)

Drawing No: 1156/1411 Rev B

The Boat Shed, Michael Browning Way
Exeter EX2 8DD
01392 438051 mail@g-uk.com

grainge architects

