

Rev	Date	Description	Author
-	06 Dec 16	Draft for comment	ha
A	12 Dec 16	Revised layout to reflect comments for review.	ha
B	14 Dec 16	Issued to Planning.	ha

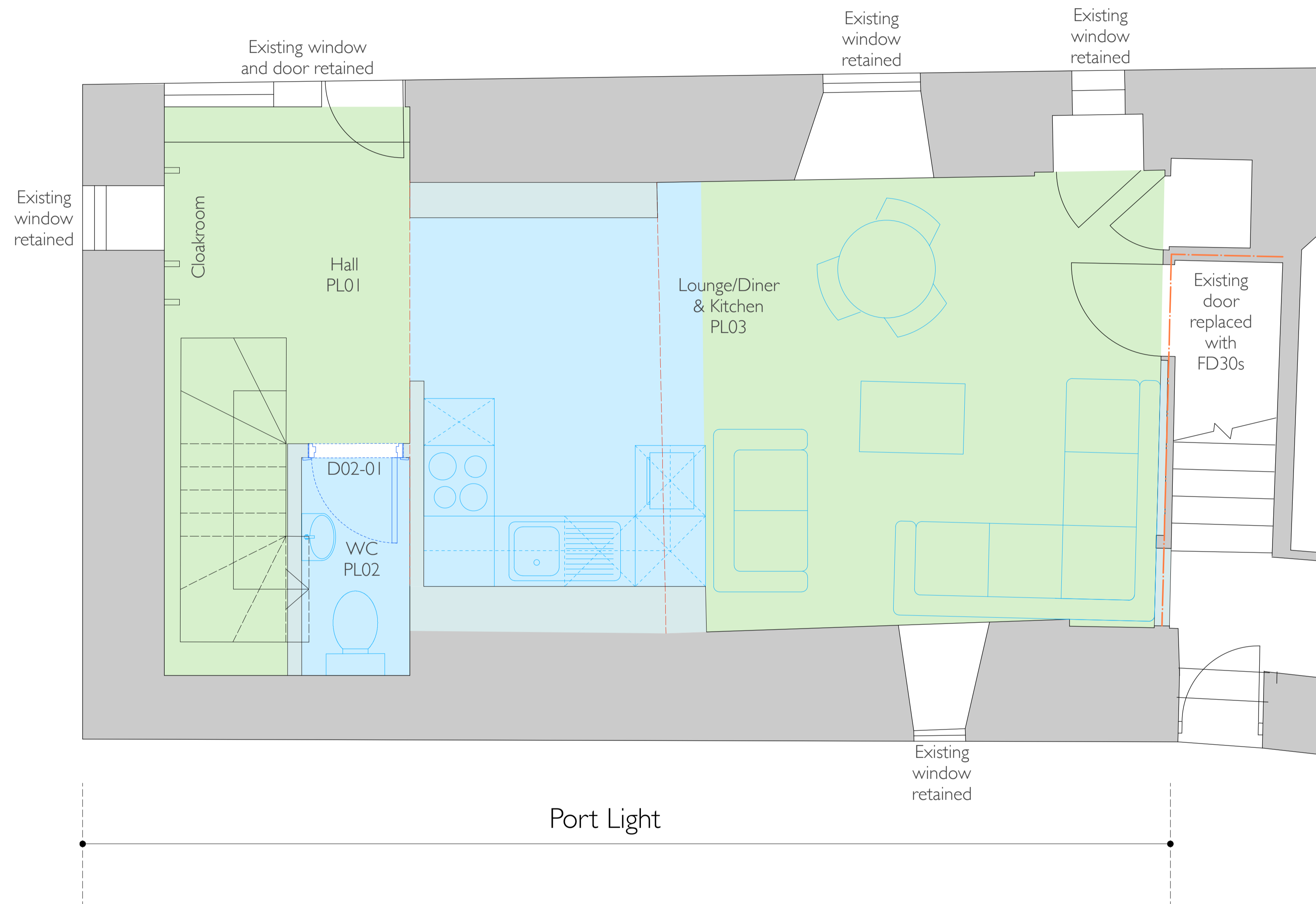

PLANNING

Tregarthen Hotel
Isles of Scilly

Portlight
Proposed Ground Floor

Scale: 1:25 @ A1 (1:50 @ A3)

Drawing No: 1156/1410 Rev B

The Boat Shed, Michael Browning Way
Exeter EX2 8DD
01392 438051 mail@g-uk.com

APPROVED
By Craig Dryden at 4:12 pm, Feb 07, 2017