

King, Andrew

From: Toby Tobin-Dougan <toby@theislandingredient.co.uk>
Sent: 18 December 2017 10:48
To: King, Andrew; dwyborn@exmoor-nationalpark.gov.uk; Dryden, Craig
Subject: Fwd: Site notice
Attachments: site notice.jpg; yurt 217.JPG; INTERIOR PLAN.jpg; yurt 214.JPG

Dear David, Andrew and Craig,

Please find here some responses to comments invited by the planning department prior to written invitation issued by the council.

With regard to comments by Anna Cawthray, here is a picture of the site notice clearly visible and been there for some time, despite the invitation on the site notice clearly states comments will be accepted for a period of 21 days BEGINNING with the date of the notice.

As you can see, to refute another comment from Ms cawthray, clearly the site has an easterly boundary, complete and unerrupted by Pittusporum hedging, in parts, shown on the photograph to be up to 6m in height. Another comment by Ms cawthray was the only existence of one water harvesting tank, almost clearly, this was shot at 745 this morning there are two 500gallon tanks connected by blue alkathene water pipes , Again the evergreen eunonomus hedging in view in this shot forms a hedge to the south of the site. The western site boundary has also pittusporum hedging, some additional hedging for this boundary I am currently growing for installation. In response to her concerns on water, with advice from a specialist from a water harvesting company, the rainfall on Scilly is in the region of 33.2 inches per year, with a roof area of approximately 194 sq feet there is a potential to harvest between 3,988 and 4010 gallons of water pa. Any bulk containers of drinking/cooking water will be adequately recycled.

The compost toilet is an odourless system which will be emptied weekly. This will be bulk composted for a period of two years, with sawdust, chippings and vegetation, when it will be broken down completely, completely odourless and used as a fantastic compost to plant more hedging and fruit trees adjacent to the site.

I no longer breed and butcher rare breed pigs, however my breeding turkeys and flock of Light Sussex laying hens, from that site, will be transferred 10m to join my other flock of 30 laying Light Sussex hens, on another adjacent paddock of my holding.

The guests to the yurt will be encouraged to collect their eggs for each day.

They will also be offered the use of an inflatable boat with buoyancy aids, two professional Kayaks, shrimp nets, and 2 adult and two childrens wetsuits, masks, fins etc.

The accusation of my guests this summer using the campsite facilities are completely false.

My friend Peter wright, his wife, father in law and children stayed with me as a tightly knit group. We devised a well planned and successful rota of bathroom use, cooking, washing up which was strictly adhered to. Peter and wife kindly supplied all toiletries for shower and bathroom use and liquids for washing up and hand washing clothing at my house.

I find the quote that I gave permission for anyone not staying on the campsite to be offensive.

I would never condone that whatsoever, nor ever would.

The fact that a group of friends and family could not find any accommodation during the last season tells me of a need for a need for an offer of added value to possible visitors to the Island as does the fact that the adjacent yurt, granted permission five years ago, is fully booked each year from early spring through to the end of October gain indicating additional offers are needed

Further that my yurt proposition is to be 79 ft in diameter is truly damaging, I resend the wheel plan which was sent to yourselves many weeks ago.

K Tobin-Dougan

Toby

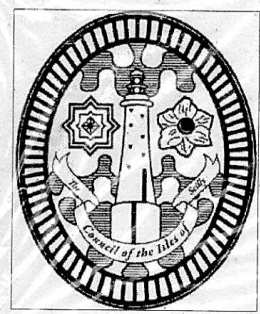

COUNCIL OF THE ISLES OF SCILLY PLANNING DEPARTMENT

Town Hall, The Parade, St Mary's TR21 0LW
Telephone: 01720 424350 Email: planning@scilly.gov.uk

Planning (Listed Buildings and Conservation Areas) Act 1990

Planning (Listed Buildings and Conservation Areas) Regulations 1990

Town and Country Planning (Development Management Procedure) Order 2015

The Council has received the following application for Planning Permission to carry out development.

PLANNING REFERENCE

P/17/091/FUL

DEVELOPMENT PROPOSED:

Material change of use for the siting of a seasonal yurt on land at Lawrence's Brow, St Martins for use as visitor accommodation and the change of use and refurbishment of an existing building for ancillary use in connection with the yurt.

LOCATION:

Land At Lawrence's Brow, Churchtown, St Martin's, Isles Of Scilly.

REASON FOR NOTICE:

Conservation Area

Should you wish to make any comments on this application, please make them in writing within a period of 21 days beginning with the date of this notice, to the Planning Department, Town Hall, The Parade, St Mary's, Isles of Scilly TR21 0LW or by email to planning@scilly.gov.uk.

Copies of the application, plans and other documents submitted with it are available for inspection at the Planning Department, Town Hall, The Parade, St Mary's, Isles of Scilly, TR21 0LW during normal office hours. Please call the department in advance to ensure an appointment is not required, alternatively, applications can be viewed online at www.scilly.gov.uk.

Council of the Isles of Scilly

Date of Notice: 20th December 2017



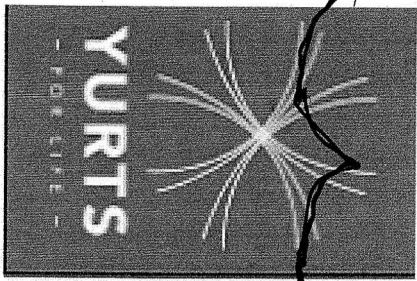

18ft Yurt Plan

40 Ribs

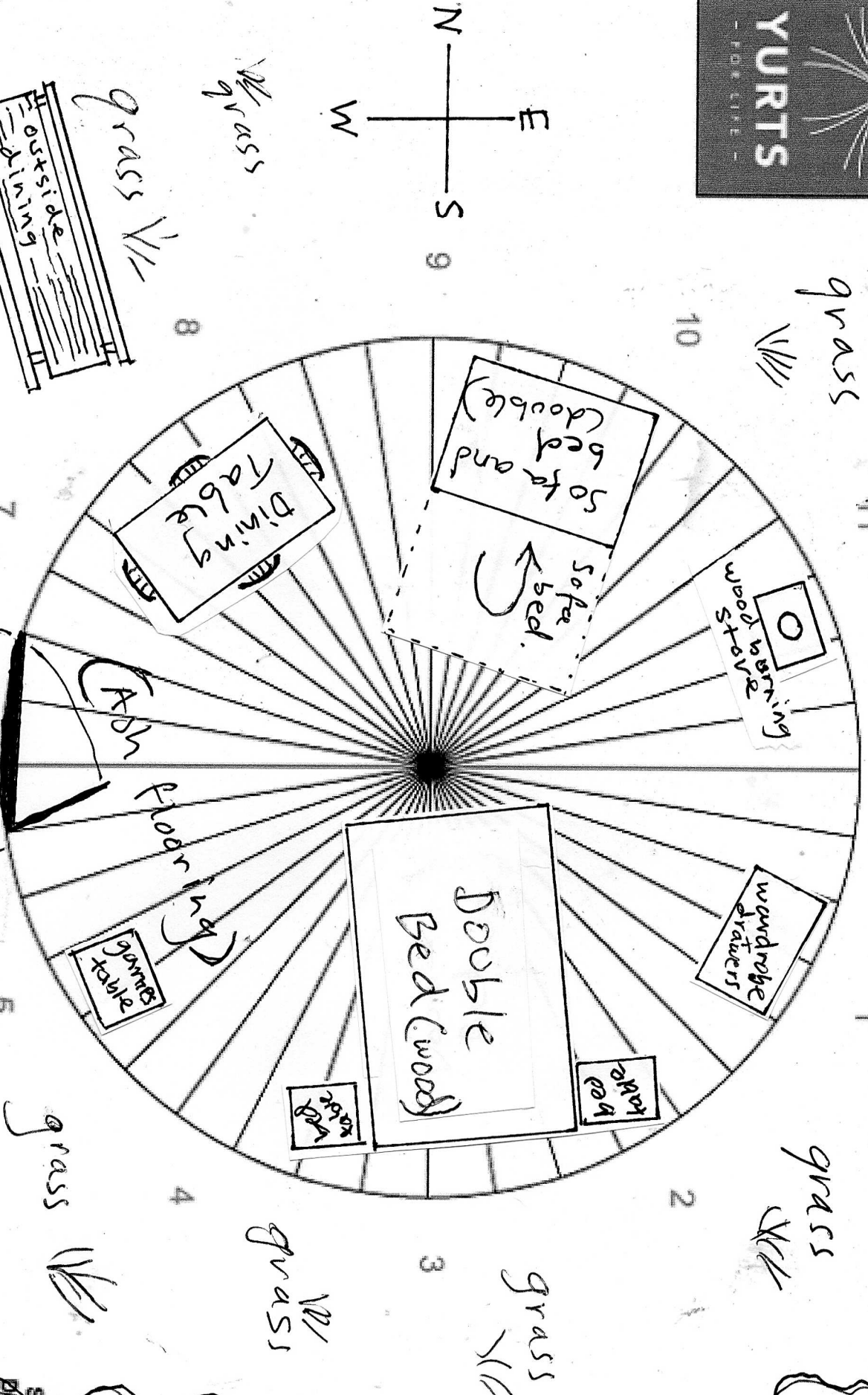

PitHosporou
hedging
(existing)

PitHosporou
hedging
(existing)

For Reference

- Single Door = 3 ribs wide
 - Double Door = 4 ribs wide
 - Single Window = 2 ribs wide
 - Double Window = 3 ribs wide
- Wood Burning Stove: Mark the location with a circle between two ribs, must be at least 3 ribs away from any door or window

existing hedging

existing hedging

existing hedging

existing hedging



**COUNCIL OF THE ISLES OF SCILLY
PLANNING DEPARTMENT**

Town Hall, The Parade, St Mary's TQ21 0JW

Telephone: 01720 424350 Email: planning@scilly.gov.uk

Planning (Listed Buildings and Conservation Areas) Regulations 1989

Town and Country Planning (Development Management Procedure) Order 2015

The Council has received the following application for Planning Permission to carry out development:

PLANNING REFERENCE: 15/1399/P/LC

APPLICANT/OWNER/PROPOSER: Material Change of Use for the siting of a residence with an outbuilding at Lawrence's Home, St Mary's, Isles of Scilly, TQ21 0JW

LOCATION: existing building on existing site in connection with the plot.

REASON FOR NOTICE: Land at Lawrence's Home, Chardishen, St Mary's, Isles of Scilly (Conservation Area)

Should you wish to raise any comments or objections, please make them to writing within a period of 21 days beginning with the date of this notice, to the Planning Department, Town Hall, The Parade, St Mary's, Isles of Scilly TQ21 0JW or by email to planning@scilly.gov.uk

Copies of the application, plans and other documents submitted with it are available for inspection at the Council Offices, Town Hall, The Parade, St Mary's, Isles of Scilly, TQ21 0JW. Any person wishing to inspect other documents should make an appointment to do so by contacting the Planning Department.

Application can be viewed online at www.scilly.gov.uk

Council of the Isles of Scilly

Issue of Notice: 28th November 2015