

SITE PLAN KEY:

- A - Entrance paving + garden
- B - Screen planting
- C - Entrance to house
- D - Renovated house
- E - Glazed link
- F - Extension
- G - Terrace
- H - Private access to Annexe
- J - Entrance to Annexe
- K - Renovated and extended Annexe
- L - Terrace
- M - Moorings
- N - Terrace
- P - Sunken courtyard
- Q - Workshop and store
- R - Access to shore
- S - Shore track

— Site Boundary

- - - Structures removed

BOUNDARY HEDGES NOTE:

No existing hedges to adjacent properties to be altered.

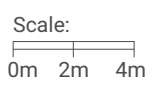
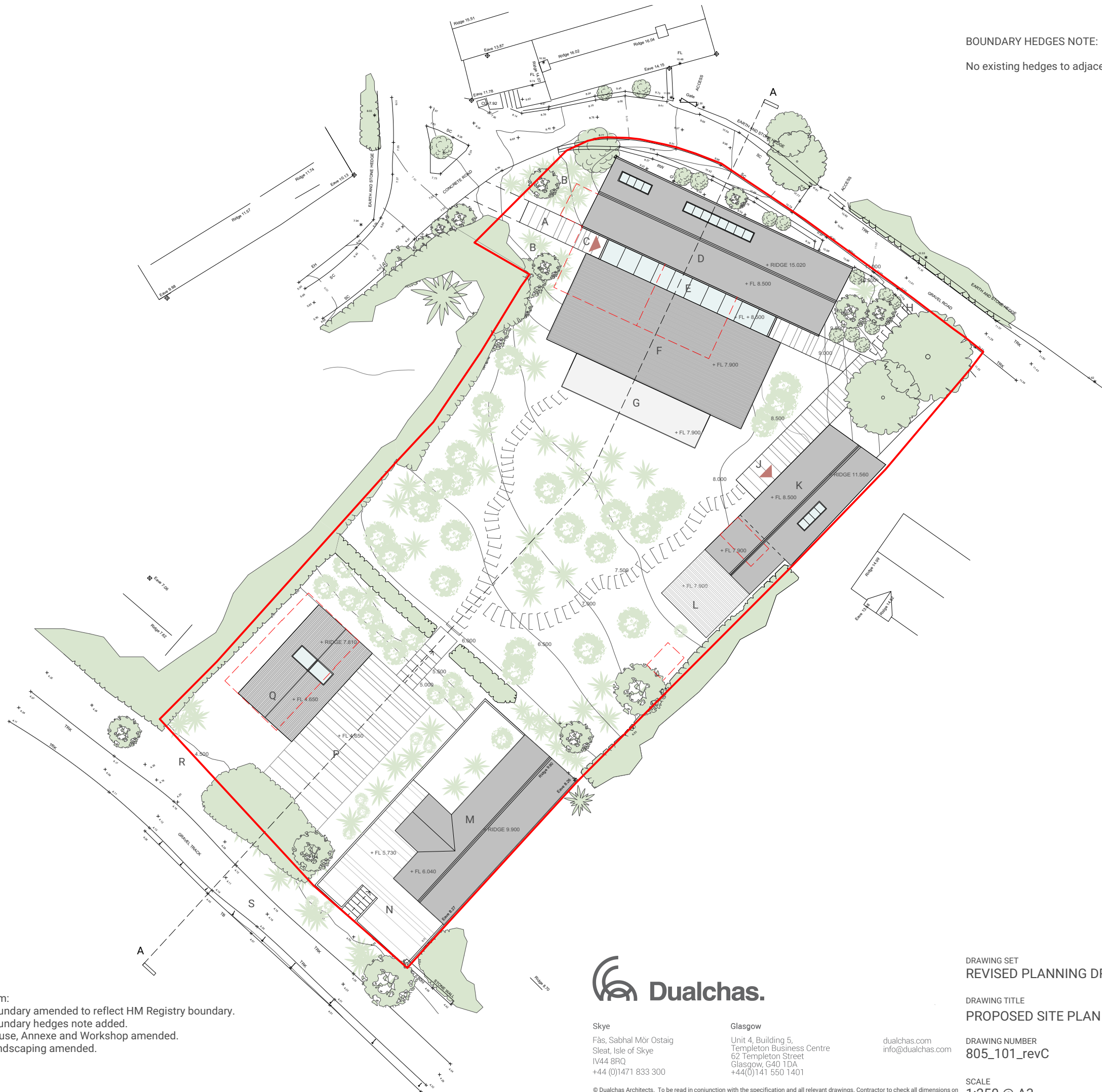

Revision:	Date:	Item:
A	06.11.18	Boundary amended to reflect HM Registry boundary. Boundary hedges note added.
B	14.05.19	House, Annexe and Workshop amended.
C	03.07.19	Landscaping amended.



Skye  
Fàs, Sabhal Mòr Ostaig  
Sleat, Isle of Skye  
IV44 8RQ  
+44 (0)1471 833 300

Glasgow  
Unit 4, Building 5,  
Templeton Business Centre  
62 Templeton Street  
Glasgow, G40 1DA  
+44(0)141 550 1401

dualchas.com  
info@dualchas.com

DRAWING SET  
REVISED PLANNING DRAFT

DRAWING TITLE  
PROPOSED SITE PLAN

DRAWING NUMBER  
805\_101\_revC

SCALE  
1:250 @ A3

CLIENT  
805\_LOWTH

DRAWN BY  
RF

DATE  
26/09/2018

© Dualchas Architects. To be read in conjunction with the specification and all relevant drawings. Contractor to check all dimensions on site. Do not scale from this drawing. Architect to be advised of any variation between the drawings and site conditions.