

GROUND FLOOR PLAN

DESIGN AND ACCESS STATEMENT

The owners of The Old Chapel wish to remove the existing conservatory structures and replace with more practical and appropriate extensions. In order to significantly reduce the amount of direct sunlight, it is felt that a traditional pitched roof would be the best approach for the upper floor extension. This will be at the same pitch but slightly lower than the main roof. Timber sash windows to match the existing are placed directly above each doorway at front and rear. Slate wall cladding to match existing to the front face and painted render to the side and rear. The roof will be a small module natural slate.

Due to the minimal floor to ceiling heights and low cills of the upper floor windows a pitched roof design has been deemed impractical for the main rear conservatory. A flat roofed, oak framed, orangery design is better suited both in practical terms and is more in keeping with the style of the house. The extension has been widened slightly to accommodate the clients preferred kitchen design, an increase of 8.8m², with the amount of glazing being reduced with a mixture of oak shingle sidings, full height solar control glazing and two roof lanterns. The flat roof covering will be a single ply membrane or fibreglass.

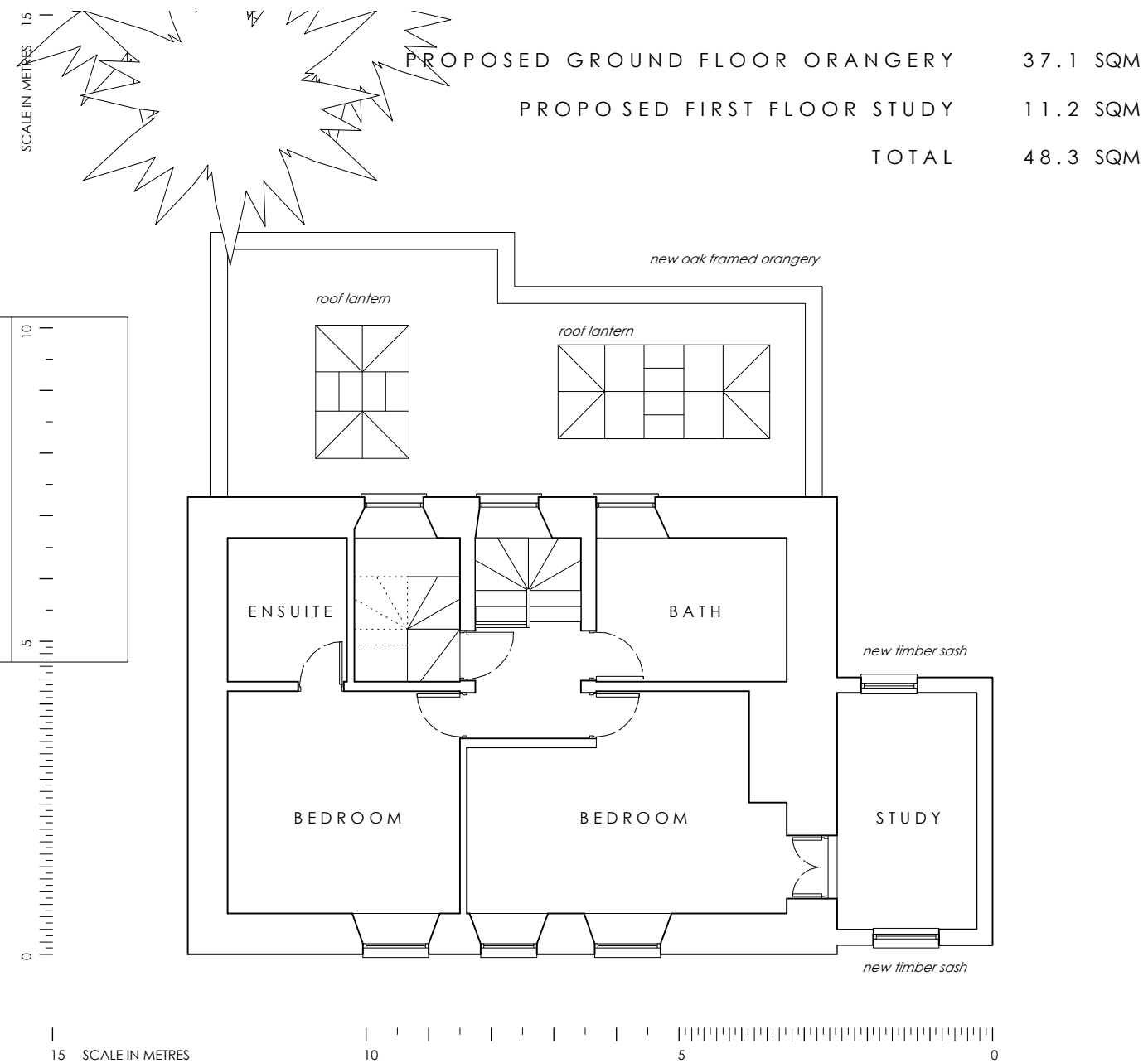

FIRST FLOOR PLAN

RECEIVED

By Emma Kingwell at 4:58 pm, Sep 14, 2020

THE OLD CHAPEL
OLD TOWN, ST MARYS

PROPOSED PLANS
GROUND + FIRST

DRAWING NO. OC05

DATE - SEP 2020

SCALE - 1:100 @ A3