

RECEIVED
By Lisa Walton at 2:29 pm, Jun 11, 2021

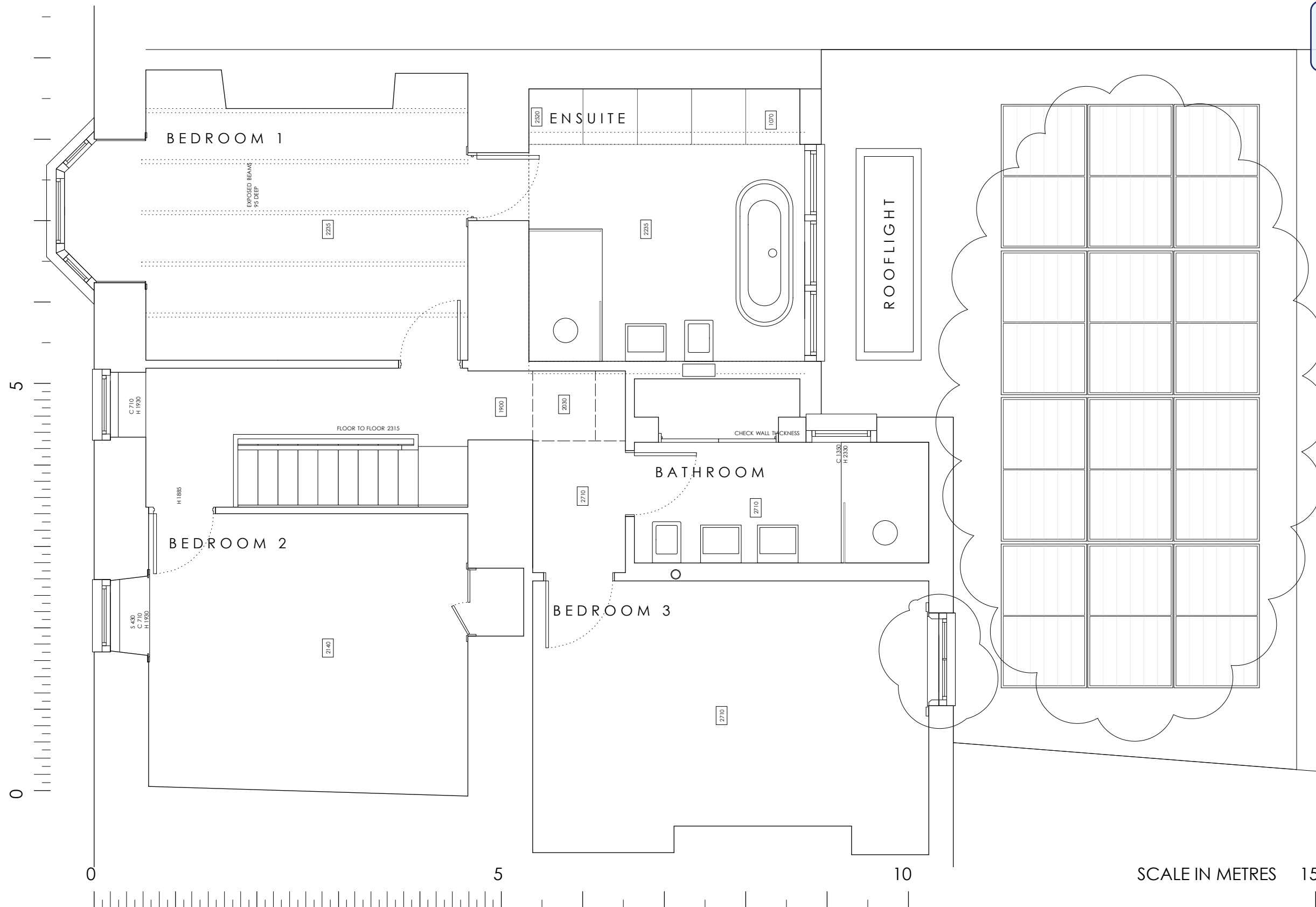

REVISED
2:29 pm, Jun 11, 2021

AREA

FIRST FLOOR-80.26SQM

REVISION A - 11.06.21 - SEDUM ROOF
REPLACED WITH PV SOLAR ARRAY.
BED 3 WINDOW CHANGED TO TIMBER SASH

RECVLVER
THE STRAND ST MARY'S

PROPOSED
FIRST FLOOR

DRAWING NO. RC09A
DATE - DEC 2020
SCALE - 1:50 @ A3

DESIGN AND ACCESS STATEMENT. PART 6

BEDROOM 1 & 2 will remain as existing. BEDROOM 3 will include a new timber framed window. What was BEDROOM 4 will become an ENSUITE to BEDROOM 1. In order to achieve a workable head height within this room a new wider dormer will be constructed. The roof of the new extension will be flat and will have 12 panel 4KW PV solar array installation