

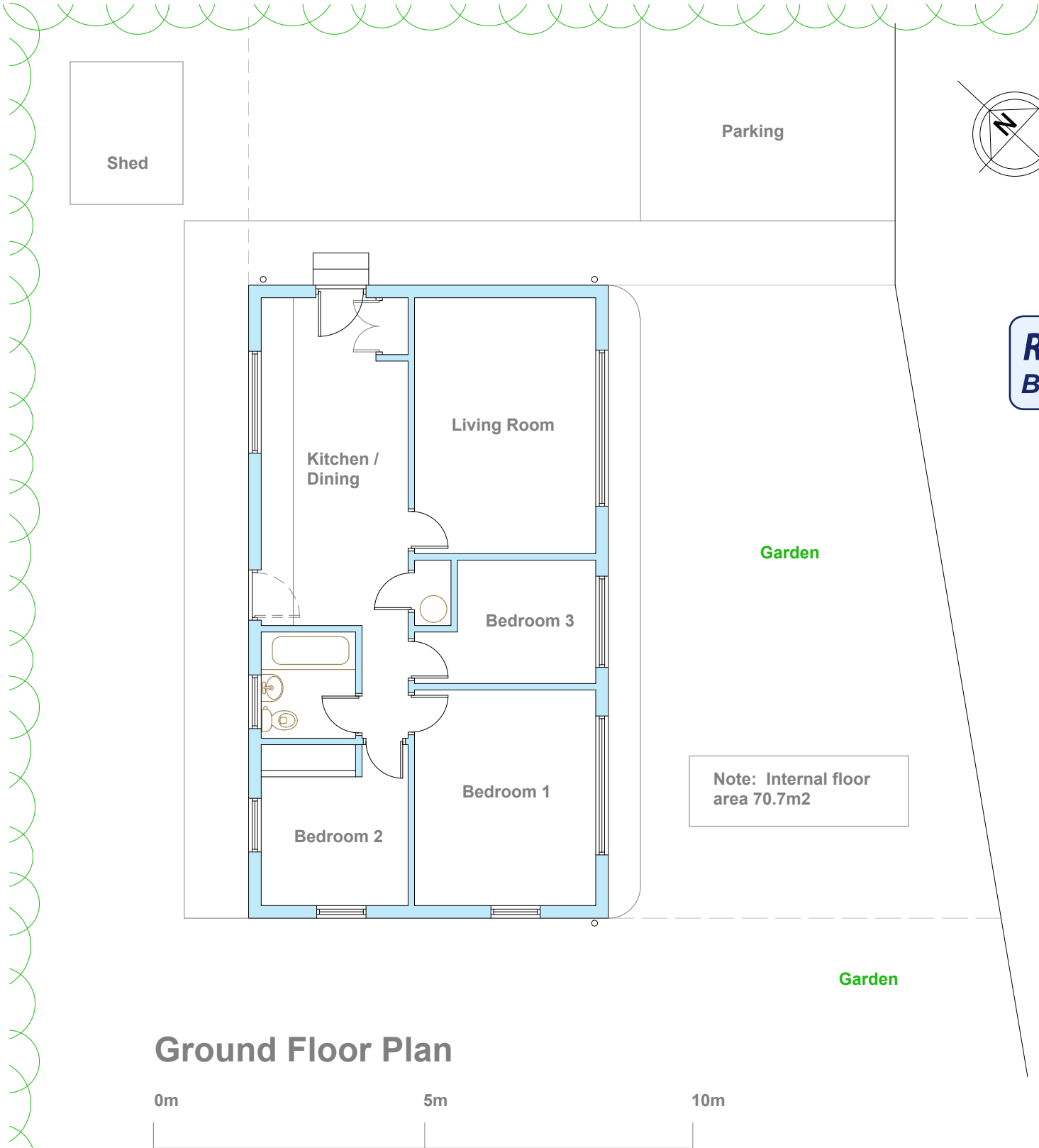

Existing Photos



Ground Floor Plan

Design Brief

- Increase accommodation for applicants and their three children
- Add a bedroom so each child has their own room
- Create a new utility room and exercise / store room
- Improve the entrance hidden around the back of the property
- Create a better relationship with the garden and improve access
- Add a toilet so five people are no longer sharing one bathroom
- Consider re-arranging rooms so principal rooms are on the front of the property with good views towards the harbour

NOTES

1 THIS DRAWING IS THE COPYRIGHT OF THE ARCHITECT AND MAY NOT BE REPRODUCED WITHOUT LICENCE

2 ALL DIMENSIONS AND LEVELS ARE TO BE CHECKED ON SITE BY THE CONTRACTOR BEFORE COMMENCEMENT OF WORK AND ANY DISCREPANCIES REPORTED TO THE ARCHITECT

3 NO RESPONSIBILITY CAN BE ACCEPTED FOR ERRORS ARISING ON SITE DUE TO UNAUTHORISED VARIATIONS FROM THE ARCHITECTS DRAWINGS.

AMENDMENTS

A Location Plan removed  
MRB 250523

RECEIVED  
By A King at 11:14 am, May 25, 2023

PLANNING

Studio St.Ives  
4 Gabriel Street, St.Ives  
TR26 2LU  
01736 798427

MIKE BRADBURY  
DESIGN

JOB

Extension and Alterations to  
Lowenva, Church Road  
St.Mary's, Isles of Scilly  
TR21 0NA  
for  
Matt and Jenny Davis

TITLE

Existing Plans

DRNG. NO. 2025-P02

REVISION A

SCALE 1:50 @ A1  
1:100 @ A3

DATE Feb 2023

OFFICE USE / PRE-ISSUE