

**RECEIVED**

By Liv Rickman at 3:27 pm, Aug 14, 2023

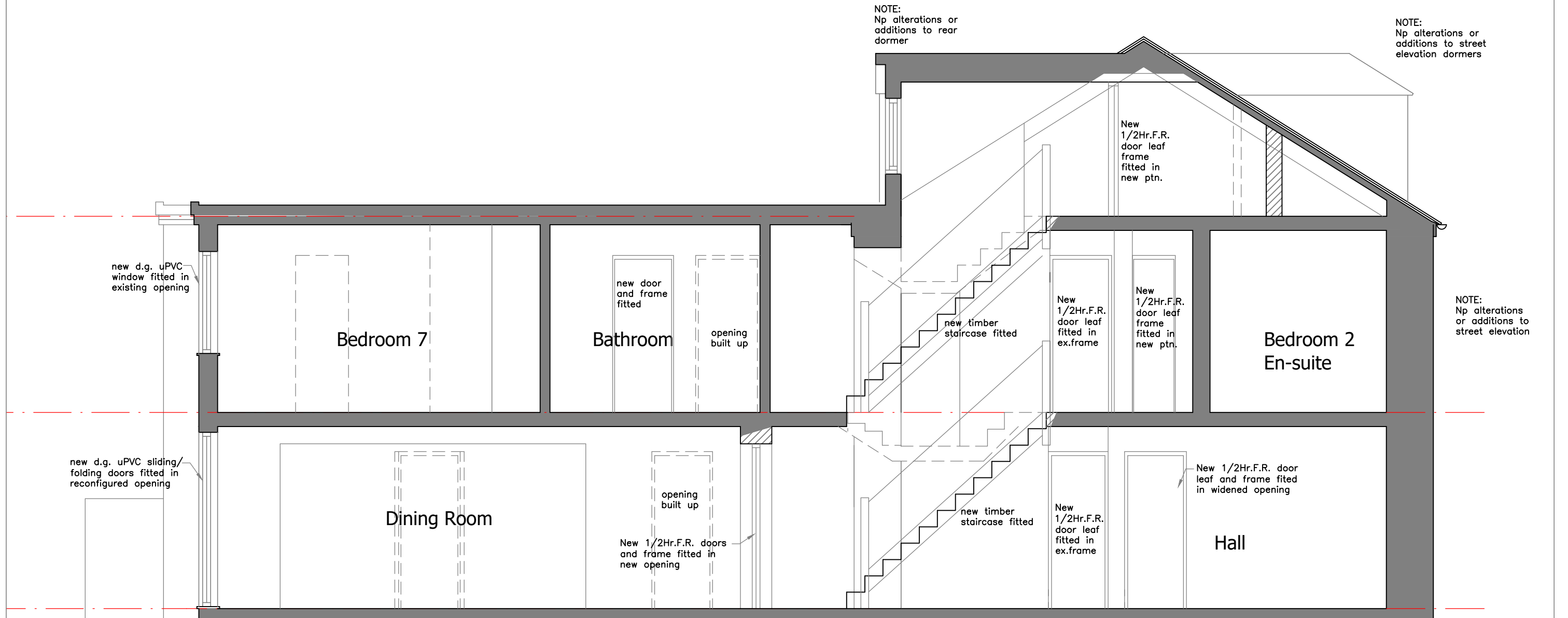

Alterations to Wingletang, St. Mary's  
for EGV Consulting Ltd  
Section thro stair as proposed

Drawing no.

20297 L 26

Scale: 1:50 @ A3

Date: 03 08 2023

**Chris Carr Architect**

Pear Tree Cottage, Duke Street, Saughton, Mold, CH7 6EJ  
01352 758 164

chrisbcarr@sky.com