

**RECEIVED**  
By Liv Rickman at 8:12 pm, Nov 12, 2023

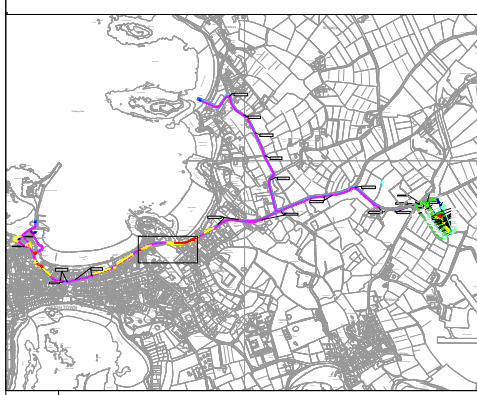
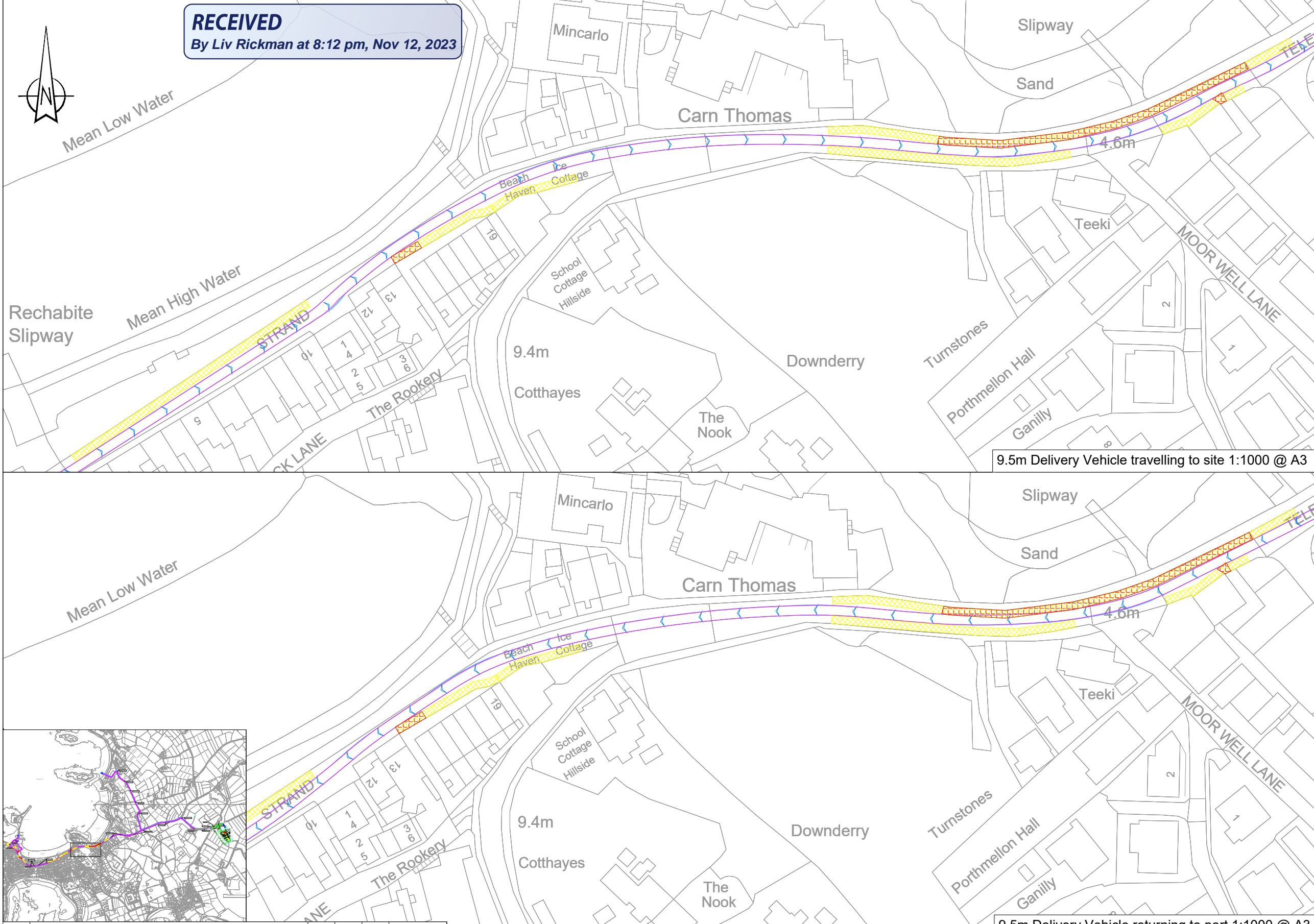

**NOTES**

1. THE VEHICLE ROUTE APPRAISAL CONSIDERED WITHIN THIS DRAWING IS BASED ON A DESKTOP APPRAISAL ONLY INCLUDING REVIEW OF GOOGLE SATELLITE IMAGERY DATED 07.10.2022 AND REVIEWED IN OCTOBER 2023. THIS PROVIDES AN APPRAISAL OF A SINGLE POINT IN TIME THEREFORE THE LOCATIONS PERMITTING VEHICLE PARKING, VEHICLE LOADING AND THE LOCATION OF POTENTIAL OBSTRUCTIONS TO CONSTRUCTION TRAFFIC (STREET FURNITURE FOR EXAMPLE) MAY EXTEND BEYOND THOSE IDENTIFIED IN THIS DRAWING.
2. PRIOR TO THE TRANSPORTING OF MATERIALS ASSOCIATED WITH THE CONSTRUCTION OF THE COMPOUND AND FUTURE WASTEWATER CAPITAL IMPROVEMENT PROJECTS FOR THE ISLES OF SCILLY A FULL REVIEW OF THE HAULAGE ROUTE WILL NEED TO BE COMPLETED ON THE GROUND. THE CONTRACTOR RESPONSIBLE FOR THE MOVEMENT OF VEHICLES AND MATERIALS WILL NEED TO BE SATISFIED THAT THE ROUTE IS ADEQUATE TO ACCOMMODATE THE RELEVANT VEHICLE AND THAT WHERE INTERVENTIONS / MANAGEMENT ARE REQUIRED THAT THIS IS AGREED WITH THE ISLES OF SCILLY COUNCIL PRIOR TO THE MOVEMENT OF CONSTRUCTION VEHICLES OR ANY CONSTRUCTION WORK COMMENCING.

9.5m Delivery Vehicle travelling to site 1:1000 @ A3

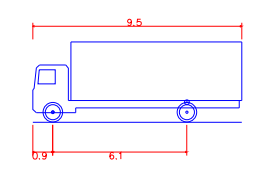

9.5m x 2.5m Rigid Delivery Vehicle  
 Overall Length 9.500m  
 Overall Width 2.500m  
 Overall Body Height 3.645m  
 Min Body Ground Clearance 0.440m  
 Track Width 2.470m  
 Lock to lock time 3.00s  
 Kerb to Kerb Turning Radius 11.000m

9.5m Delivery Vehicle returning to port 1:1000 @ A3

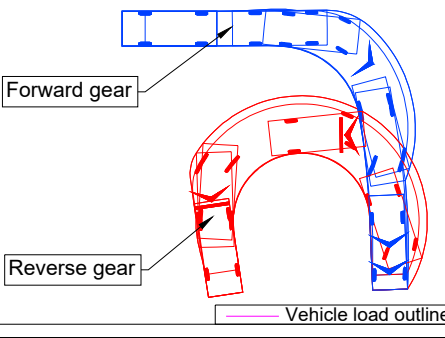

**KEY**

On street parking where satellite imagery indicates this does not obstruct the routing of a compound delivery vehicle. However, it may limit operation to one-way working.

On street parking where satellite imagery indicates that routing of a compound delivery vehicle would be obstructed.

P01 | Draft | GR | PW | LC | OCT 2023

Project <b>Isles of Scilly Plants &amp; WTW</b>	Drawn	GR	OCT 2023	Scale As Shown
	Designed	-	-	
	Checked	PW	OCT 2023	
	Approved	LC	OCT 2023	
	File No. 107780-PEF-XX-500-D.DR-H-0005.dwg			
Drawing Title <b>Swept Path Analysis - 9.5m Rigid Delivery Vehicle Carn Thomas</b>	Drawing Status Working Draft			
	Drawing No. <b>107780-PEF-XX-500-D.DR-H-0005</b>		Revision <b>P01</b>	

**Pell Frischmann**  
 BURRATOR HOUSE, PENINSULA PARK, EXETER, EX2 7NT  
 Telephone +44 (0)1392 444 345  
 Email: pfEXETER@pellfrischmann.com  
 www.pellfrischmann.com

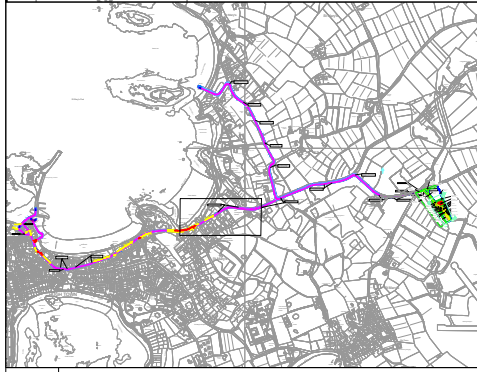
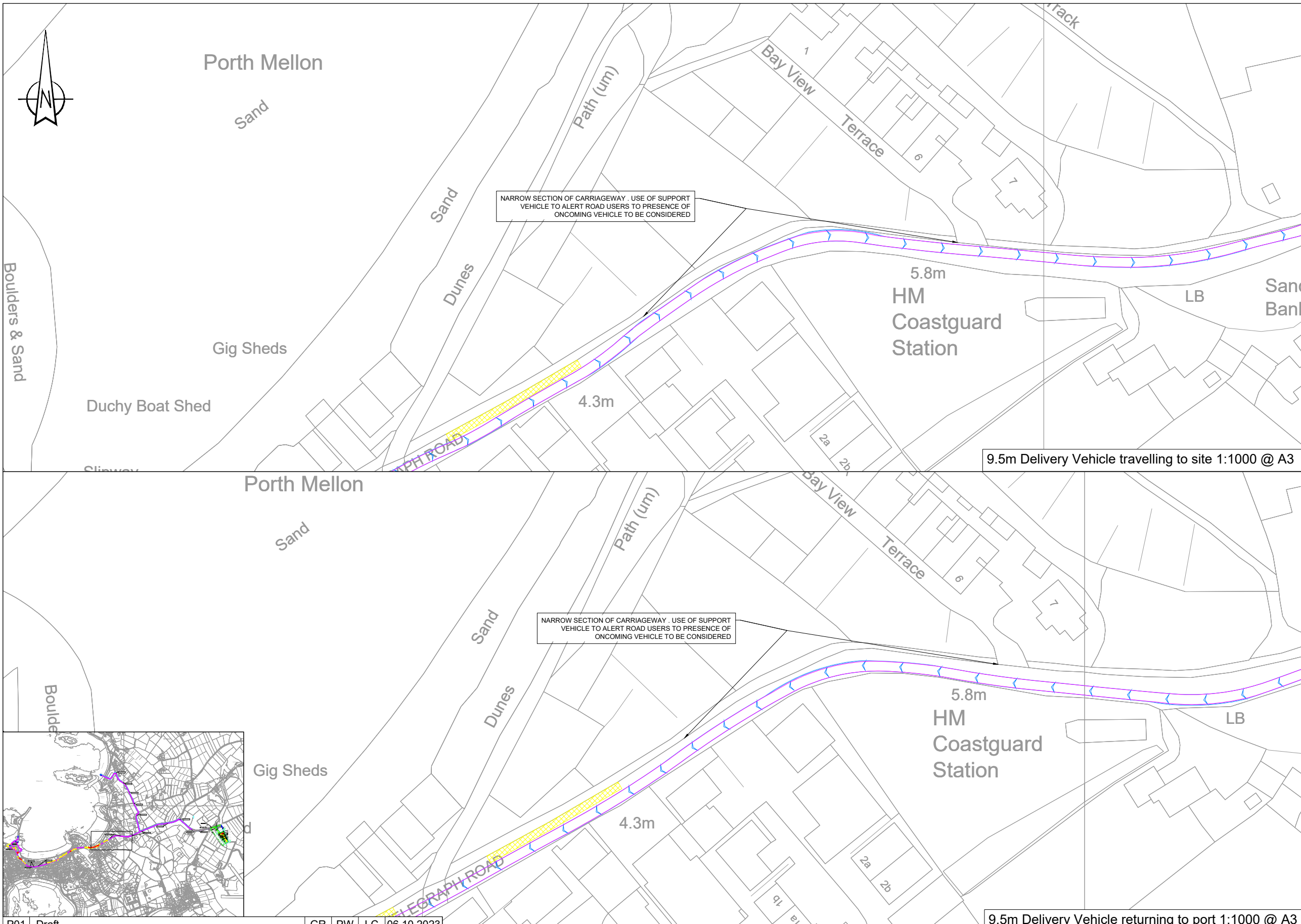

- NOTES**
1. THE VEHICLE ROUTE APPRAISAL CONSIDERED WITHIN THIS DRAWING IS BASED ON A DESKTOP APPRAISAL ONLY INCLUDING REVIEW OF GOOGLE SATELLITE IMAGERY DATED 07.10.2022 AND REVIEWED IN OCTOBER 2023. THIS PROVIDES AN APPRAISAL OF A SINGLE POINT IN TIME THEREFORE THE LOCATIONS PERMITTING VEHICLE PARKING, VEHICLE LOADING AND THE LOCATION OF POTENTIAL OBSTRUCTIONS TO CONSTRUCTION TRAFFIC (STREET FURNITURE FOR EXAMPLE) MAY EXTEND BEYOND THOSE IDENTIFIED IN THIS DRAWING.
  2. PRIOR TO THE TRANSPORTING OF MATERIALS ASSOCIATED WITH THE CONSTRUCTION OF THE COMPOUND AND FUTURE WASTEWATER CAPITAL IMPROVEMENT PROJECTS FOR THE ISLES OF SCILLY A FULL REVIEW OF THE HAULAGE ROUTE WILL NEED TO BE COMPLETED ON THE GROUND. THE CONTRACTORS RESPONSIBLE FOR THE MOVEMENT OF VEHICLES AND MATERIALS WILL NEED TO BE SATISFIED THAT THE ROUTE IS ADEQUATE TO ACCOMMODATE THE RELEVANT VEHICLE AND THAT WHERE INTERVENTIONS / MANAGEMENT ARE REQUIRED THAT THIS IS AGREED WITH THE ISLES OF SCILLY COUNCIL PRIOR TO THE MOVEMENT OF CONSTRUCTION VEHICLES OR ANY CONSTRUCTION WORK COMMENCING.

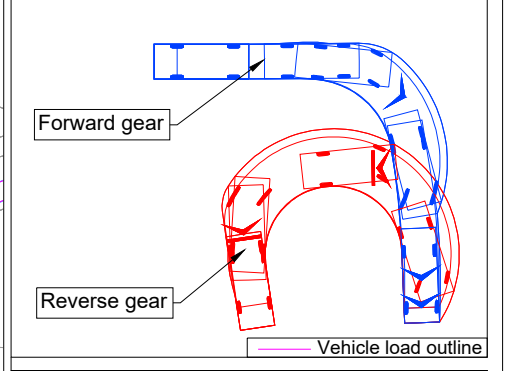
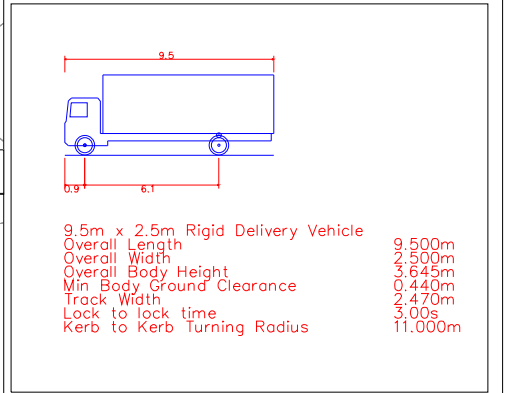

**KEY**

	On street parking where satellite imagery indicates this does not obstruct the routing of a compound delivery vehicle. However, it may limit operation to one-way working.
	On street parking where satellite imagery indicates that routing of a compound delivery vehicle would be obstructed.

P01 Draft GR PW LC 06.10.2023

9.5m Delivery Vehicle returning to port 1:1000 @ A3

**Pell Frischmann**  
 BURRATOR HOUSE, PENINSULA PARK, EXETER, EX2 7NT  
 Telephone +44 (0)1392 444 345  
 Email: pfEXETER@pellfrischmann.com  
 www.pellfrischmann.com

Project	Isles of Scilly Plants & WTW		
Drawing Title	Swept Path Analysis - 9.5m Rigid Delivery Vehicle Carn Thomas / Telegraph Road		

Name	GR	Date	OCT 2023	Scale	As Shown
Designed	-	-	-	File No.	107780-PEF-XX-500-D.DR-H-0006.dwg
Checked	PW	OCT 2023		Drawing Status	Working Draft
Approved	LC	OCT 2023		Drawing No.	107780-PEF-XX-500-D.DR-H-0006
				Revision	P01

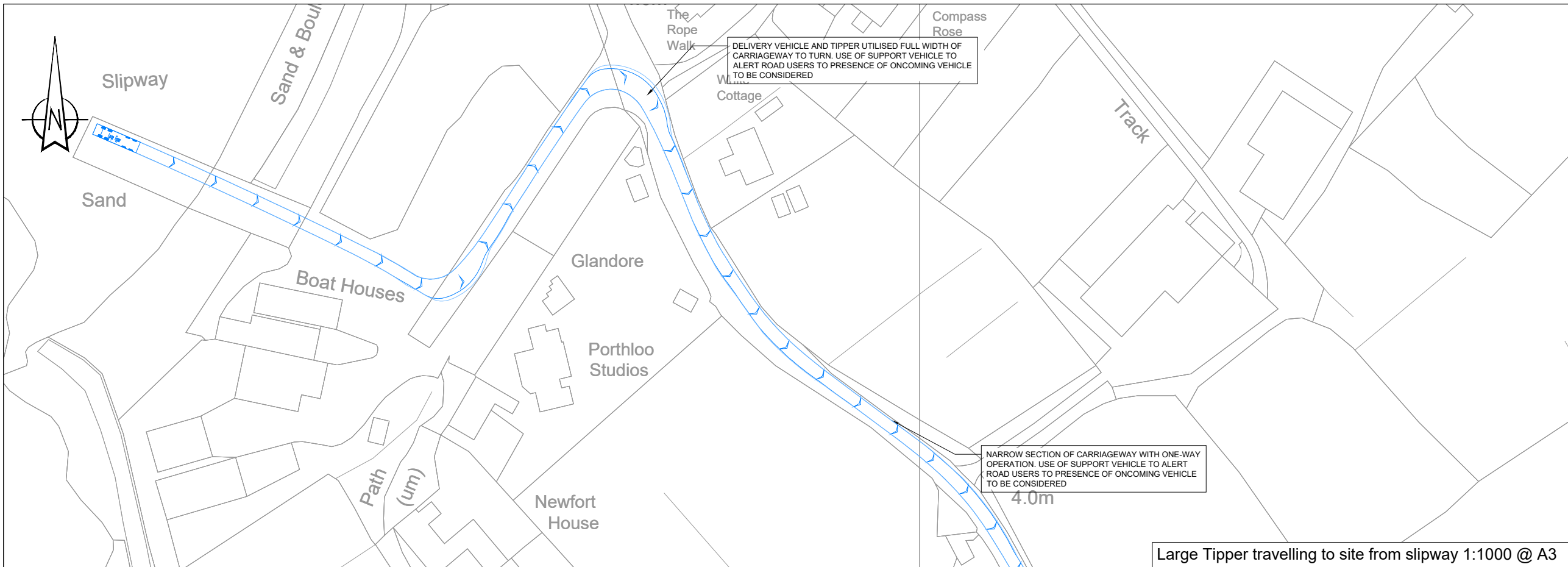

Large Tipper travelling to site from slipway 1:1000 @ A3

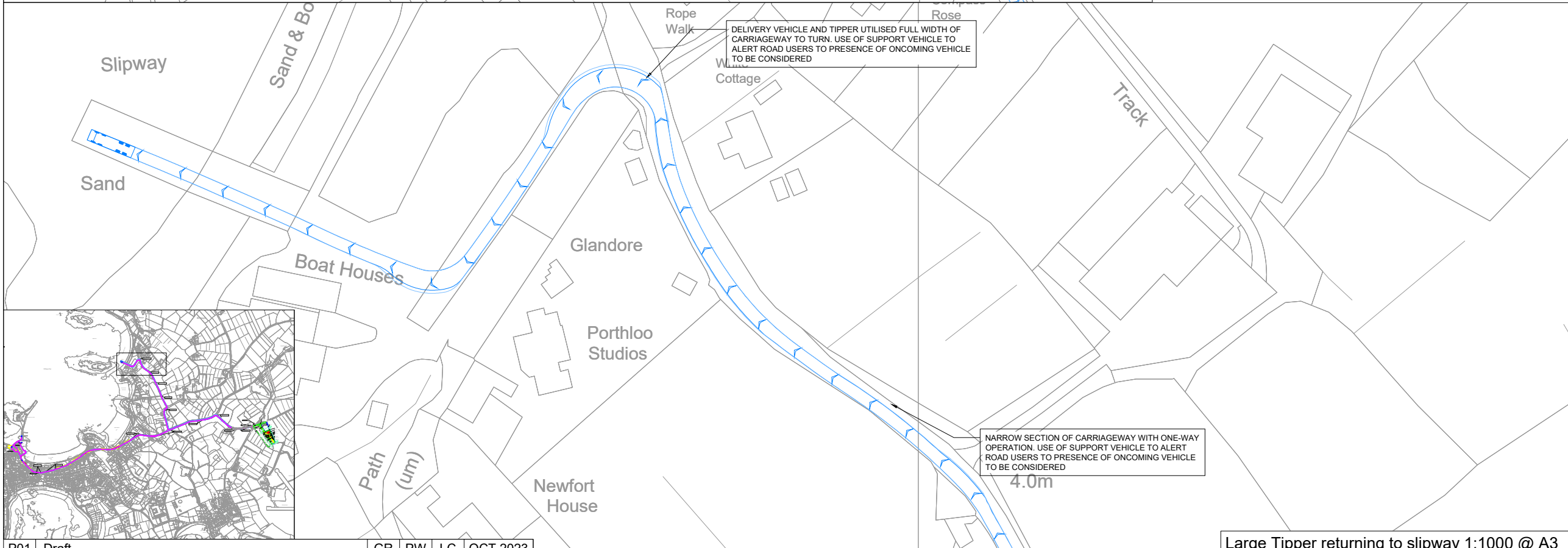

Large Tipper returning to slipway 1:1000 @ A3

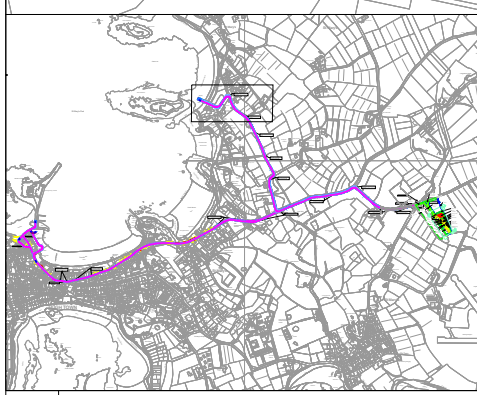

P01 Draft GR PW LC OCT 2023

- NOTES**
1. THE VEHICLE ROUTE APPRAISAL CONSIDERED WITHIN THIS DRAWING IS BASED ON A DESKTOP APPRAISAL ONLY INCLUDING REVIEW OF GOOGLE SATELLITE IMAGERY DATED 07.10.2022 AND REVIEWED IN OCTOBER 2023. THIS PROVIDES AN APPRAISAL OF A SINGLE POINT IN TIME THEREFORE THE LOCATIONS PERMITTING VEHICLE PARKING, VEHICLE LOADING AND THE LOCATION OF POTENTIAL OBSTRUCTIONS TO CONSTRUCTION TRAFFIC (STREET FURNITURE FOR EXAMPLE) MAY EXTEND BEYOND THOSE IDENTIFIED IN THIS DRAWING.
  2. PRIOR TO THE TRANSPORTING OF MATERIALS ASSOCIATED WITH THE CONSTRUCTION OF THE COMPOUND AND FUTURE WASTEWATER CAPITAL IMPROVEMENT PROJECTS FOR THE ISLES OF SCILLY A FULL REVIEW OF THE HAULAGE ROUTE WILL NEED TO BE COMPLETED ON THE GROUND. THE CONTRACTOR RESPONSIBLE FOR THE MOVEMENT OF VEHICLES AND MATERIALS WILL NEED TO BE SATISFIED THAT THE ROUTE IS ADEQUATE TO ACCOMMODATE THE RELEVANT VEHICLE AND THAT WHERE INTERVENTIONS / MANAGEMENT ARE REQUIRED THAT THIS IS AGREED WITH THE ISLES OF SCILLY COUNCIL PRIOR TO THE MOVEMENT OF CONSTRUCTION VEHICLES OR ANY CONSTRUCTION WORK COMMENCING.

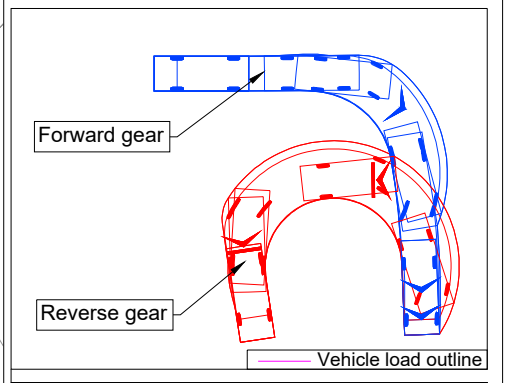
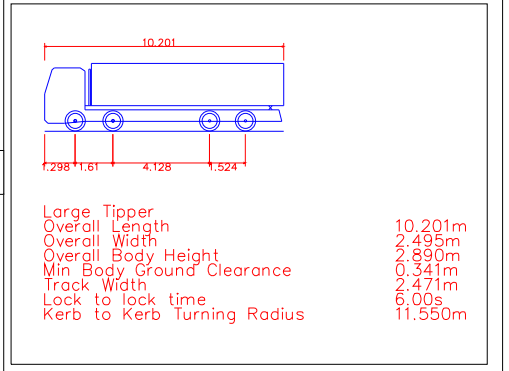

**KEY**

On street parking where satellite imagery indicates this does not obstruct the routing of a compound delivery vehicle. However, it may limit operation to one-way working.

On street parking where satellite imagery indicates that routing of a compound delivery vehicle would be obstructed.

**Pell Frischmann**  
 BURRATOR HOUSE, PENINSULA PARK, EXETER, EX2 7NT  
 Telephone +44 (0)1392 444 345  
 Email: pfEXETER@pellfrischmann.com  
 www.pellfrischmann.com

Project	Isles of Scilly Plants & WTW		
Drawing Title	Swept Path Analysis - Large Tipper Porth Loo Lane / Port		

Drawn	GR	OCT 2023	Scale	As Shown
Designed	-	-	File No.	107780-PEF-XX-500-D.DR-H-0011.dwg
Checked	PW	OCT 2023	Drawing Status	Working Draft
Approved	LC	OCT 2023	Drawing No.	107780-PEF-XX-500-D.DR-H-0011
			Revision	P01

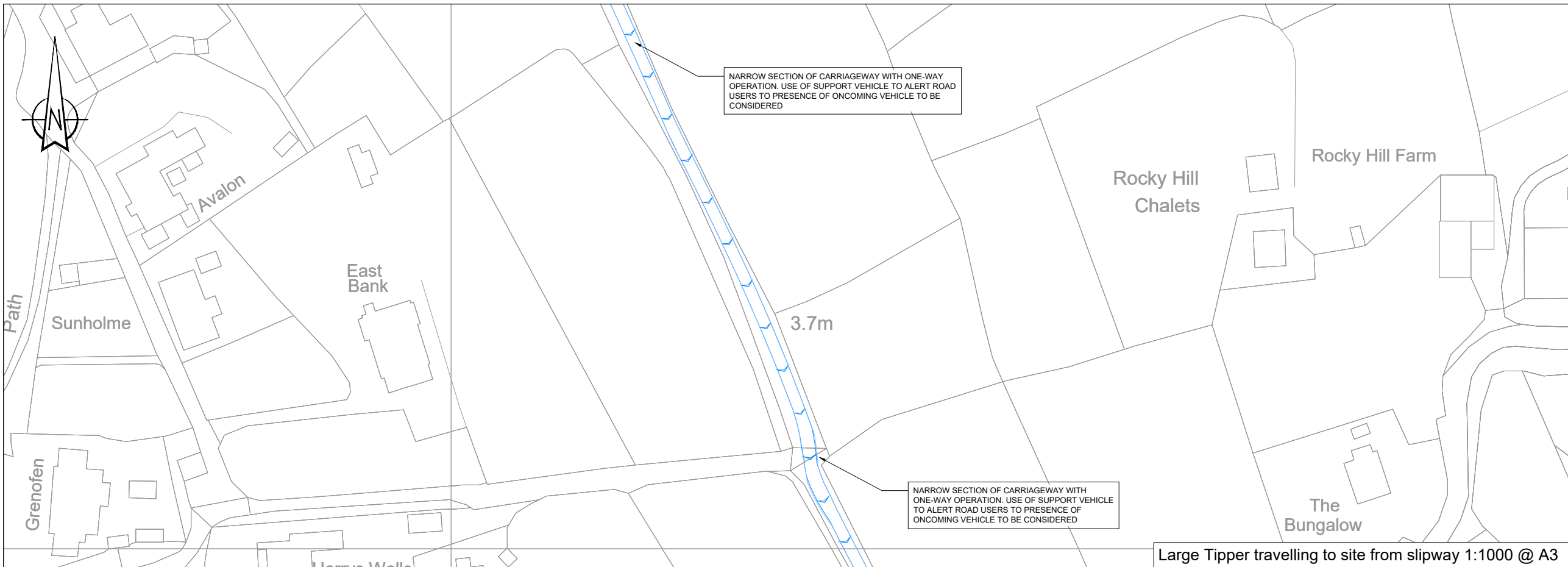

- NOTES**
1. THE VEHICLE ROUTE APPRAISAL CONSIDERED WITHIN THIS DRAWING IS BASED ON A DESKTOP APPRAISAL ONLY INCLUDING REVIEW OF GOOGLE SATELLITE IMAGERY DATED 07.10.2022 AND REVIEWED IN OCTOBER 2023. THIS PROVIDES AN APPRAISAL OF A SINGLE POINT IN TIME THEREFORE THE LOCATIONS PERMITTING VEHICLE PARKING, VEHICLE LOADING AND THE LOCATION OF POTENTIAL OBSTRUCTIONS TO CONSTRUCTION TRAFFIC (STREET FURNITURE FOR EXAMPLE) MAY EXTEND BEYOND THOSE IDENTIFIED IN THIS DRAWING.
  2. PRIOR TO THE TRANSPORTING OF MATERIALS ASSOCIATED WITH THE CONSTRUCTION OF THE COMPOUND AND FUTURE WASTEWATER CAPITAL IMPROVEMENT PROJECTS FOR THE ISLES OF SCILLY A FULL REVIEW OF THE HAULAGE ROUTE WILL NEED TO BE COMPLETED ON THE GROUND. THE CONTRACTOR RESPONSIBLE FOR THE MOVEMENT OF VEHICLES AND MATERIALS WILL NEED TO BE SATISFIED THAT THE ROUTE IS ADEQUATE TO ACCOMMODATE THE RELEVANT VEHICLE AND THAT WHERE INTERVENTIONS / MANAGEMENT ARE REQUIRED THAT THIS IS AGREED WITH THE ISLES OF SCILLY COUNCIL PRIOR TO THE MOVEMENT OF CONSTRUCTION VEHICLES OR ANY CONSTRUCTION WORK COMMENCING.

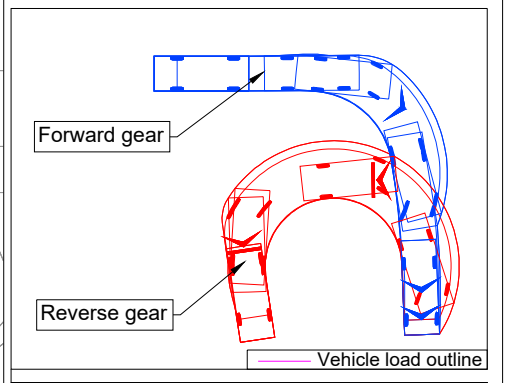
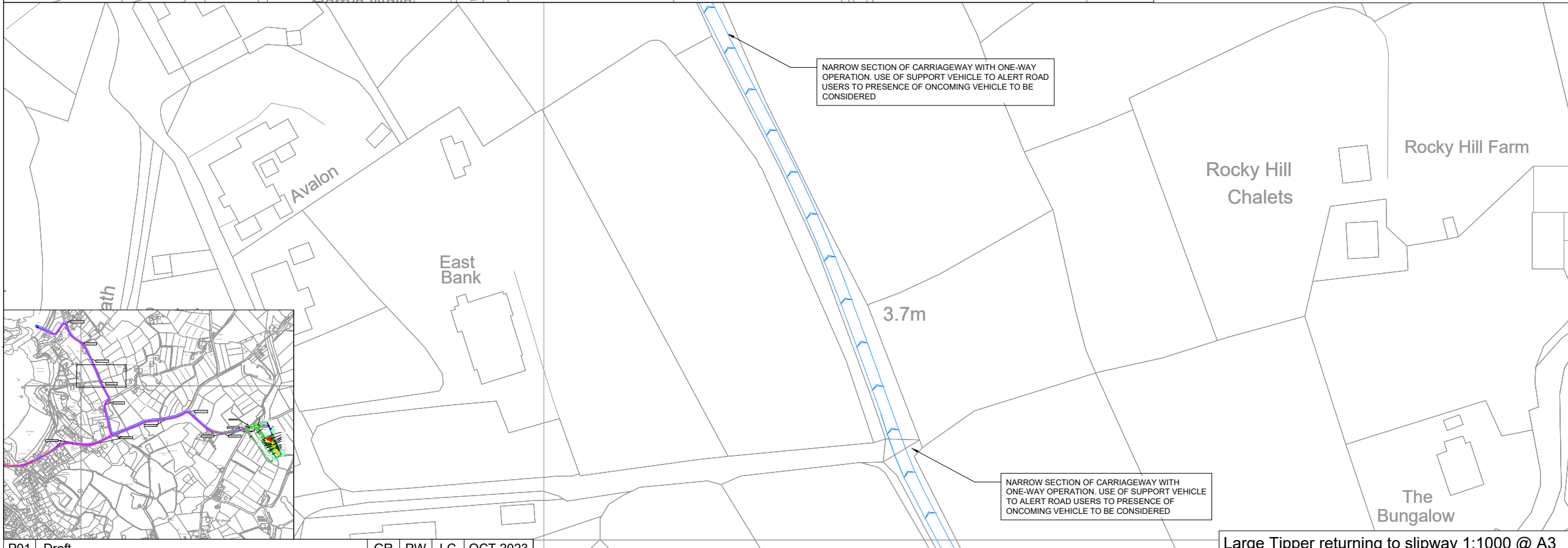
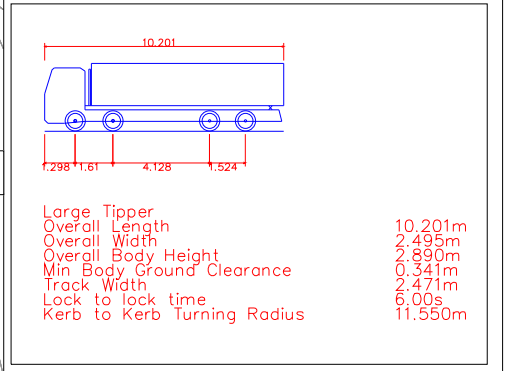

**KEY**

- On street parking where satellite imagery indicates this does not obstruct the routing of a compound delivery vehicle. However, it may limit operation to one-way working.
- On street parking where satellite imagery indicates that routing of a compound delivery vehicle would be obstructed.

P01 Draft GR PW LC OCT 2023

Project	Isles of Scilly Plants & WTW	
Drawing Title	Swept Path Analysis - Large Tipper Porth Loo Lane (South)	

Scale	As Shown	
File No.	107780-PEF-XX-500-D.DR-H-0010.dwg	
Drawing Status	Working Draft	
Drawing No.	107780-PEF-XX-500-D.DR-H-0010	Revision
		P01

**Pell Frischmann**  
 BURRATOR HOUSE, PENINSULA PARK, EXETER, EX2 7NT  
 Telephone +44 (0)1392 444 345  
 Email: pfEXETER@pellfrischmann.com  
 www.pellfrischmann.com

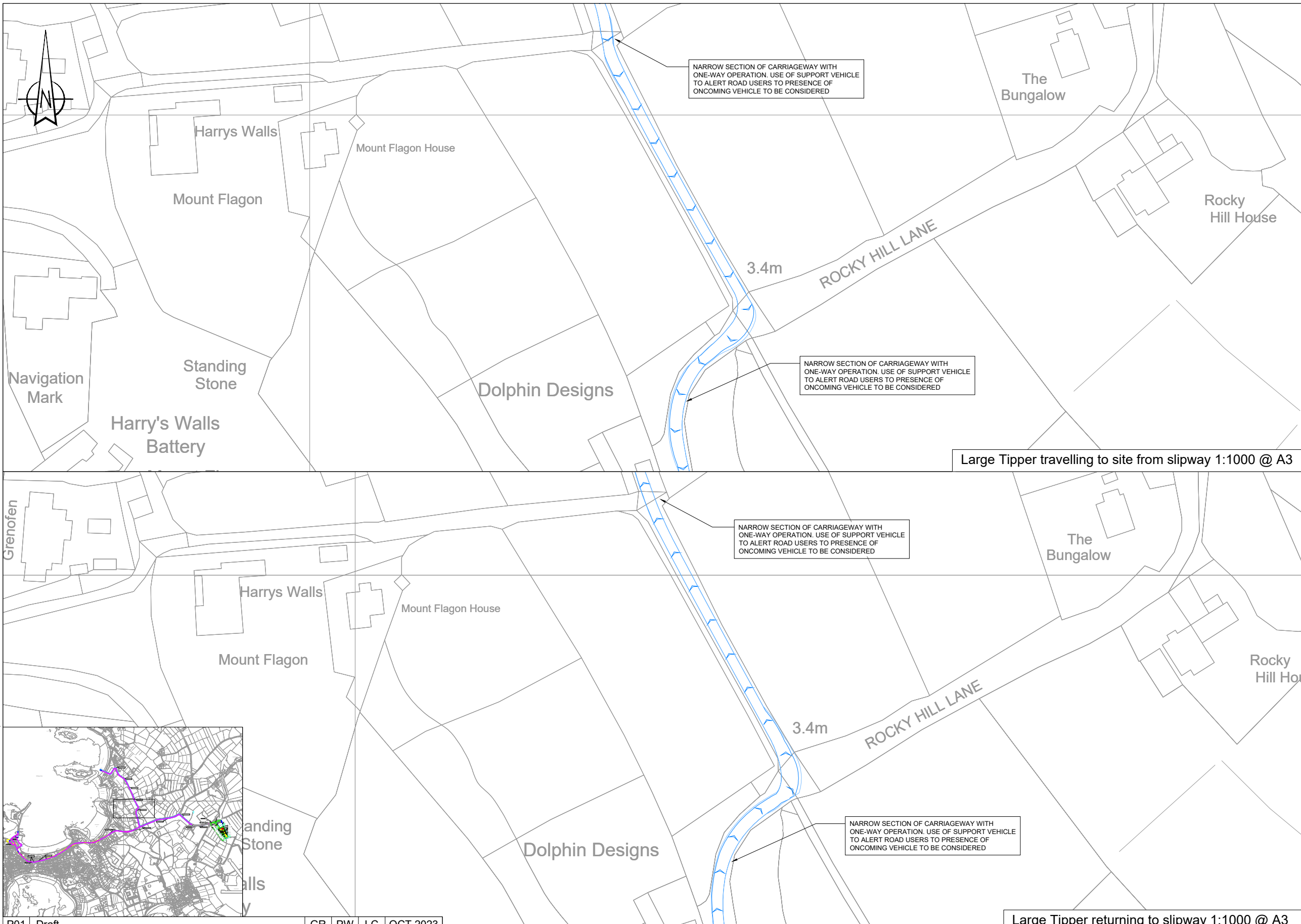

- NOTES**
1. THE VEHICLE ROUTE APPRAISAL CONSIDERED WITHIN THIS DRAWING IS BASED ON A DESKTOP APPRAISAL ONLY INCLUDING REVIEW OF GOOGLE SATELLITE IMAGERY DATED 07.10.2022 AND REVIEWED IN OCTOBER 2023. THIS PROVIDES AN APPRAISAL OF A SINGLE POINT IN TIME THEREFORE THE LOCATIONS PERMITTING VEHICLE PARKING, VEHICLE LOADING AND THE LOCATION OF POTENTIAL OBSTRUCTIONS TO CONSTRUCTION TRAFFIC (STREET FURNITURE FOR EXAMPLE) MAY EXTEND BEYOND THOSE IDENTIFIED IN THIS DRAWING.
  2. PRIOR TO THE TRANSPORTING OF MATERIALS ASSOCIATED WITH THE CONSTRUCTION OF THE COMPOUND AND FUTURE WASTEWATER CAPITAL IMPROVEMENT PROJECTS FOR THE ISLES OF SCILLY A FULL REVIEW OF THE HAULAGE ROUTE WILL NEED TO BE COMPLETED ON THE GROUND. THE CONTRACTOR RESPONSIBLE FOR THE MOVEMENT OF VEHICLES AND MATERIALS WILL NEED TO BE SATISFIED THAT THE ROUTE IS ADEQUATE TO ACCOMMODATE THE RELEVANT VEHICLE AND THAT WHERE INTERVENTIONS / MANAGEMENT ARE REQUIRED THAT THIS IS AGREED WITH THE ISLES OF SCILLY COUNCIL PRIOR TO THE MOVEMENT OF CONSTRUCTION VEHICLES OR ANY CONSTRUCTION WORK COMMENCING.

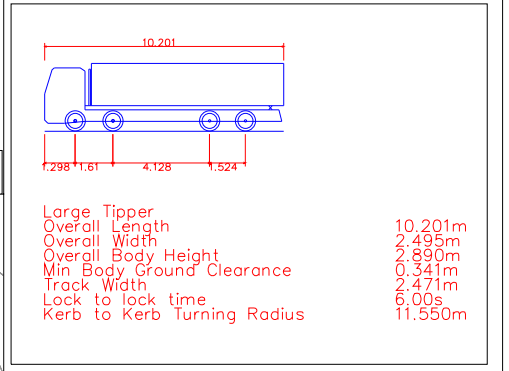

Large Tipper travelling to site from slipway 1:1000 @ A3

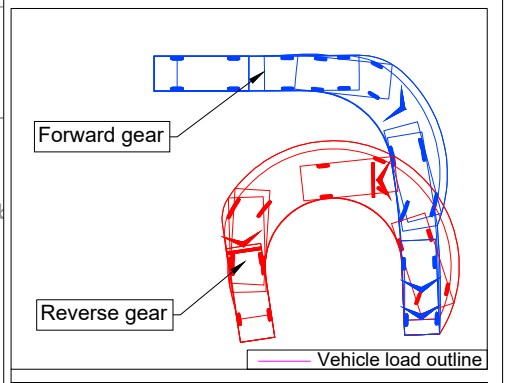

**KEY**

On street parking where satellite imagery indicates this does not obstruct the routing of a compound delivery vehicle. However, it may limit operation to one-way working.

On street parking where satellite imagery indicates that routing of a compound delivery vehicle would be obstructed.

Large Tipper returning to slipway 1:1000 @ A3

P01 Draft GR PW LC OCT 2023

**Pell Frischmann**  
 BURRATOR HOUSE, PENINSULA PARK, EXETER, EX2 7NT  
 Telephone +44 (0)1392 444 345  
 Email: pfEXETER@pellfrischmann.com  
 www.pellfrischmann.com

Project	Isles of Scilly Plants & WTW		
Drawing Title	Swept Path Analysis - Large Tipper Porth Loo Lane (North)		

Drawn	GR	OCT 2023	Scale	As Shown
Designed	-	-	File No.	107780-PEF-XX-500-D.DR-H-0009.dwg
Checked	PW	OCT 2023	Drawing Status	Working Draft
Approved	LC	OCT 2023	Drawing No.	107780-PEF-XX-500-D.DR-H-0009
			Revision	P01

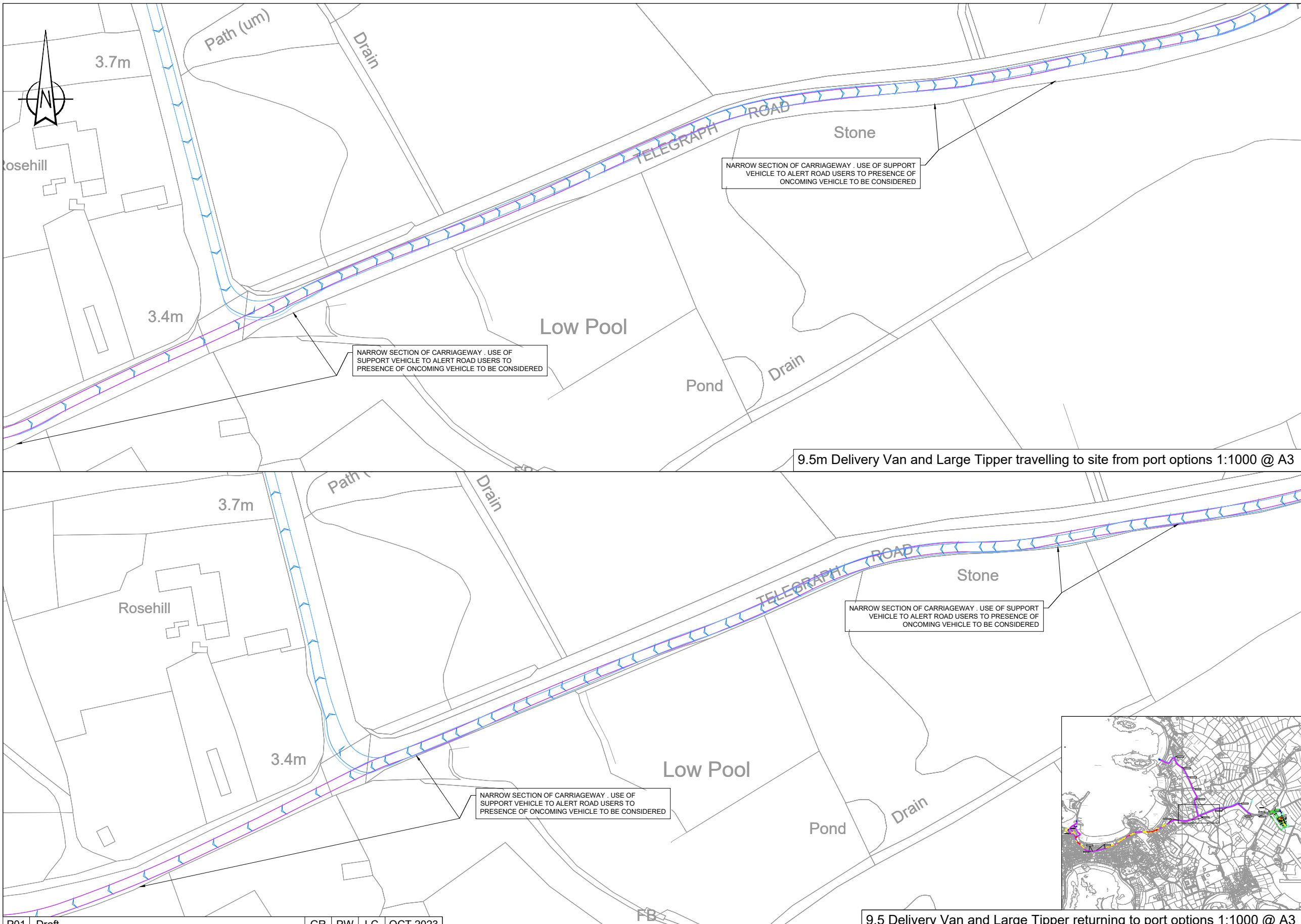

- NOTES**
1. THE VEHICLE ROUTE APPRAISAL CONSIDERED WITHIN THIS DRAWING IS BASED ON A DESKTOP APPRAISAL ONLY INCLUDING REVIEW OF GOOGLE SATELLITE IMAGERY DATED 07.10.2022 AND REVIEWED IN OCTOBER 2023. THIS PROVIDES AN APPRAISAL OF A SINGLE POINT IN TIME THEREFORE THE LOCATIONS PERMITTING VEHICLE PARKING, VEHICLE LOADING AND THE LOCATION OF POTENTIAL OBSTRUCTIONS TO CONSTRUCTION TRAFFIC (STREET FURNITURE FOR EXAMPLE) MAY EXTEND BEYOND THOSE IDENTIFIED IN THIS DRAWING.
  2. PRIOR TO THE TRANSPORTING OF MATERIALS ASSOCIATED WITH THE CONSTRUCTION OF THE COMPOUND AND FUTURE WASTEWATER CAPITAL IMPROVEMENT PROJECTS FOR THE ISLES OF SCILLY A FULL REVIEW OF THE HAULAGE ROUTE WILL NEED TO BE COMPLETED ON THE GROUND. THE CONTRACTOR RESPONSIBLE FOR THE MOVEMENT OF VEHICLES AND MATERIALS WILL NEED TO BE SATISFIED THAT THE ROUTE IS ADEQUATE TO ACCOMMODATE THE RELEVANT VEHICLE AND THAT WHERE INTERVENTIONS / MANAGEMENT ARE REQUIRED THAT THIS IS AGREED WITH THE ISLES OF SCILLY COUNCIL PRIOR TO THE MOVEMENT OF CONSTRUCTION VEHICLES OR ANY CONSTRUCTION WORK COMMENCING.

9.5m Delivery Van and Large Tipper travelling to site from port options 1:1000 @ A3

9.5 Delivery Van and Large Tipper returning to port options 1:1000 @ A3

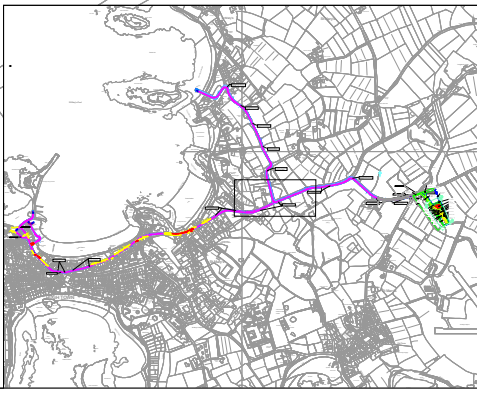
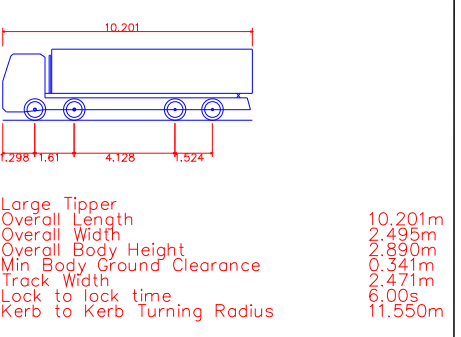
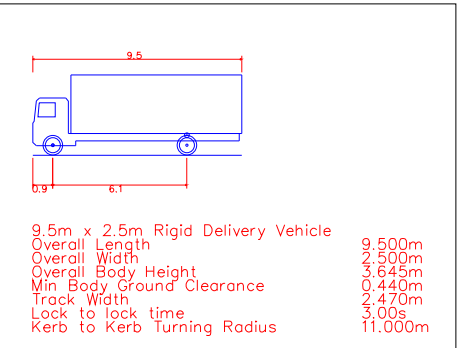

**KEY**

- On street parking where satellite imagery indicates this does not obstruct the routing of a compound delivery vehicle. However, it may limit operation to one-way working.
- On street parking where satellite imagery indicates that routing of a compound delivery vehicle would be obstructed.

P01 Draft GR PW LC OCT 2023

**Pell Frischmann**  
 BURRATOR HOUSE, PENINSULA PARK, EXETER, EX2 7NT  
 Telephone +44 (0)1392 444 345  
 Email: pfEXETER@pellfrischmann.com  
 www.pellfrischmann.com

Project	Isles of Scilly Plants & WTW		
Drawing Title	Swept Path Analysis - 9.5m Rigid Delivery Vehicle and Large Tipper Telegraph Road / Porth Loo Lane Junction		

Name	Date
Drawn GR	OCT 2023
Designed -	-
Checked PW	OCT 2023
Approved LC	OCT 2023
Drawing No.	107780-PEF-XX-500-D.DR-H-0007

Scale	As Shown
File No.	107780-PEF-XX-500-D.DR-H-0007.dwg
Drawing Status	Working Draft
Revision	P01

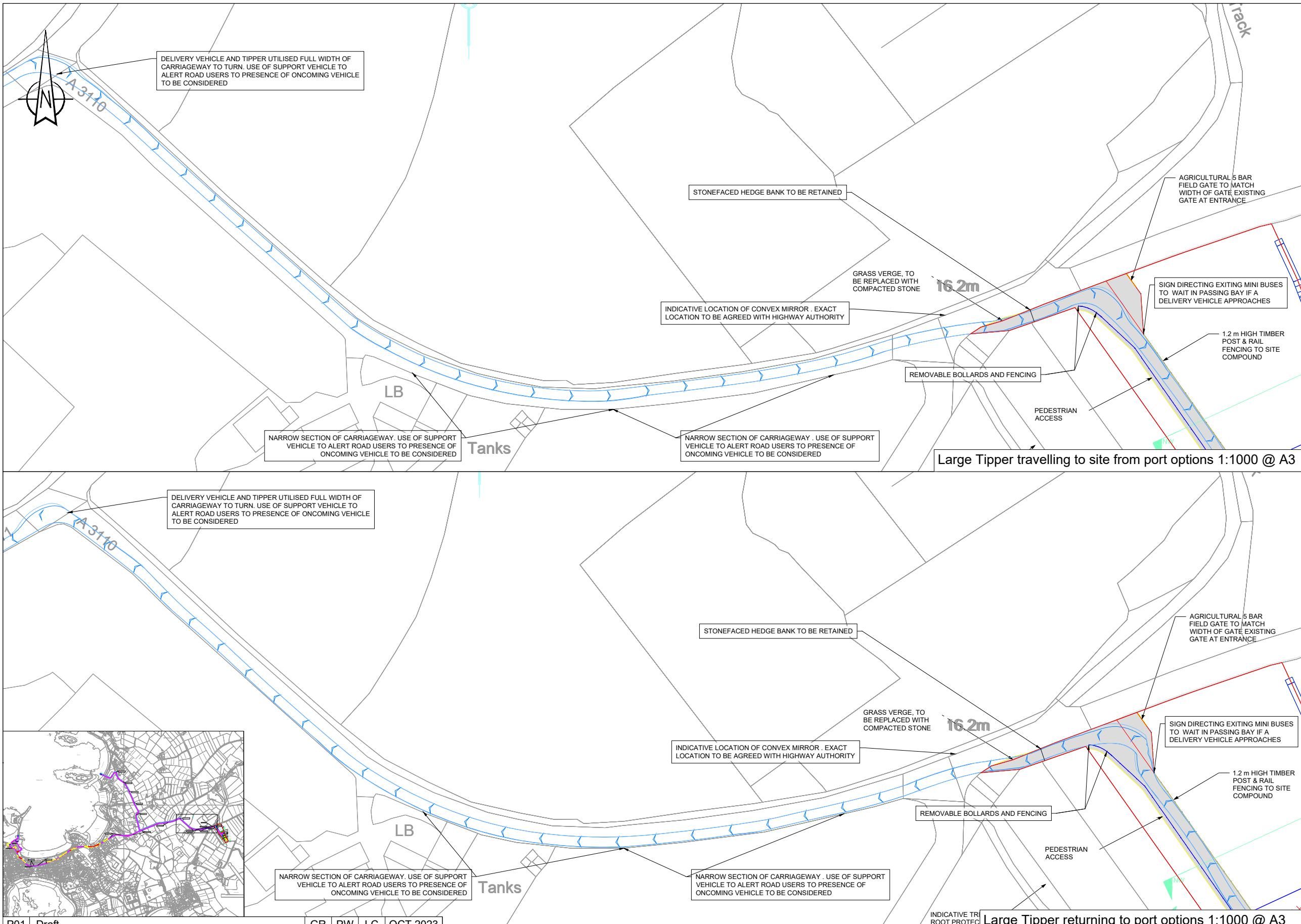

- NOTES**
1. THE VEHICLE ROUTE APPRAISAL CONSIDERED WITHIN THIS DRAWING IS BASED ON A DESKTOP APPRAISAL ONLY INCLUDING REVIEW OF GOOGLE SATELLITE IMAGERY DATED 07.10.2022 AND REVIEWED IN OCTOBER 2023. THIS PROVIDES AN APPRAISAL OF A SINGLE POINT IN TIME THEREFORE THE LOCATIONS PERMITTING VEHICLE PARKING, VEHICLE LOADING AND THE LOCATION OF POTENTIAL OBSTRUCTIONS TO CONSTRUCTION TRAFFIC (STREET FURNITURE FOR EXAMPLE) MAY EXTEND BEYOND THOSE IDENTIFIED IN THIS DRAWING.
  2. PRIOR TO THE TRANSPORTING OF MATERIALS ASSOCIATED WITH THE CONSTRUCTION OF THE COMPOUND AND FUTURE WASTEWATER CAPITAL IMPROVEMENT PROJECTS FOR THE ISLES OF SCILLY A FULL REVIEW OF THE HAULAGE ROUTE WILL NEED TO BE COMPLETED ON THE GROUND. THE CONTRACTOR RESPONSIBLE FOR THE MOVEMENT OF VEHICLES AND MATERIALS WILL NEED TO BE SATISFIED THAT THE ROUTE IS ADEQUATE TO ACCOMMODATE THE RELEVANT VEHICLE AND THAT WHERE INTERVENTIONS / MANAGEMENT ARE REQUIRED THAT THIS IS AGREED WITH THE ISLES OF SCILLY COUNCIL PRIOR TO THE MOVEMENT OF CONSTRUCTION VEHICLES OR ANY CONSTRUCTION WORK COMMENCING.

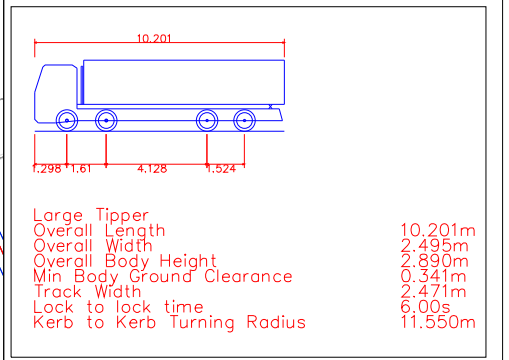
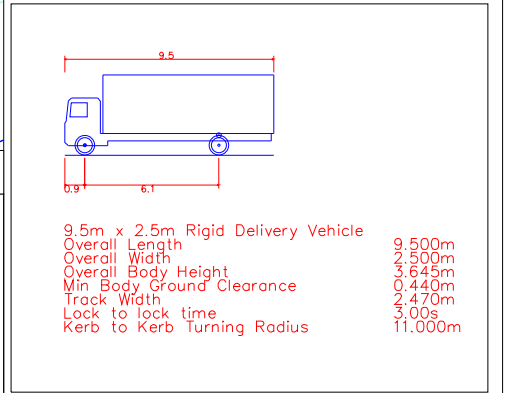

**KEY**

- On street parking where satellite imagery indicates this does not obstruct the routing of a compound delivery vehicle. However, it may limit operation to one-way working.
- On street parking where satellite imagery indicates that routing of a compound delivery vehicle would be obstructed.

P01 Draft GR PW LC OCT 2023

**Pell Frischmann**  
 BURRATOR HOUSE, PENINSULA PARK, EXETER, EX2 7NT  
 Telephone +44 (0)1392 444 345  
 Email: pfEXETER@pellfrischmann.com  
 www.pellfrischmann.com

Project: Isles of Scilly Plants & WTW  
 Drawing Title: Swept Path Analysis - Large Tipper Parting Carn Lane / Site Entrance

	Name	Date
Drawn	GR	OCT 2023
Designed	-	-
Checked	PW	OCT 2023
Approved	LC	OCT 2023
Drawing No.	107780-PEF-XX-500-D.DR-H-0008	

Scale	As Shown
File No.	107780-PEF-XX-500-D.DR-H-0008.dwg
Drawing Status	Working Draft
Revision	P01

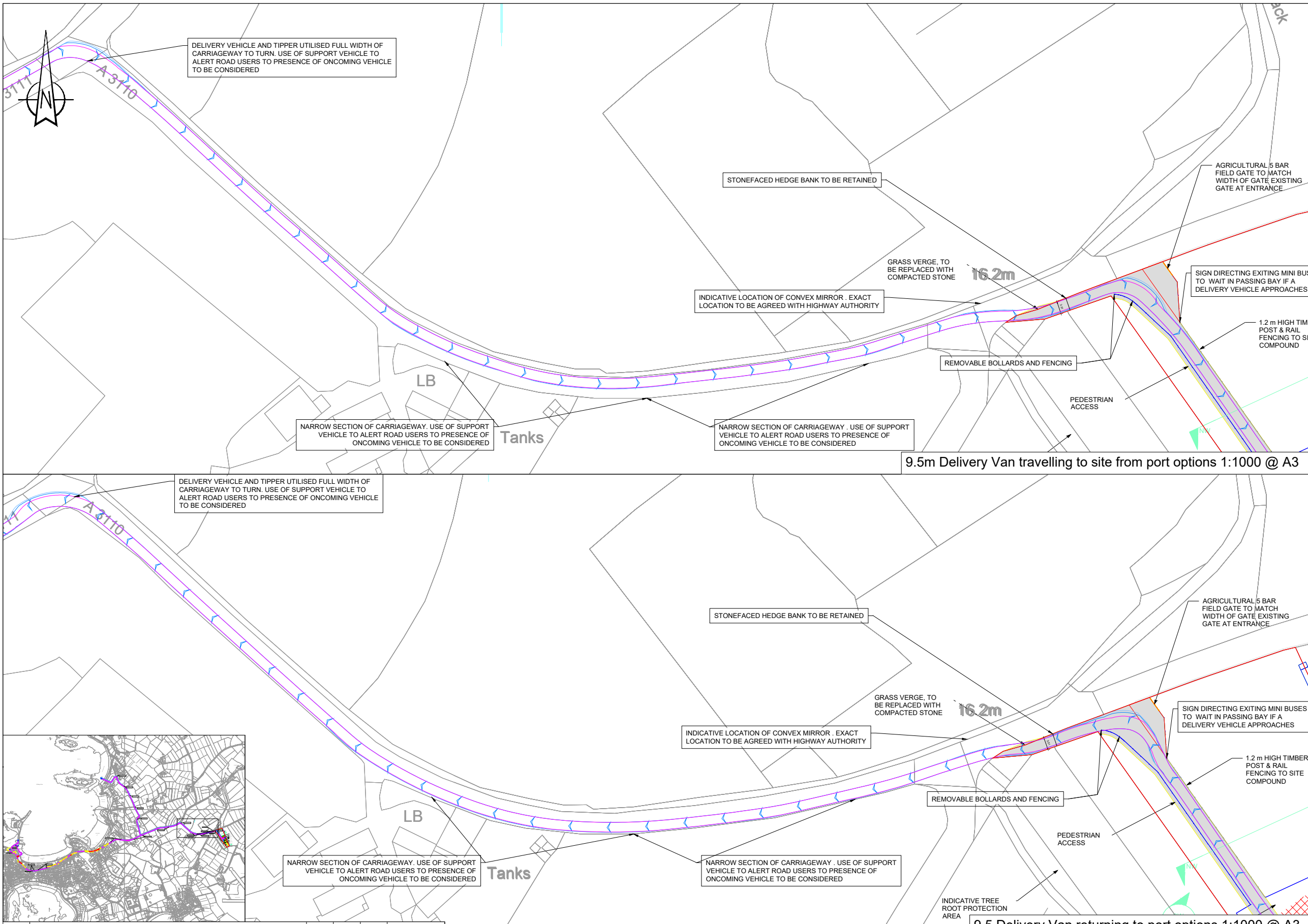

- NOTES**
1. THE VEHICLE ROUTE APPRAISAL CONSIDERED WITHIN THIS DRAWING IS BASED ON A DESKTOP APPRAISAL ONLY INCLUDING REVIEW OF GOOGLE SATELLITE IMAGERY DATED 07.10.2022 AND REVIEWED IN OCTOBER 2023. THIS PROVIDES AN APPRAISAL OF A SINGLE POINT IN TIME THEREFORE THE LOCATIONS PERMITTING VEHICLE PARKING, VEHICLE LOADING AND THE LOCATION OF POTENTIAL OBSTRUCTIONS TO CONSTRUCTION TRAFFIC (STREET FURNITURE FOR EXAMPLE) MAY EXTEND BEYOND THOSE IDENTIFIED IN THIS DRAWING.
  2. PRIOR TO THE TRANSPORTING OF MATERIALS ASSOCIATED WITH THE CONSTRUCTION OF THE COMPOUND AND FUTURE WASTEWATER CAPITAL IMPROVEMENT PROJECTS FOR THE ISLES OF SCILLY A FULL REVIEW OF THE HAULAGE ROUTE WILL NEED TO BE COMPLETED ON THE GROUND. THE CONTRACTOR RESPONSIBLE FOR THE MOVEMENT OF VEHICLES AND MATERIALS WILL NEED TO BE SATISFIED THAT THE ROUTE IS ADEQUATE TO ACCOMMODATE THE RELEVANT VEHICLE AND THAT WHERE INTERVENTIONS / MANAGEMENT ARE REQUIRED THAT THIS IS AGREED WITH THE ISLES OF SCILLY COUNCIL PRIOR TO THE MOVEMENT OF CONSTRUCTION VEHICLES OR ANY CONSTRUCTION WORK COMMENCING.

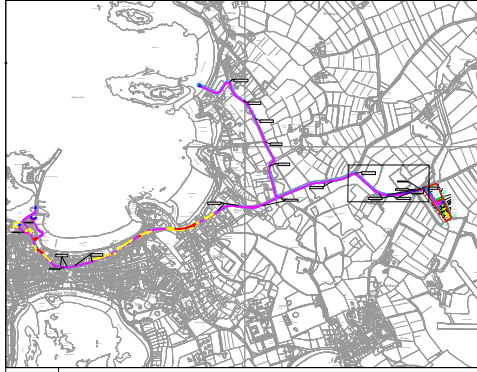
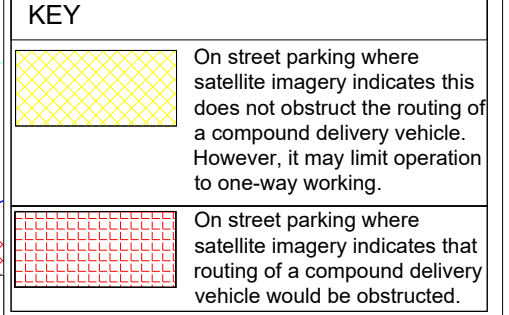
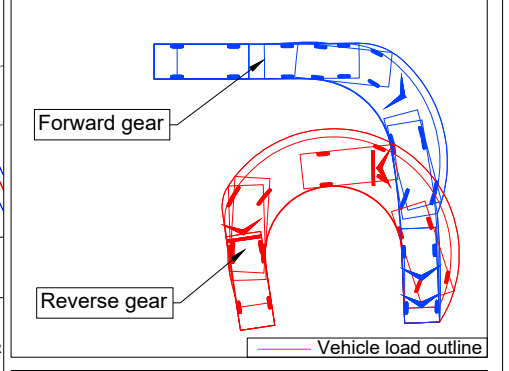
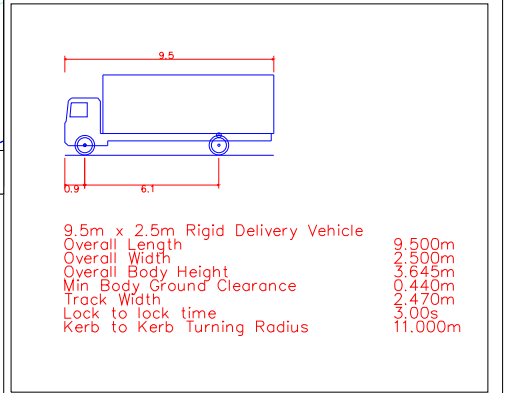

P01 Draft GR PW LC OCT 2023

**Pell Frischmann**  
BURRATOR HOUSE, PENINSULA PARK, EXETER, EX2 7NT  
Telephone +44 (0)1392 444 345  
Email: pfEXETER@pellfrischmann.com  
www.pellfrischmann.com

Project: Isles of Scilly Plants & WTW  
Drawing Title: Swept Path Analysis - 9.5m Rigid Delivery Vehicle Parting Carn Lane / Site Entrance

Name	Date
Drawn: GR	OCT 2023
Designed: -	-
Checked: PW	OCT 2023
Approved: LC	OCT 2023
Drawing No.	107780-PEF-XX-500-D.DR-H-0015

Scale	As Shown
File No.	107780-PEF-XX-500-D.DR-H-0015.dwg
Drawing Status	Working Draft
Revision	P01





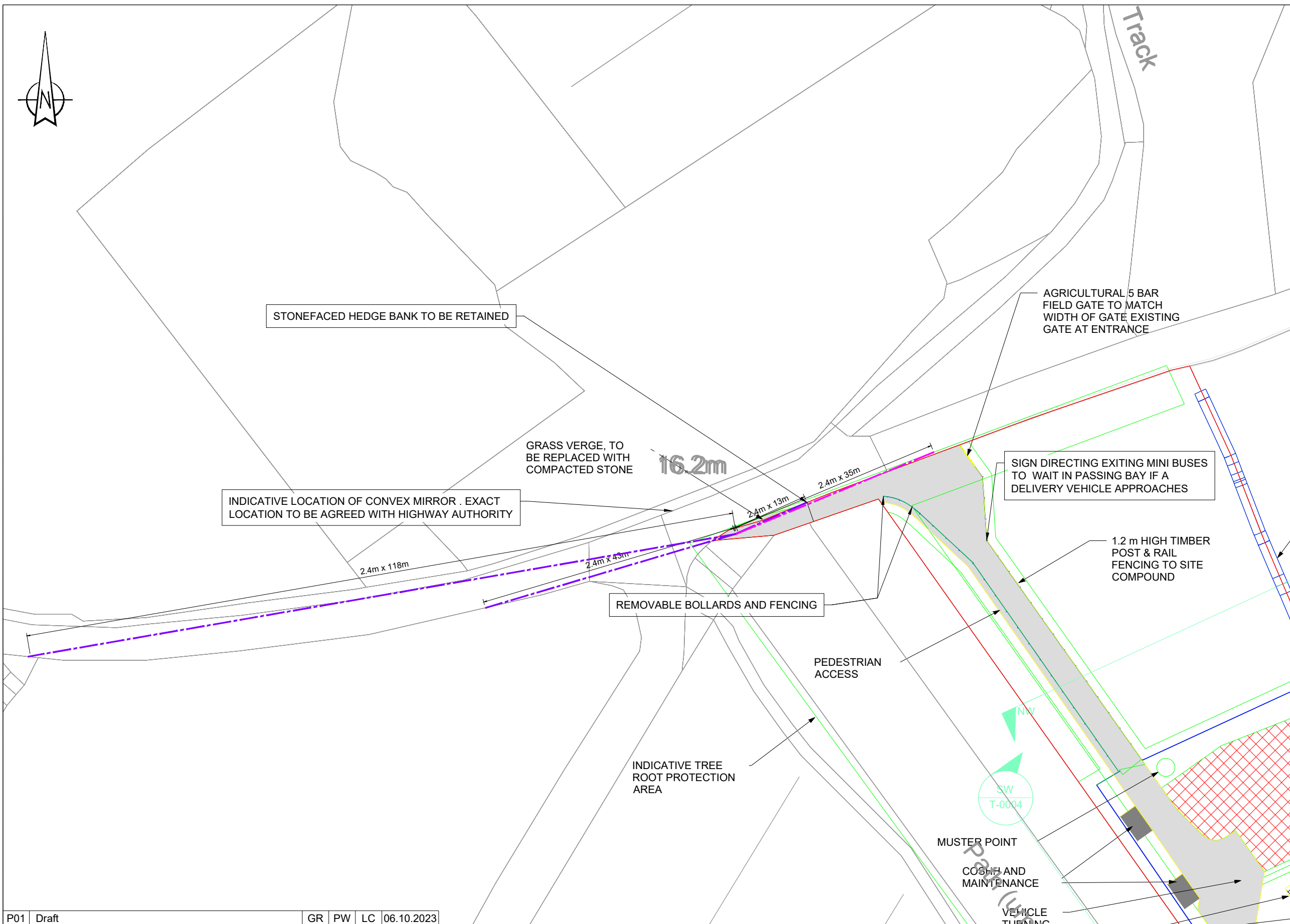
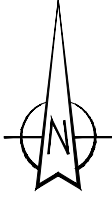

NOTES



KEY

	VISIBILITY SPLAY
	VISIBILITY SPLAY BASED ON ELEVATED VEHICLE CAB HEIGHT

P01 | Draft | GR | PW | LC | 06.10.2023

**Pell Frischmann**  
 BURRATOR HOUSE, PENINSULA PARK, EXETER, EX2 7NT  
 Telephone +44 (0)1392 444 345  
 Email: pfEXETER@pellfrischmann.com  
 www.pellfrischmann.com

Project  
**Isles of Scilly Plants & WTW**

Drawing Title  
**Visibility Splay Analysis Site Entrance**

	Name	Date
Drawn	GR	OCT 2023
Designed	-	-
Checked	PW	OCT 2023
Approved	LC	OCT 2023

Drawing No.  
**107780-PEF-XX-500-D.DR-H-0014**

Scale	1:500 @ A3
File No.	107780-PEF-XX-500-D.DR-H-0014.dwg
Drawing Status	For Information
Revision	<b>P01</b>

## Appendix D – Site vehicle swept path analysis

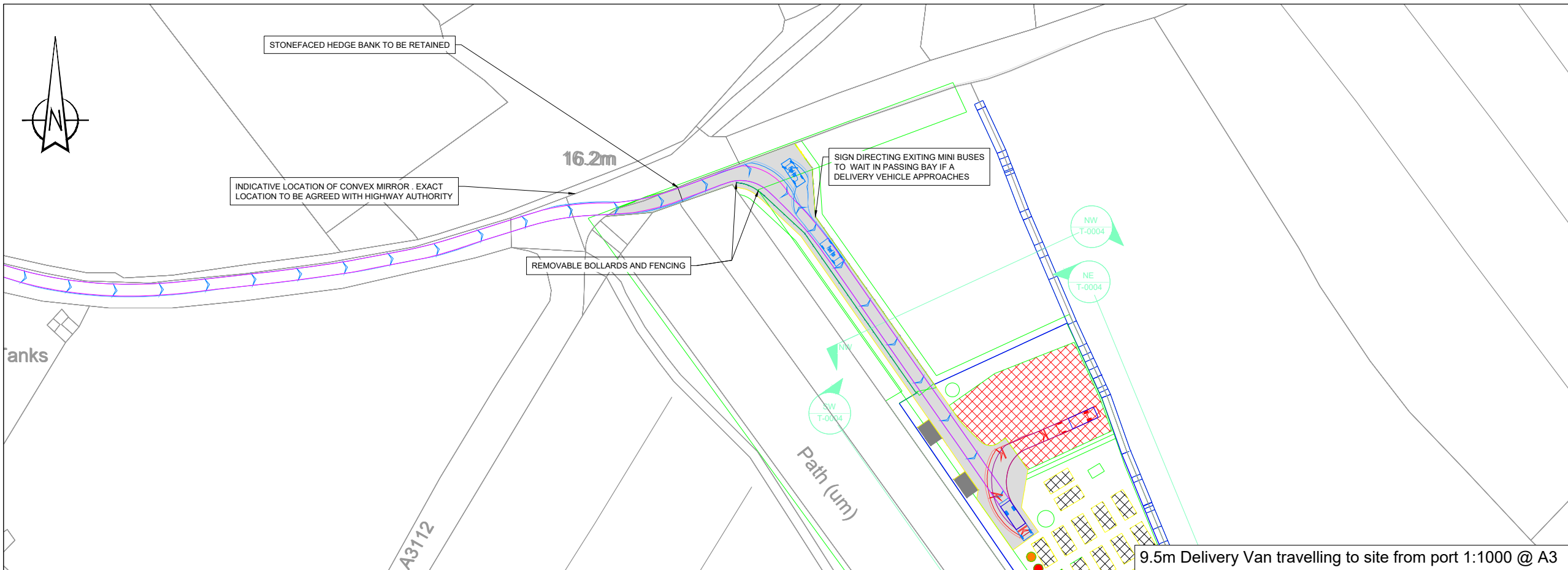

9.5m Delivery Van travelling to site from port 1:1000 @ A3

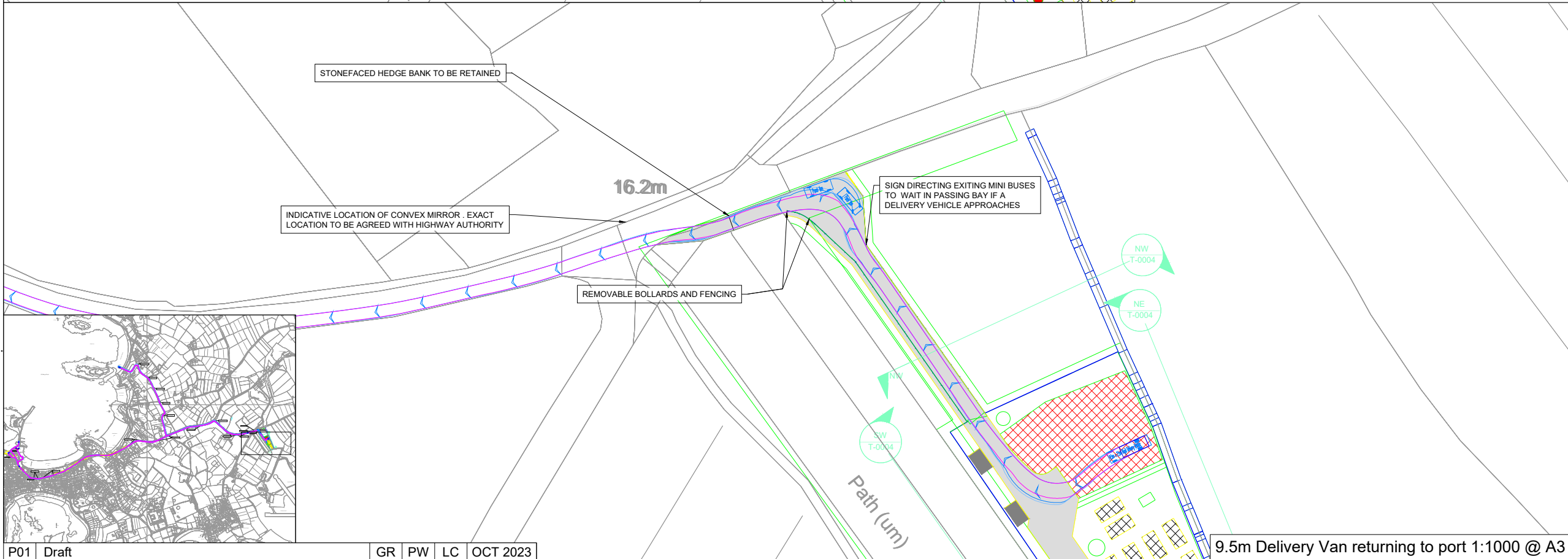

9.5m Delivery Van returning to port 1:1000 @ A3

- NOTES**
1. THE VEHICLE ROUTE APPRAISAL CONSIDERED WITHIN THIS DRAWING IS BASED ON A DESKTOP APPRAISAL ONLY INCLUDING REVIEW OF GOOGLE SATELLITE IMAGERY DATED 07.10.2022 AND REVIEWED IN OCTOBER 2023. THIS PROVIDES AN APPRAISAL OF A SINGLE POINT IN TIME THEREFORE THE LOCATIONS PERMITTING VEHICLE PARKING, VEHICLE LOADING AND THE LOCATION OF POTENTIAL OBSTRUCTIONS TO CONSTRUCTION TRAFFIC (STREET FURNITURE FOR EXAMPLE) MAY EXTEND BEYOND THOSE IDENTIFIED IN THIS DRAWING.
  2. PRIOR TO THE TRANSPORTING OF MATERIALS ASSOCIATED WITH THE CONSTRUCTION OF THE COMPOUND AND FUTURE WASTEWATER CAPITAL IMPROVEMENT PROJECTS FOR THE ISLES OF SCILLY A FULL REVIEW OF THE HAULAGE ROUTE WILL NEED TO BE COMPLETED ON THE GROUND. THE CONTRACTOR RESPONSIBLE FOR THE MOVEMENT OF VEHICLES AND MATERIALS WILL NEED TO BE SATISFIED THAT THE ROUTE IS ADEQUATE TO ACCOMMODATE THE RELEVANT VEHICLE AND THAT WHERE INTERVENTIONS / MANAGEMENT ARE REQUIRED THAT THIS IS AGREED WITH THE ISLES OF SCILLY COUNCIL PRIOR TO THE MOVEMENT OF CONSTRUCTION VEHICLES OR ANY CONSTRUCTION WORK COMMENCING.

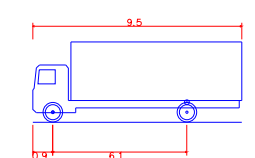

9.5m x 2.5m Rigid Delivery Vehicle

Overall Length	9.500m
Overall Width	2.500m
Overall Body Height	3.645m
Min Body Ground Clearance	0.440m
Track Width	2.470m
Lock to lock time	3.00s
Kerb to Kerb Turning Radius	11.000m

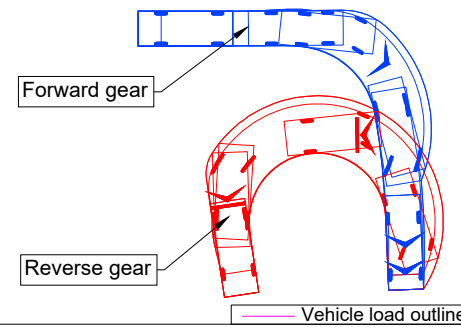

**KEY**

- On street parking where satellite imagery indicates this does not obstruct the routing of a compound delivery vehicle. However, it may limit operation to one-way working.
- On street parking where satellite imagery indicates that routing of a compound delivery vehicle would be obstructed.

P01 Draft GR PW LC OCT 2023

**Pell Frischmann**  
 BURRATOR HOUSE, PENINSULA PARK, EXETER, EX2 7NT  
 Telephone +44 (0)1392 444 345  
 Email: pfEXETER@pellfrischmann.com  
 www.pellfrischmann.com

Project	Isles of Scilly Plants & WTW			Scale	As Shown	
Drawing Title	Swept Path Analysis - 9.5m Rigid Delivery Vehicle Site Maneuvres			File No.	107780-PEF-XX-500-D.DR-H-0012.dwg	
	Drawn	GR	OCT 2023	Drawing Status	Working Draft	
	Designed	-	-	Drawing No.	107780-PEF-XX-500-D.DR-H-0012	
	Checked	PW	OCT 2023	Revision	P01	
	Approved	LC	OCT 2023			

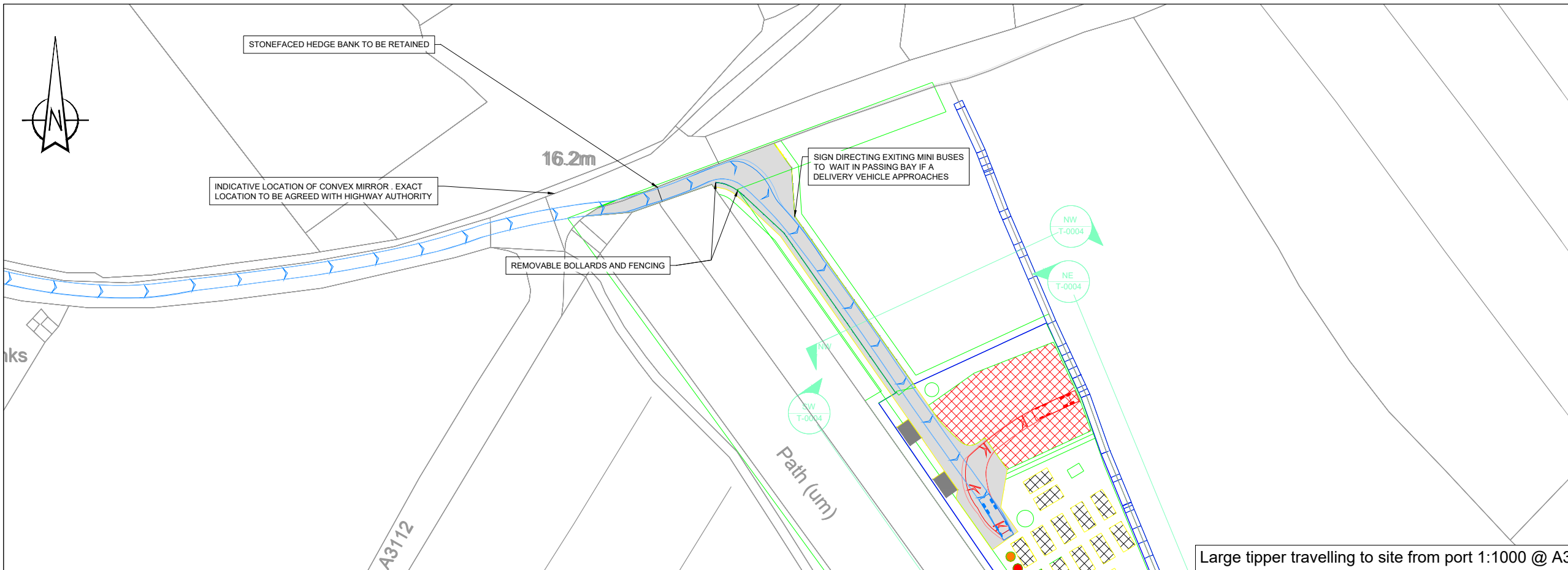

**NOTES**

1. THE VEHICLE ROUTE APPRAISAL CONSIDERED WITHIN THIS DRAWING IS BASED ON A DESKTOP APPRAISAL ONLY INCLUDING REVIEW OF GOOGLE SATELLITE IMAGERY DATED 07.10.2022 AND REVIEWED IN OCTOBER 2023. THIS PROVIDES AN APPRAISAL OF A SINGLE POINT IN TIME THEREFORE THE LOCATIONS PERMITTING VEHICLE PARKING, VEHICLE LOADING AND THE LOCATION OF POTENTIAL OBSTRUCTIONS TO CONSTRUCTION TRAFFIC (STREET FURNITURE FOR EXAMPLE) MAY EXTEND BEYOND THOSE IDENTIFIED IN THIS DRAWING.
2. PRIOR TO THE TRANSPORTING OF MATERIALS ASSOCIATED WITH THE CONSTRUCTION OF THE COMPOUND AND FUTURE WASTEWATER CAPITAL IMPROVEMENT PROJECTS FOR THE ISLES OF SCILLY A FULL REVIEW OF THE HAULAGE ROUTE WILL NEED TO BE COMPLETED ON THE GROUND. THE CONTRACTOR RESPONSIBLE FOR THE MOVEMENT OF VEHICLES AND MATERIALS WILL NEED TO BE SATISFIED THAT THE ROUTE IS ADEQUATE TO ACCOMMODATE THE RELEVANT VEHICLE AND THAT WHERE INTERVENTIONS / MANAGEMENT ARE REQUIRED THAT THIS IS AGREED WITH THE ISLES OF SCILLY COUNCIL PRIOR TO THE MOVEMENT OF CONSTRUCTION VEHICLES OR ANY CONSTRUCTION WORK COMMENCING.

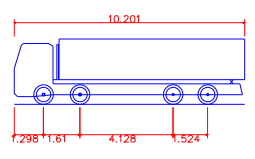

Large tipper travelling to site from port 1:1000 @ A3

Large Tipper  
 Overall Length 10.201m  
 Overall Width 2.495m  
 Overall Body Height 2.890m  
 Min Body Ground Clearance 0.341m  
 Track Width 2.471m  
 Lock to lock time 6.00s  
 Kerb to Kerb Turning Radius 11.550m

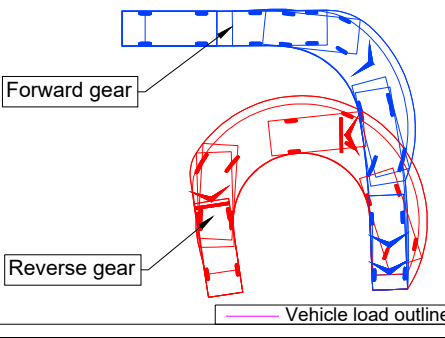
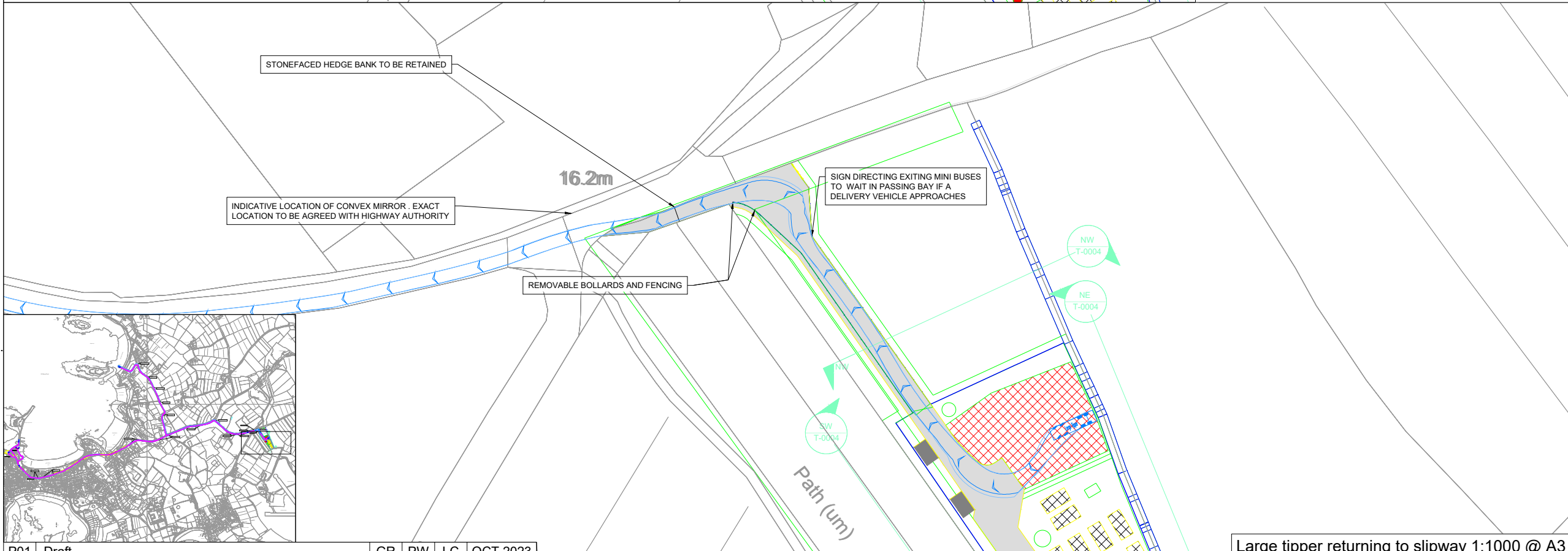

**KEY**

On street parking where satellite imagery indicates this does not obstruct the routing of a compound delivery vehicle. However, it may limit operation to one-way working.

On street parking where satellite imagery indicates that routing of a compound delivery vehicle would be obstructed.

P01 Draft GR PW LC OCT 2023

Large tipper returning to slipway 1:1000 @ A3

**Pell Frischmann**  
 BURRATOR HOUSE, PENINSULA PARK, EXETER, EX2 7NT  
 Telephone +44 (0)1392 444 345  
 Email: pfEXETER@pellfrischmann.com  
 www.pellfrischmann.com

Project	Isles of Scilly Plants & WTW		
Drawing Title	Swept Path Analysis - Large Tipper Site Maneuvres		
Project	Name	Date	Scale
	GR	OCT 2023	As Shown
	-	-	File No. 107780-PEF-XX-500-D.DR-H-0013.dwg
	PW	OCT 2023	Drawing Status Working Draft
	LC	OCT 2023	
Drawing No.	107780-PEF-XX-500-D.DR-H-0013		Revision P01

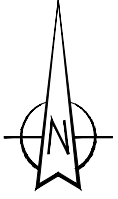

STONEFACED HEDGE BANK TO BE RETAINED

9.2M DELIVERY VEHICLE WAITING FOR ACCESS TO CLEAR BEFORE PROCEEDING

INDICATIVE LOCATION OF CONVEX MIRROR . EXACT LOCATION TO BE AGREED WITH HIGHWAY AUTHORITY

16.2m

SIGN DIRECTING EXITING MINI BUSES TO WAIT IN PASSING BAY IF A DELIVERY VEHICLE APPROACHES

REMOVABLE BOLLARDS AND FENCING

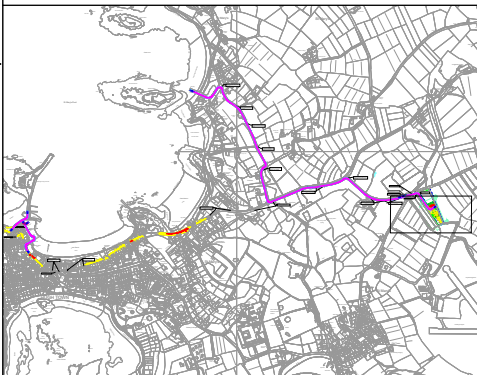

NOTES

1. THE VEHICLE ROUTE APPRAISAL CONSIDERED WITHIN THIS DRAWING IS BASED ON A DESKTOP APPRAISAL ONLY INCLUDING REVIEW OF GOOGLE SATELLITE IMAGERY DATED 07.10.2022 AND REVIEWED IN OCTOBER 2023. THIS PROVIDES AN APPRAISAL OF A SINGLE POINT IN TIME THEREFORE THE LOCATIONS PERMITTING VEHICLE PARKING, VEHICLE LOADING AND THE LOCATION OF POTENTIAL OBSTRUCTIONS TO CONSTRUCTION TRAFFIC (STREET FURNITURE FOR EXAMPLE) MAY EXTEND BEYOND THOSE IDENTIFIED IN THIS DRAWING.
2. PRIOR TO THE TRANSPORTING OF MATERIALS ASSOCIATED WITH THE CONSTRUCTION OF THE COMPOUND AND FUTURE WASTEWATER CAPITAL IMPROVEMENT PROJECTS FOR THE ISLES OF SCILLY A FULL REVIEW OF THE HAULAGE ROUTE WILL NEED TO BE COMPLETED ON THE GROUND. THE CONTRACTOR RESPONSIBLE FOR THE MOVEMENT OF VEHICLES AND MATERIALS WILL NEED TO BE SATISFIED THAT THE ROUTE IS ADEQUATE TO ACCOMMODATE THE RELEVANT VEHICLE AND THAT WHERE INTERVENTIONS / MANAGEMENT ARE REQUIRED THAT THIS IS AGREED WITH THE ISLES OF SCILLY COUNCIL PRIOR TO THE MOVEMENT OF CONSTRUCTION VEHICLES OR ANY CONSTRUCTION WORK COMMENCING.

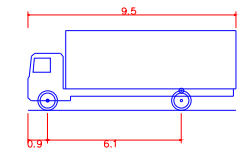

9.5m x 2.5m Rigid Delivery Vehicle  
 Overall Length 9.500m  
 Overall Width 2.500m  
 Overall Body Height 3.645m  
 Min Body Ground Clearance 0.440m  
 Track Width 2.470m  
 Lock to lock time 3.00s  
 Kerb to Kerb Turning Radius 11.000m

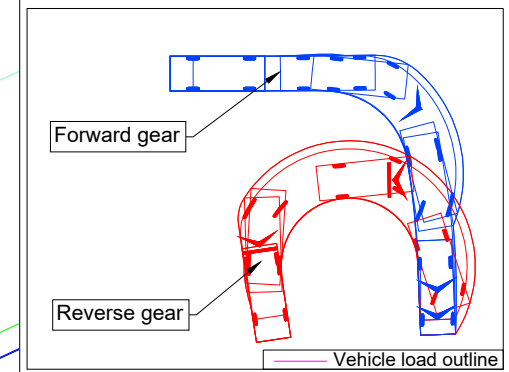

**KEY**

On street parking where satellite imagery indicates this does not obstruct the routing of a compound delivery vehicle. However, it may limit operation to one-way working.

On street parking where satellite imagery indicates that routing of a compound delivery vehicle would be obstructed.

P01 Draft GR PW LC OCT 2023

**Pell Frischmann**

BURRATOR HOUSE, PENINSULA PARK, EXETER, EX2 7NT

Telephone +44 (0)1392 444 345  
 Email: pfEXETER@pellfrischmann.com  
 www.pellfrischmann.com

Project

Isles of Scilly Plants & WTW

Drawing Title

Swept Path Analysis - 9.5m Rigid Delivery Vehicle  
 Waiting For Access To Clear

	Name	Date
Drawn	GR	OCT 2023
Designed	-	-
Checked	PW	OCT 2023
Approved	LC	OCT 2023

Scale	1:500 @ A3
File No.	107780-PEF-XX-500-D.DR-H-0016.dwg
Drawing Status	Working Draft

Drawing No.	107780-PEF-XX-500-D.DR-H-0016	Revision	P01
-------------	-------------------------------	----------	-----