

**RECEIVED**

By Liv Rickman at 2:59 pm, Feb 22, 2024

**Construction Materials**

External walls: Natural granite random rubble walls with recessed pointing  
Roof: Natural slate with grey angle ridge tiles  
Fascia boards and soffits: Painted s/w  
Doors and windows: Painted timber  
Rainwater goods: Black round section downpipes and gutters

**NOTES**

- 1 THIS DRAWING IS THE COPYRIGHT OF THE ARCHITECT AND MAY NOT BE REPRODUCED WITHOUT LICENCE
- 2 ALL DIMENSIONS AND LEVELS ARE TO BE CHECKED ON SITE BY THE CONTRACTOR BEFORE COMMENCEMENT OF WORK AND ANY DISCREPANCIES REPORTED TO THE ARCHITECT
- 3 NO RESPONSIBILITY CAN BE ACCEPTED FOR ERRORS ARISING ON SITE DUE TO UNAUTHORISED VARIATIONS FROM THE ARCHITECTS DRAWINGS.

**AMENDMENTS**

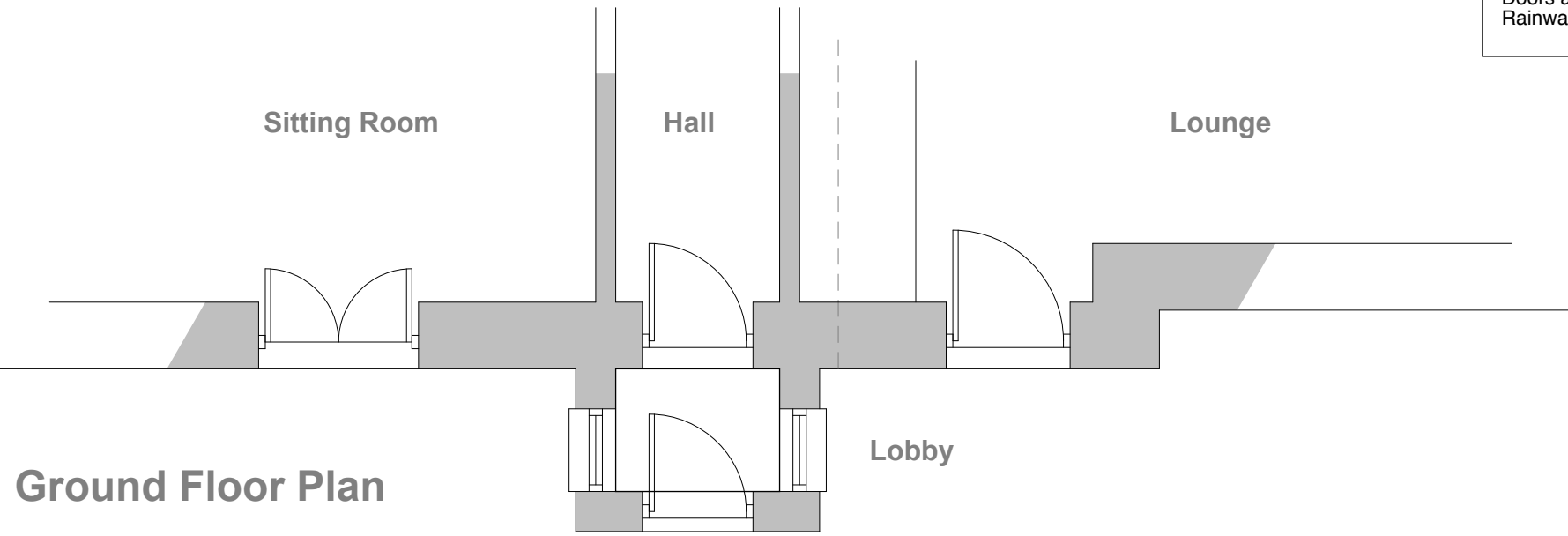

**Ground Floor Plan**



**Front Elevation**



**PLANNING**

Studio St Ives  
4 Gabriel Street, St Ives TR26 2LU  
01736 798427

**MIKE BRADBURY  
DESIGN**

**Alterations to  
Charlotte House, Garrison Lane  
Hugh Town, St. Mary's  
Isles of Scilly  
TR21 0JD  
for Mr & Mrs B Ronan**

**Existing Plans**

**2039-P01**

**1:25 @ A1  
1:50 @ A3**      **Nov 2023**

OFFICE USE / PRE-ISSUE