

Scale 1:200

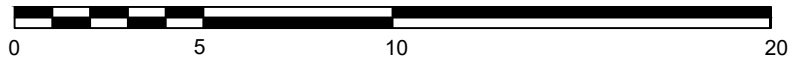

NOTES

- New Solar PV ground array to the grassed area adjacent to the swimming pool reception building.
- PV panels installed in a South-Westerly facing orientation at a 30° angle.
- Panels fixed to ground mounting system with auger driven ground connection.
- System to provide 11kWp.
- Vertex S+ Dual Glass N type i-TOPCon Modules.
- Maximum power output per panel 450W.
- Panel dimensions: (L)1762mm x (W)1134mm x (D)30mm.
- 26nr panels overall in portrait 13*2 configuration.

PROPOSED SITE PLAN

1:200

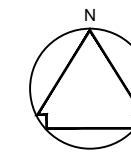
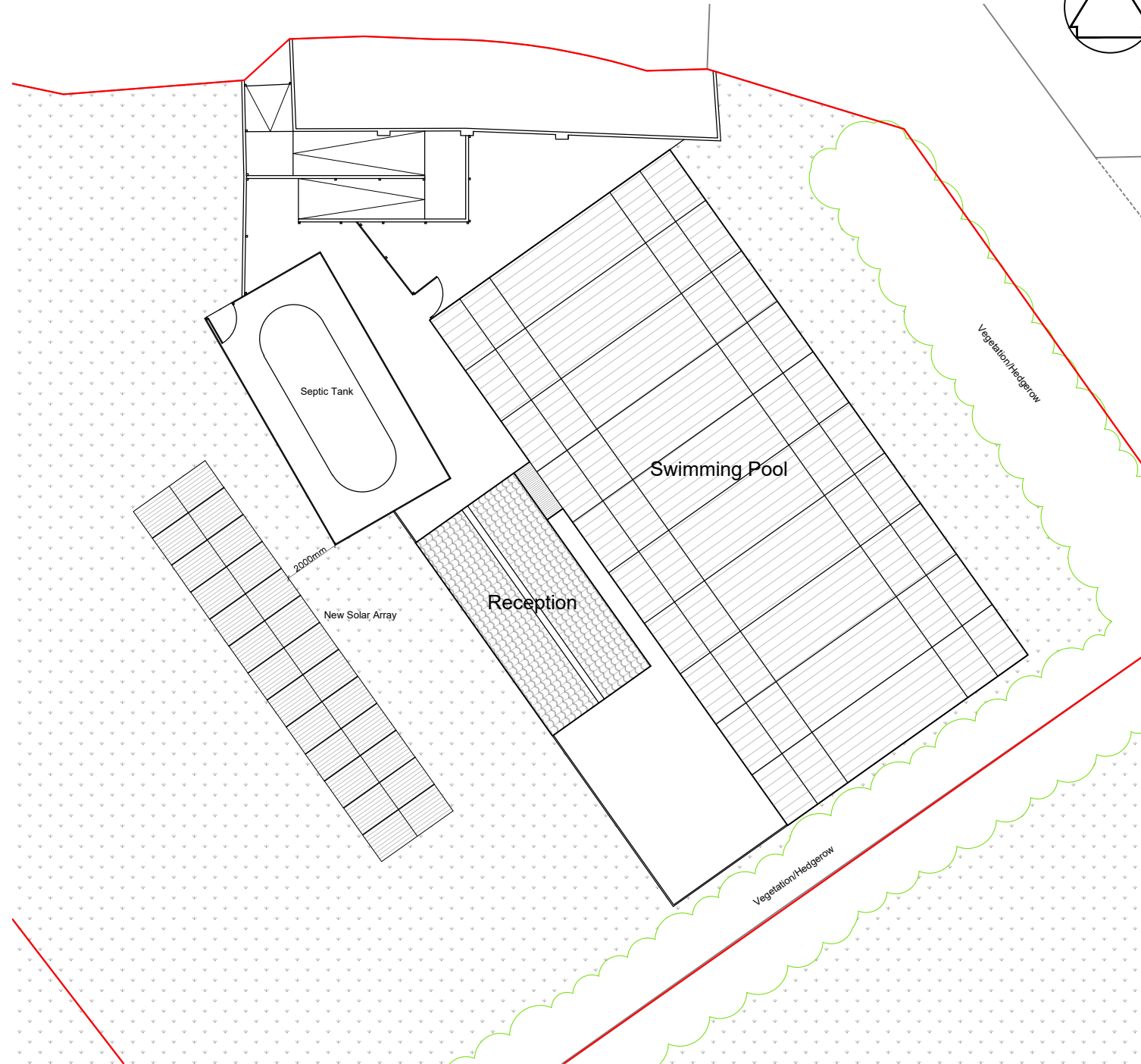

This drawing is the copyright of Currie & Brown Ltd.

Check all dimensions on site prior to project commencement. This drawing must be read in conjunction with all other drawings, details and specifications issues. Discrepancies between this and other drawings, details and/or specifications must be referred to the issuer.

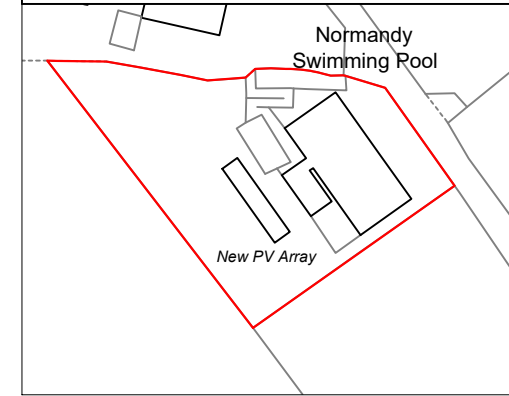

PROPOSED SITE PLAN

1:1250

RECEIVED
By Liv Rickman at 11:29 am, Apr 29, 2024

PV GROUND ARRAY - SIDE VIEW

NOT TO SCALE

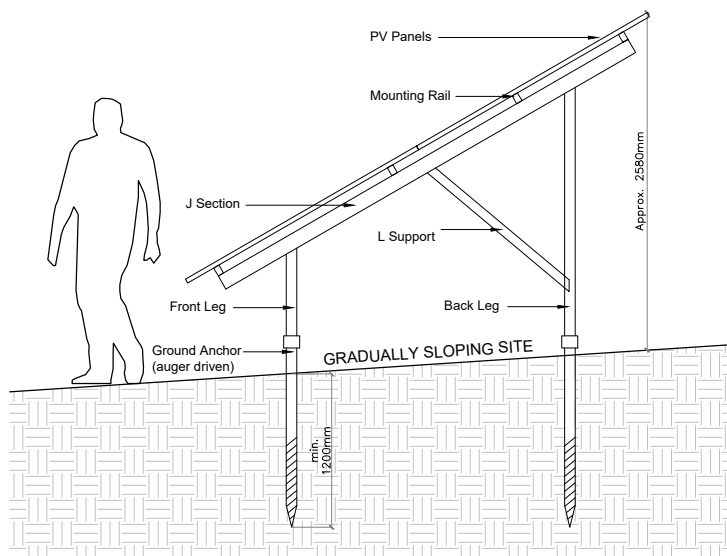

PV GROUND ARRAY - FRONT VIEW

NOT TO SCALE

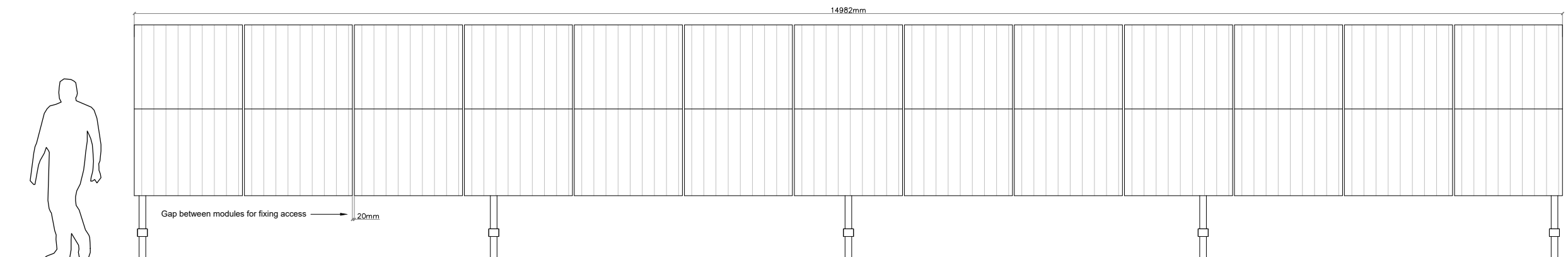

Rev	Date	Description
A	26.04.24	Change to proposed PV module



Unit 6, Mills Bakery, Royal William Yard,
Plymouth, Devon PL1 3GE
Tel: 01752 278 100 Web: www.curriebrown.com

Project
Normandy Pool Solar PV

Title
Proposed Site Plan

Client
Council of the Isles of Scilly

Date **13.03.2024** Drawn **AH**

Scale **1:200@A3** Checked **KC**

Drwg No. **PL4101565_NP_01_01** Rev **A**