

Type C - V1  
First Floor Plan  
M4(1)  
2B4P duplex flat 40.7m<sup>2</sup>

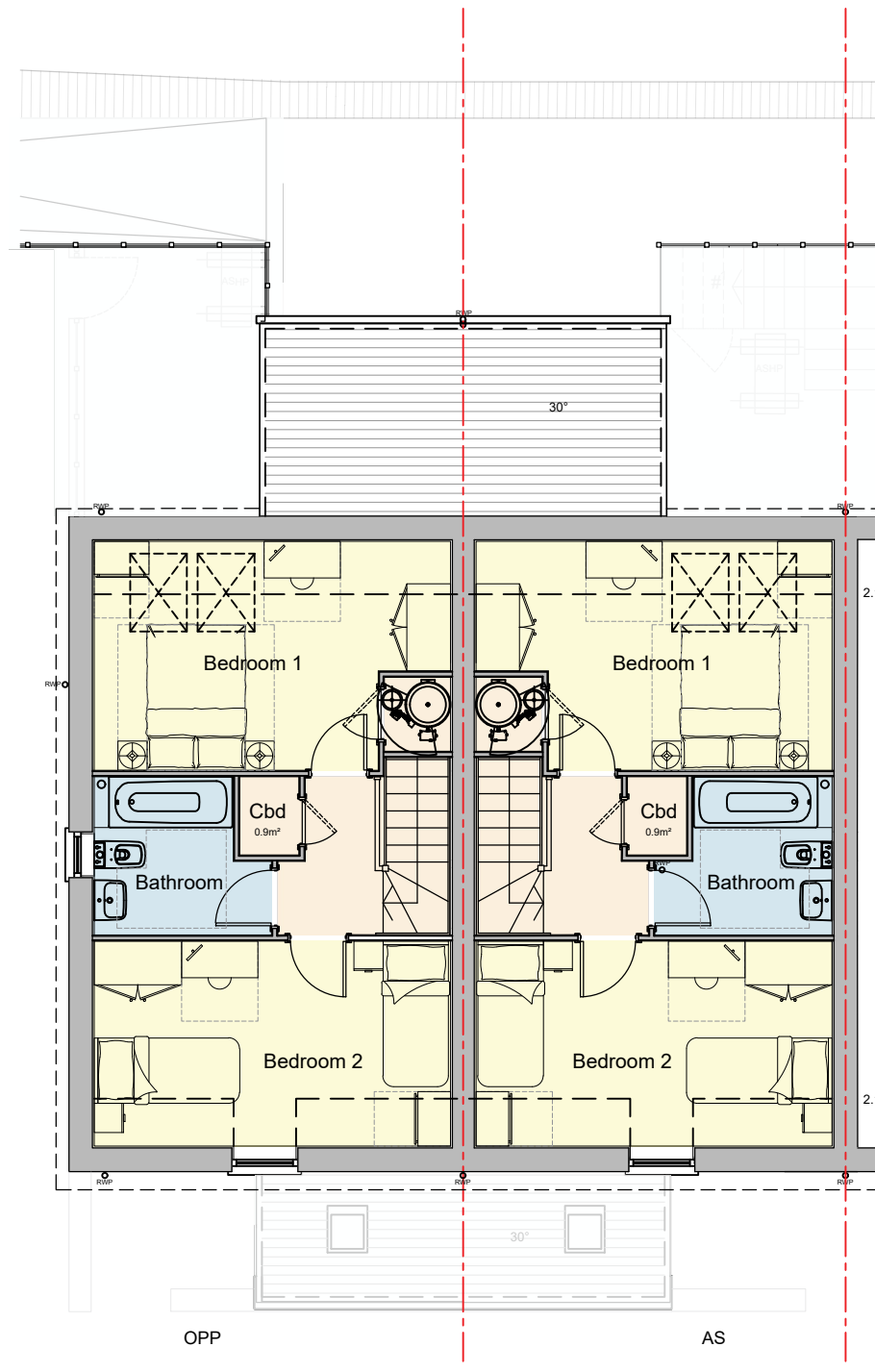

Type C - V2  
First Floor Plan  
M4(1)  
2B4P duplex flat 40.7m<sup>2</sup>

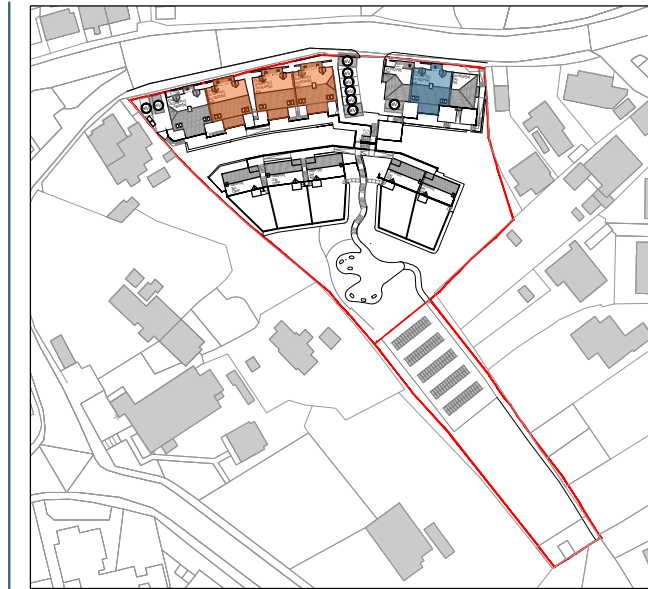

**Plot Orientation Plan**  
 ■ Type C - V1  
 As: 20  
 Opp: 21  
 ■ Type C - V2  
 As: 18,16,14,12  
 Opp: 19,17,15,13

**RECEIVED**  
 By Liv Rickman at 4:55 pm, May 03, 2024



**Perspective**  
 Indicative only, elevations take precedence



Project: Carn Thomas, St Mary's, Isles of Scilly  
 Title: Type C V1 & 2 - First Floor Plans  
 Client: Livewest  
 Date: March 2024  
 Drawn by: STA  
 Checked by: PM  
 Scale: 1:100 @ A3  
 Drawing No.: 21024 HT A,B,C-05

Rev.: F - Materials and PV panels updated

