

Type C - V1
Upper Ground Floor Plan
M4(1)
2B4P duplex flat 40.7m²

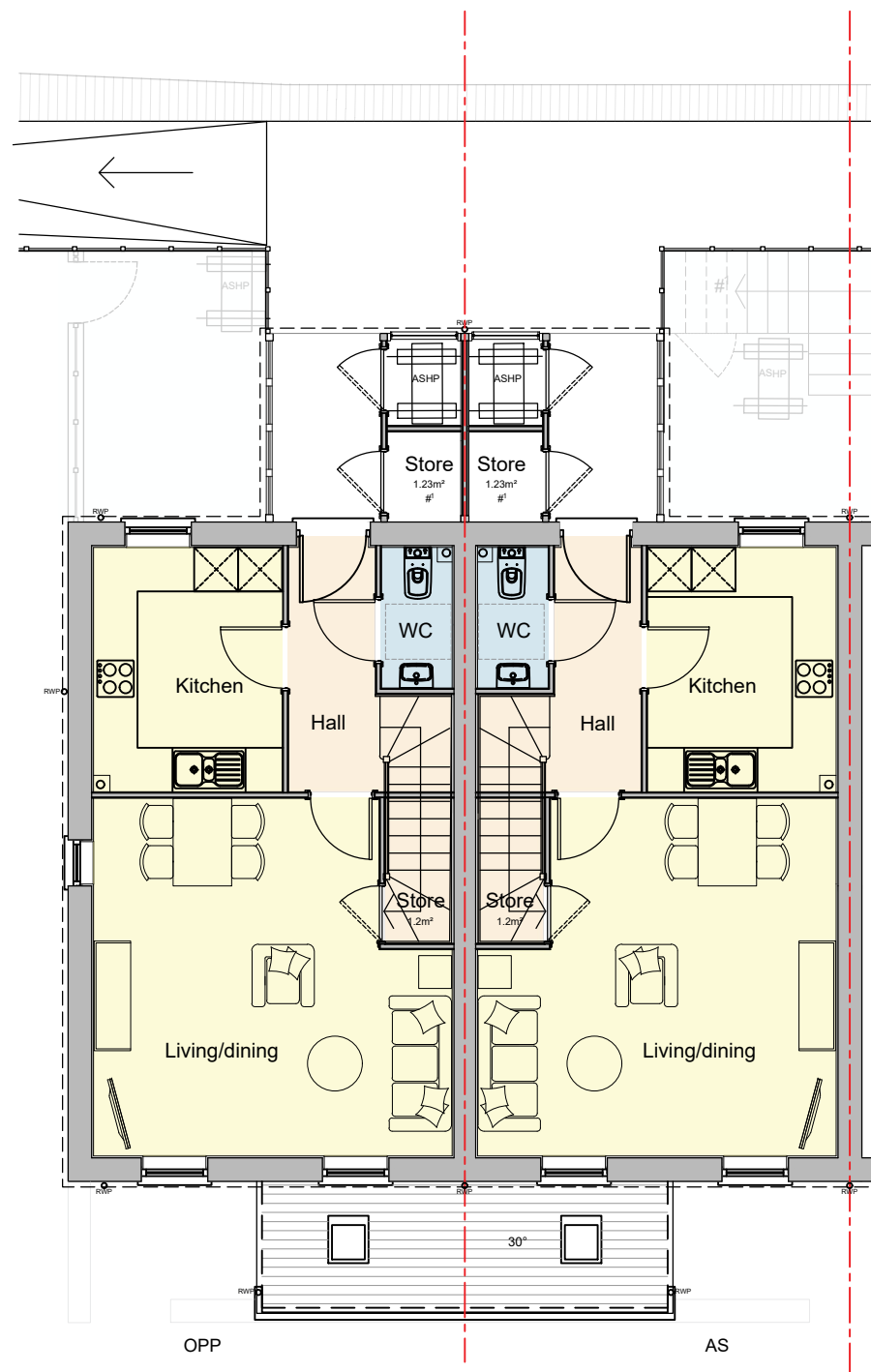

Type C - V2
Upper Ground Floor Plan
M4(1)
2B4P duplex flat 40.7m²

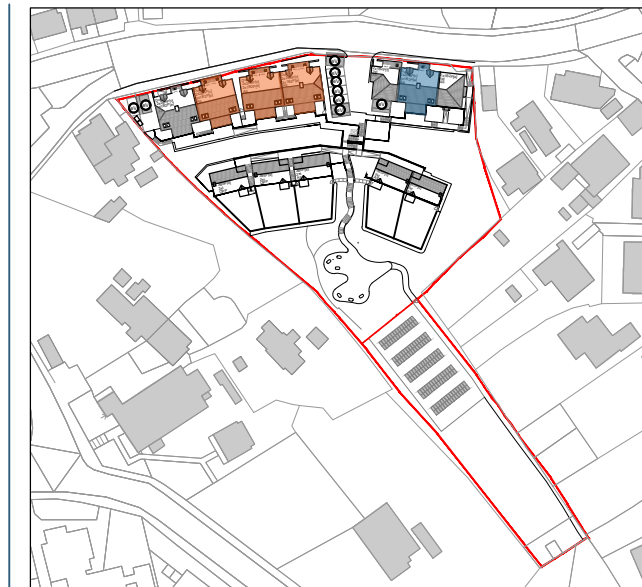

Plot Orientation Plan

- Type C - V1
As: 20
Opp: 21
- Type C - V2
As: 18,16,14,12
Opp: 19,17,15,13

RECEIVED
By Liv Rickman at 4:53 pm, May 03, 2024



Perspective
Indicative only, elevations take precedence



Project: Carn Thomas, St Mary's, Isles of Scilly
 Title: Type C - V1 & 2 - Upper Ground Floor Plans
 Client: Livewest
 Date: March 2024
 Drawn by: STA
 Checked by: PM
 Scale: 1:100 @ A3
 Drawing No.: 21024 HT A,B,C-03

Rev.: F - Materials and PV panels updated

