

VAN DER VALK



SOLAR SYSTEMS

Van der Valk Solar Systems
ValkPro+ Landscape 10° South

Version: 1.0

RECEIVED

By Liv Rickman at 12:45 pm, Jul 01, 2024

ValkPro+ Landscape 10°

Suitable panel length: 1520 - 2320 mm

Suitable panel width: 977 - 1350 mm

Panel inclination: 10°

Available pitch: 1300 - 1600 mm (default 1500 mm)

* See next page for system details and drawings.

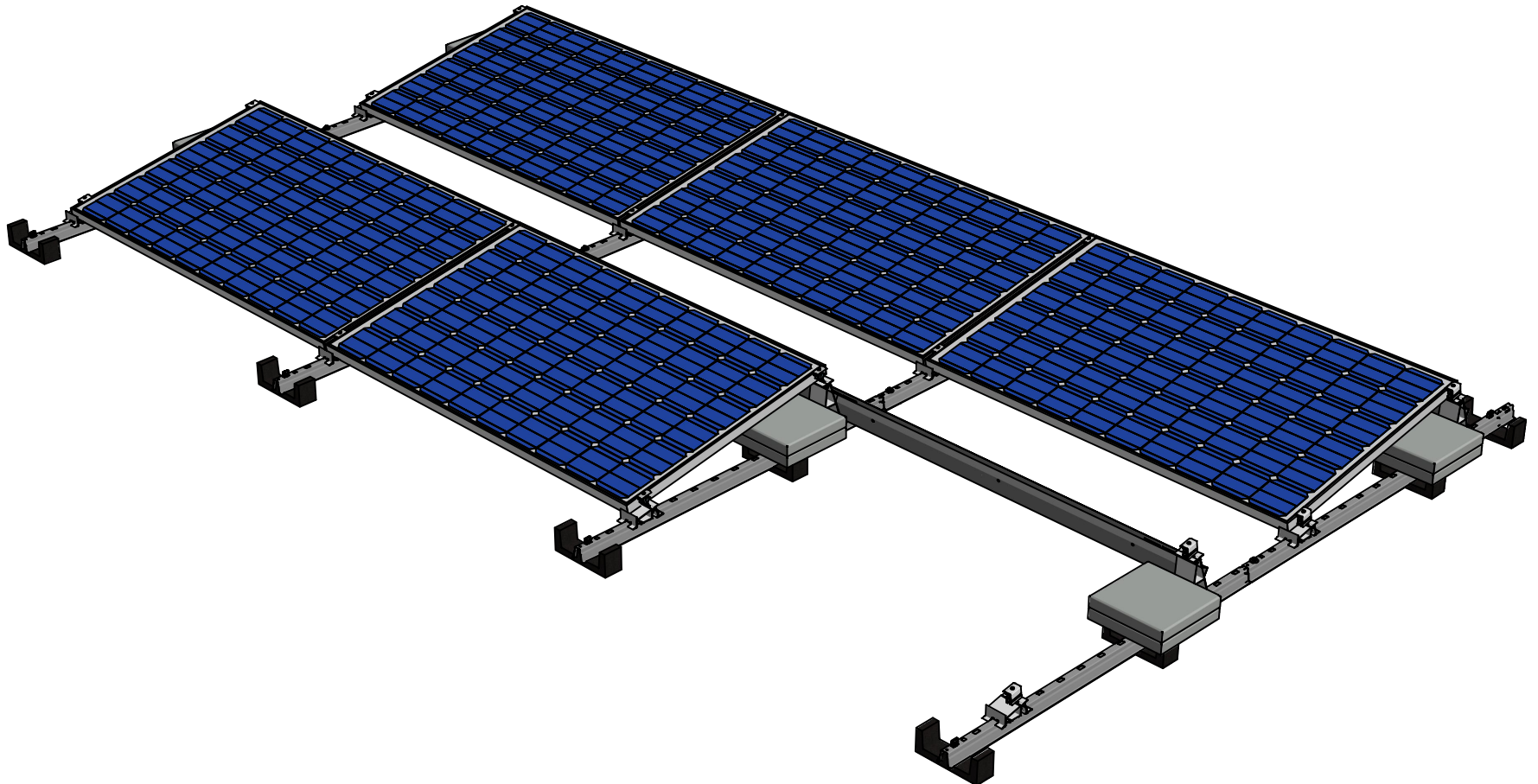



Foundation types:

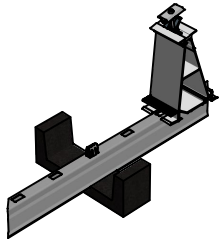

Rubber tile carriers:
Bitumen / EPDM / Concrete / PVC

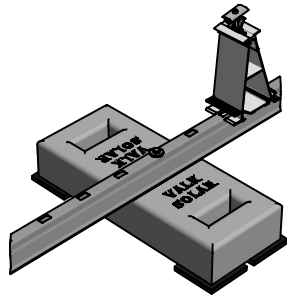

Mass blocks:
Roof or field systems

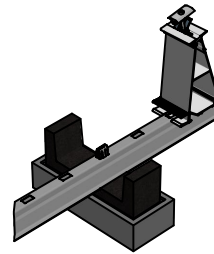

Elevation blocks:
for gravel roofs

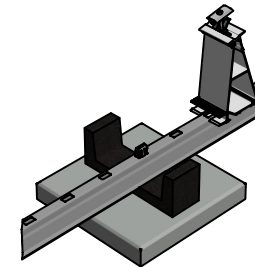

Foundation tile:
for sedum / green roofs
or field systems

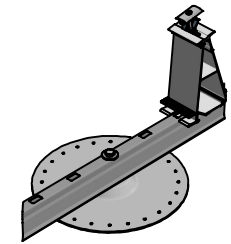

ValkSolarFix:
for mechanical fixation

Ballast options:

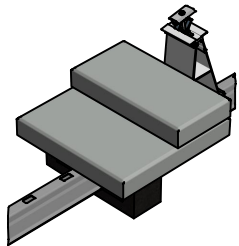

Rubber tile carriers

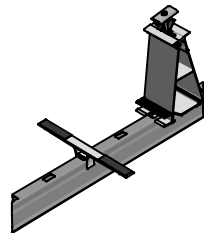

Ballast wings

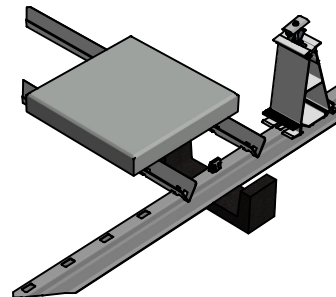

Mass carriers

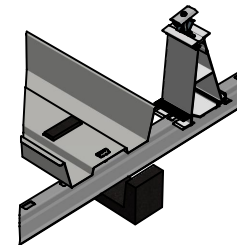

Ballast trays

Technical dimensions:

