

FLAGPOLE - ELEVATION VIEW
1:50

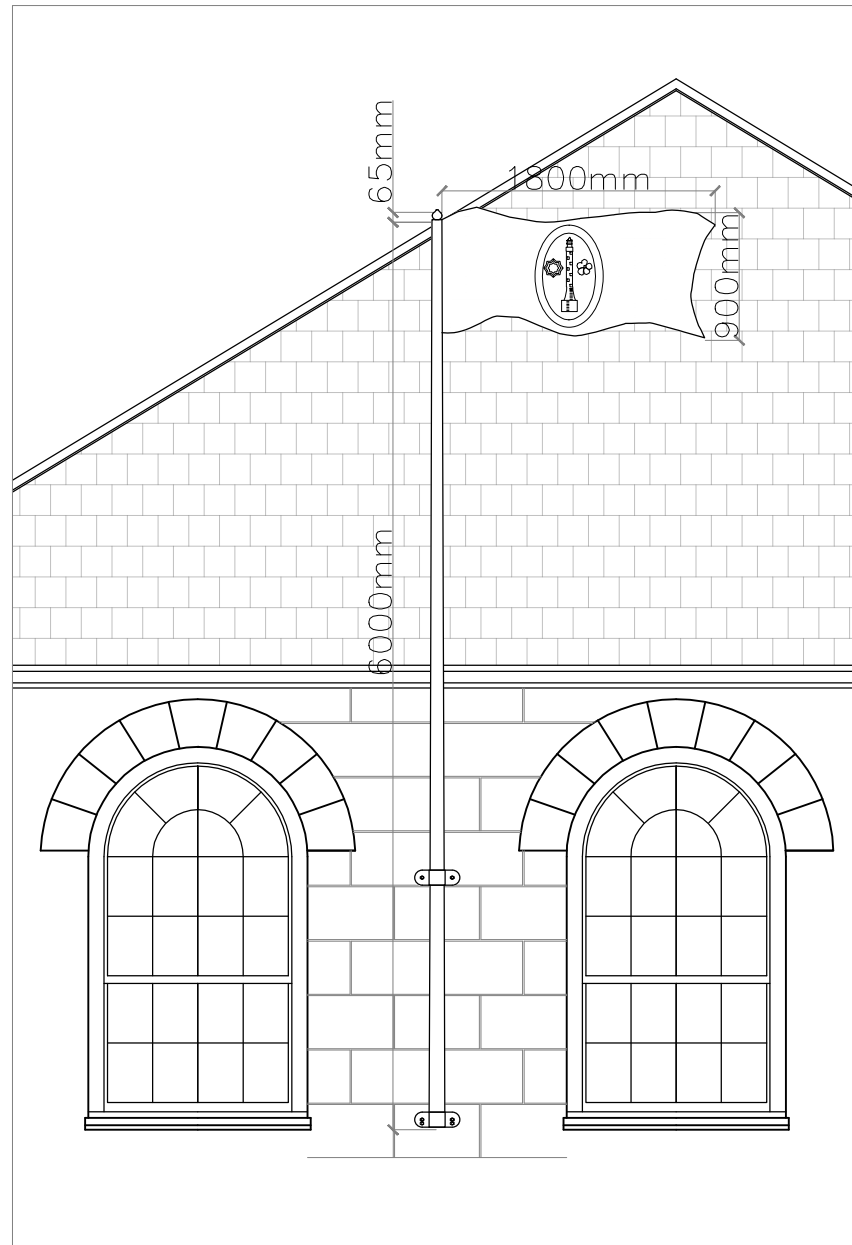

NOTE: The granite block spacing is diagrammatic and approximately to scale.

FLAGPOLE FIXING DETAILS
1:20

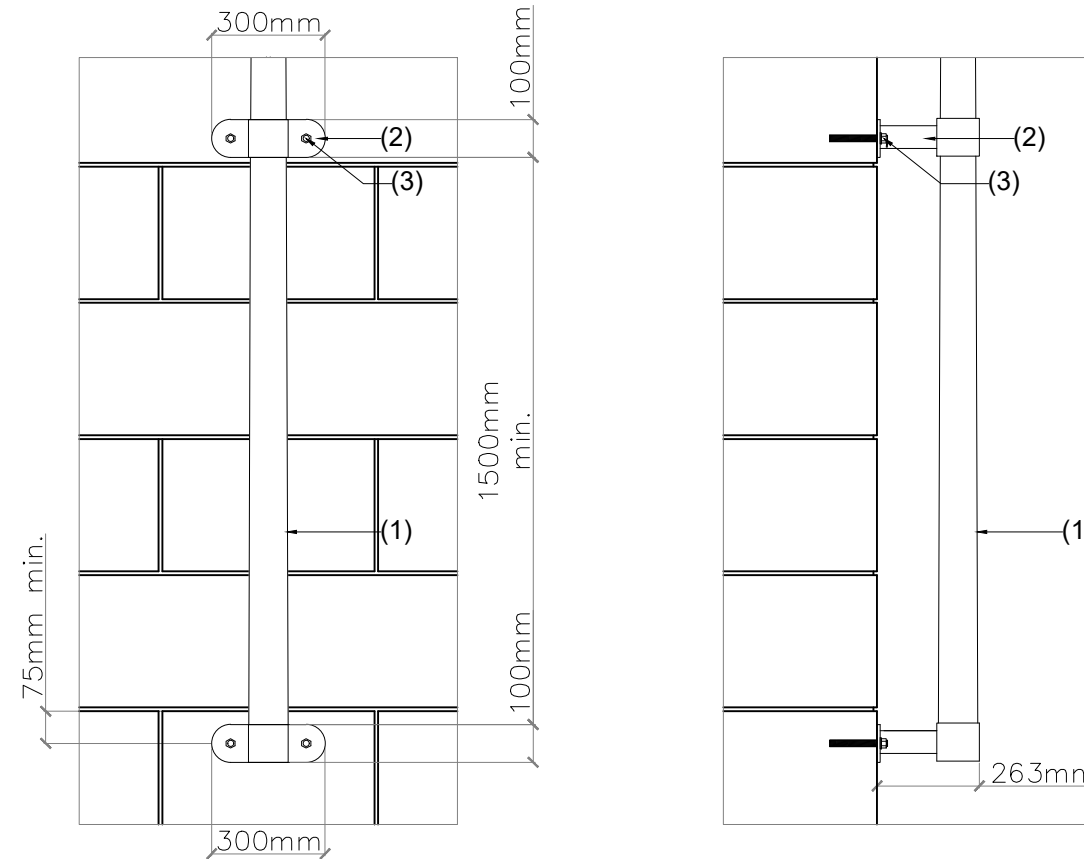

NOTES:

- (1) Heavy duty glassfibre and polyester resin flagpole. The 1500mm spacing between holding brackets may need to be increased slightly more than shown to ensure a minimum of 75mm edge distance can be maintained to the granite block edges.
- (2) Custom made galvanised steel holding brackets. 2nr brackets with 2nr fixings in each bracket (4nr fixings in total).
- (3) Stainless steel A4 (316) M12 Grade 8.8 threaded bar and washer with Rawl R-KEM II resin fixed through into the existing granite blocks.

FLAGPOLE FIXING DETAILS
1:10

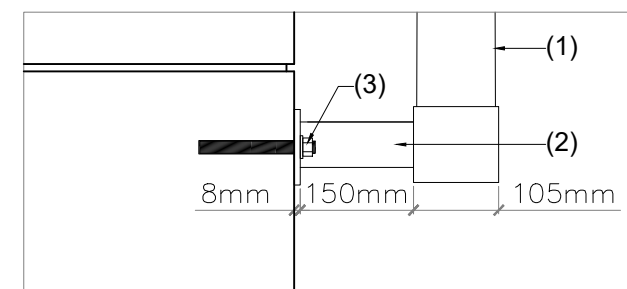

RECEIVED
By Liv Rickman at 10:47 am, Sep 18, 2024

Rev	Date	Description
		
Unit 6, Mills Bakery, Royal William Yard, Plymouth, Devon PL1 3GE Tel: 01752 278 100 Web: www.curriebrown.com		
Project Wesleyan Chapel Flagpole Installation		
Title Fixing Details		
Client Council of the Isles of Scilly		
Date	17.09.2024	Drawn AH
Scale	1:50/1:20/1:10	Checked AH
Drwg No.	PL_4101565_WC_03	Rev