

RECEIVED

By Liv Rickman at 10:20 am, Oct 21, 2024

This drawing is the copyright of Currie & Brown Ltd.

Check all dimensions on site prior to project commencement. This drawing must be read in conjunction with all other drawings, details and specifications issues. Discrepancies between this and other drawings, details and/or specifications must be referred to the issuer.

FLAGPOLE - ELEVATION VIEW
1:50

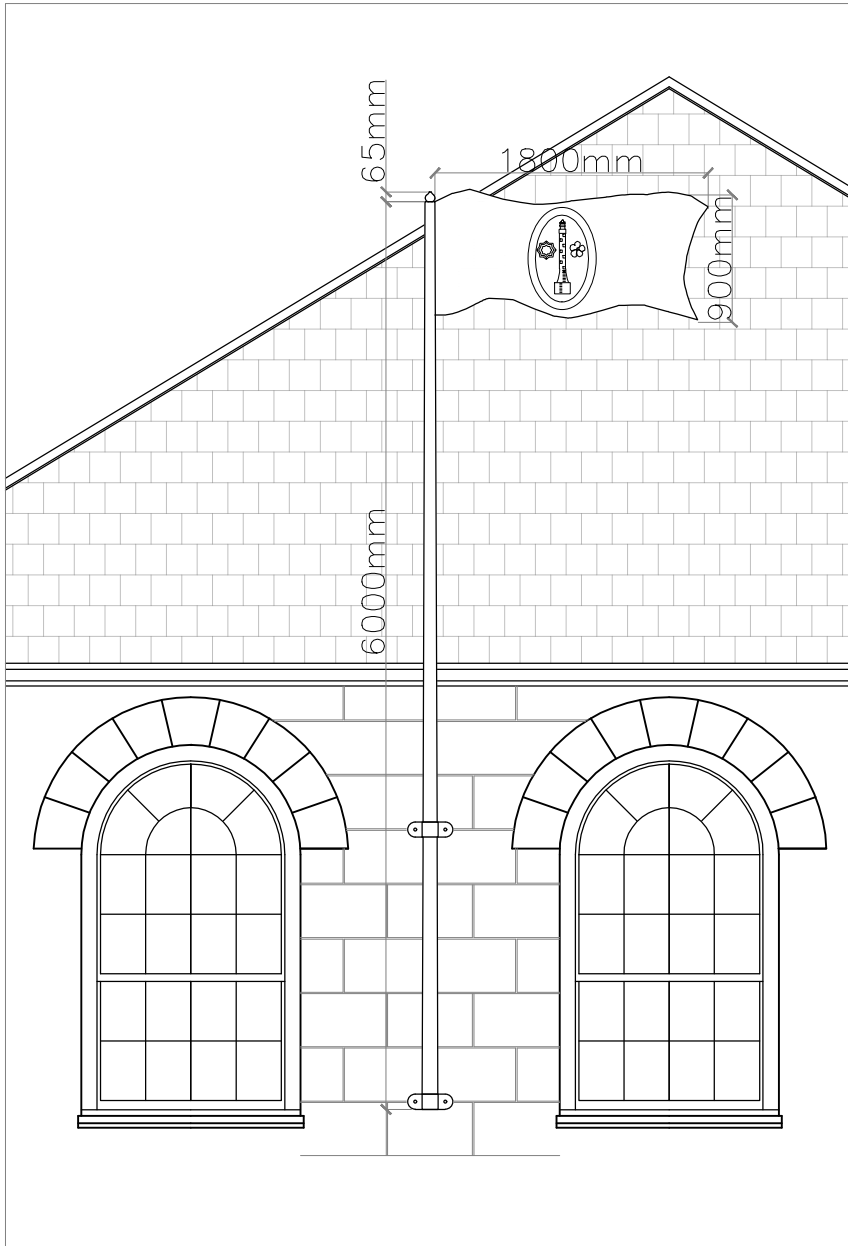

NOTE: The granite block spacing is diagrammatic and approximately to scale.

FLAGPOLE FIXING DETAILS
1:20

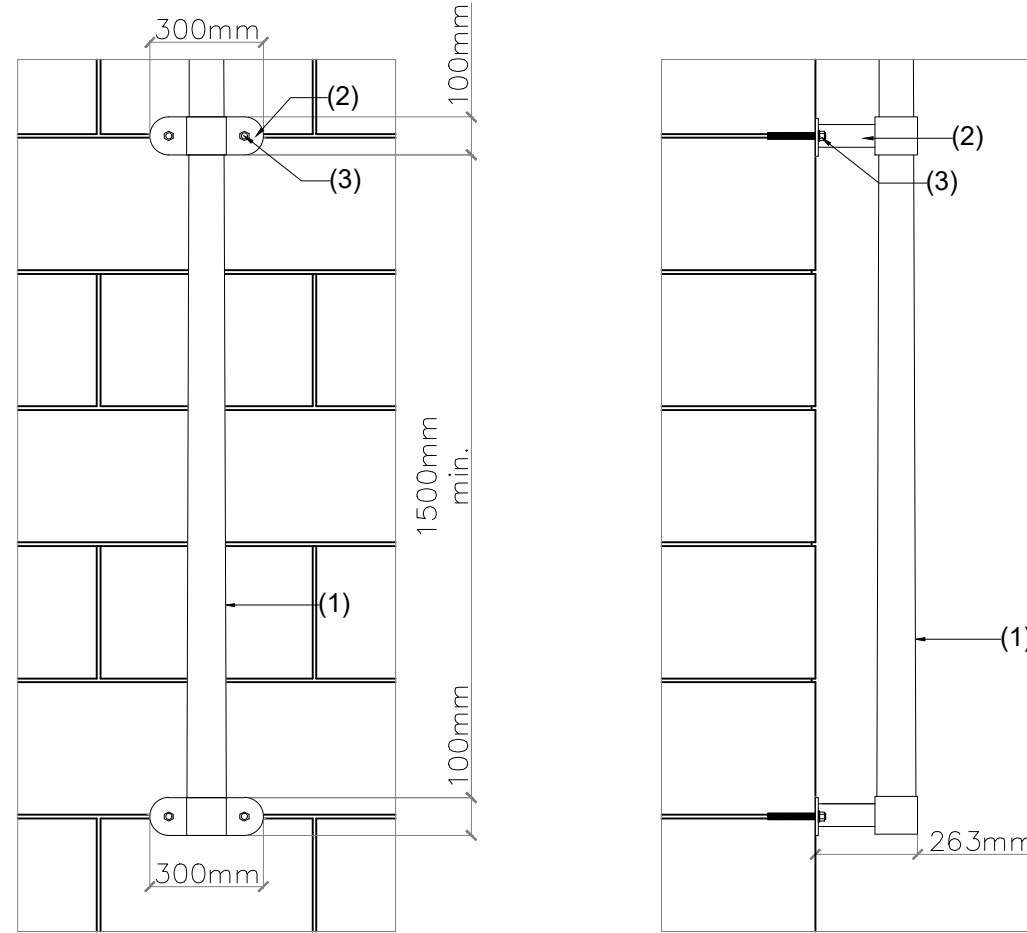

NOTES:

- (1) Heavy duty glassfibre and polyester resin flagpole. 1500mm min. spacing between holding brackets fixed through to mortar joints.
- (2) Custom made galvanised steel holding brackets. 2nr brackets with 2nr fixings in each bracket (4nr fixings in total).
- (3) Stainless steel A4 (316) M12 Grade 8.8 threaded bar and washer with Rawl R-KEM II resin fixed through into the existing granite blocks.

FLAGPOLE FIXING DETAILS
1:10

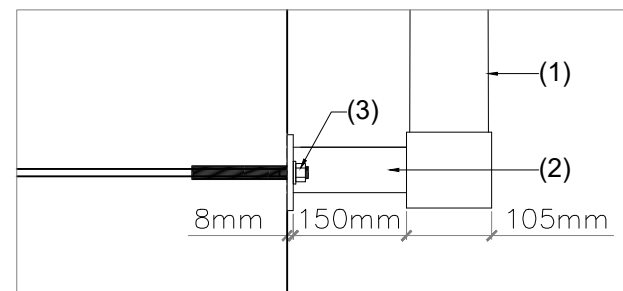

Rev	Date	Description
A	21.10.24	Fixing through mortar joints

CB Currie & Brown

Unit 6, Mills Bakery, Royal William Yard,
Plymouth, Devon PL1 3GE
Tel: 01752 278 100 Web: www.curriebrown.com

Project
**Wesleyan Chapel
Flagpole Installation**

Title
Fixing Details

Client
Council of the Isles of Scilly

Date **17.09.2024** Drawn **AH**

Scale **1:50/1:20/1:10** Checked **AH**

Drwg No. **PL_4101565_WC_03** Rev **A**