





RECEIVED

By Liv Rickman at 11:51 am, Sep 13, 2024

Drainage Legend (all to be confirmed on site by Contractor prior to works commencing):

Existing below ground combined wastewater drainage (private as confirmed with SW Water) 

-  existing inspection chamber
-  existing gully
-  existing soil vent pipe
-  existing down pipe

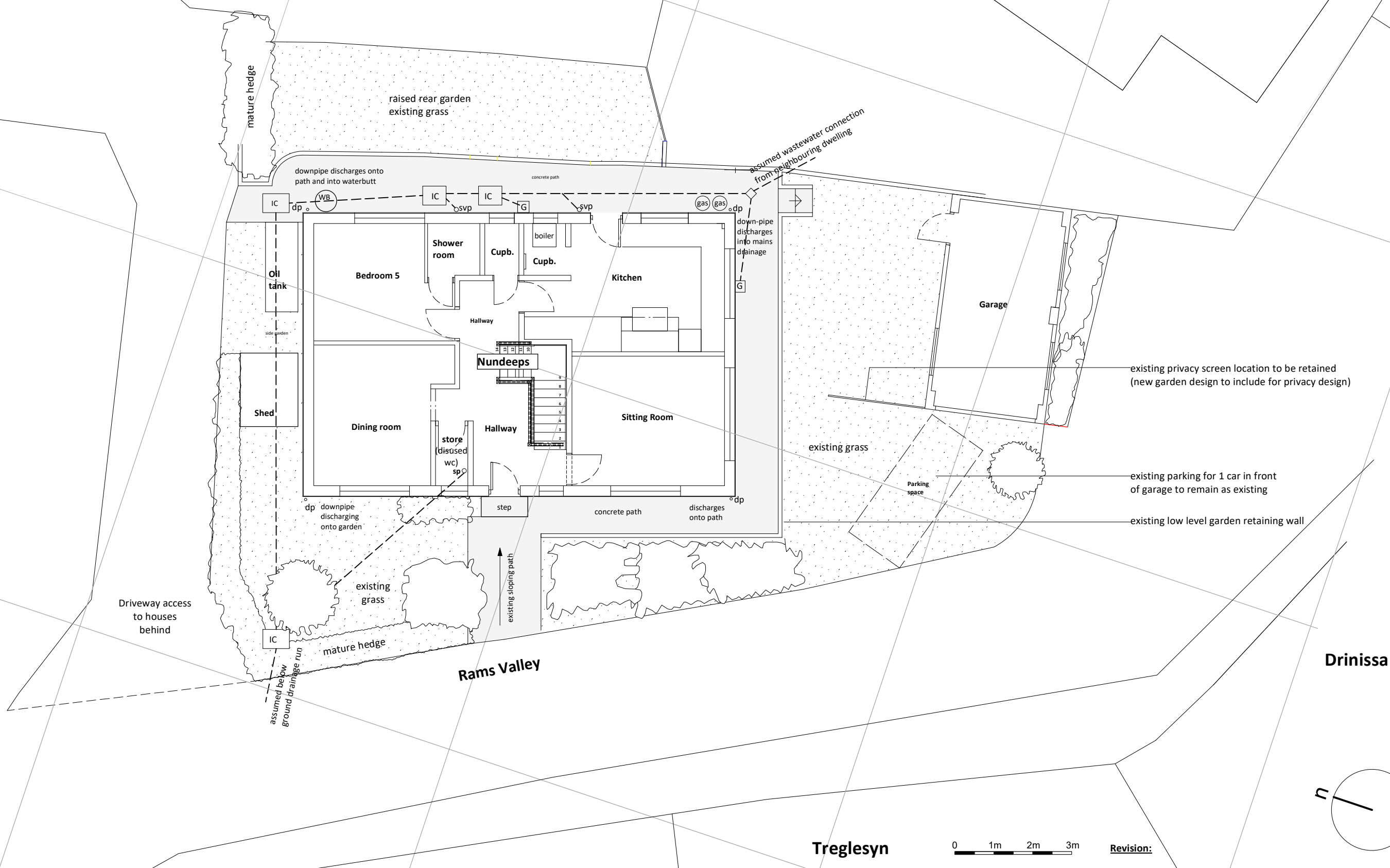

- existing privacy screen location to be retained (new garden design to include for privacy design)
- existing parking for 1 car in front of garage to remain as existing
- existing low level garden retaining wall

| | |
|----------------------------------|--------|
| Existing house internal GF area: | 71sqm |
| Existing house internal FF area: | 71sqm |
| | 142sqm |

| | | |
|---|-------------------------------|--|
| <p>Louise Bastable RIBA</p> <p>129 The Butts, Frome, BA11 4AQ</p> <p>T: 07801 106 192</p> <p>E: louisebastable@lbarch.co.uk</p> <p>W: www.lbarch.co.uk</p> | Revision: | Project Name: Nundeeps, Rams Valley, st. Marys, TR21 0JX |
| | Scale: 1: 100 @ A3 | Project Number: 2360 |
| | Date: July 2024 | Client: Liz Lourensz |
| | Status: Plannning Application | Drawing: Existing GF plan |
| | | Drawing Number: PL02 |

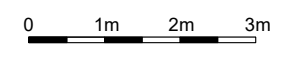
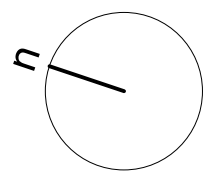

Treglesyn

Drinissa

Rams Valley

Driveway access to houses behind