



## Isles Of Scilly Culture Centre and Museum Logistics



# LOGISTIC NOTES

The following Logistic Plan is to be read in conjunction with the current project programme.

All transportation of both visitors and operatives will be organised via STP travel manager based in Wantage.

All transportation requirements for visitors and operatives must be requested to the IOS Project Manager who will pass the relevant details on to STP travel Manager.

The travel arrangement will be from either, a flight from Lands' End Airport to St Marys Airport, or by ferry from Penzance quay to St Marys quay.

On arrival to St Marys, the operative or visitor will make their way to the site and then be taken to the Bunkabin accommodation village where STP have up to 16 single bunkabins and two diners. (Please see the Bunkabin layout further within this document)

All visitors and operatives will be offered a packed lunch and a two course evening meal at a specific restaurant.

All materials not arranged by STP must be booked in with the Steamship Company who will arrange transport from Penzance to St Marys; it is the sub contractors responsibility to arrange for the transport to Penzance.

For smaller items, there is an additional storage facility with The Steamship Company located in Hayle; again, all materials must be arranged with The Steamship Company prior to arriving to Hayle.

Any items arriving at Hayle will be transported to Penzance by The SSC who will transport the materials to St Marys Quay and deliver the items to site.

All plant and material required on site will be coordinated with the STP Management where storage space will be allocated, but materials and plant must only be scheduled on an "as required basis to allow for onsite production for a two-week period".

Stepnell has a storage facility on St Marys; this storage is to be used as a "back stop" to store plant and material on temporary basis.

There is no crane on site, any plant or material requiring lifting will be via the use of loading bays and crane mounted lorry.

Working hours are 0800 - 1800 Monday to Friday and 0800 - 1400 Saturdays

No working during bank holidays and Sundays



# CURRENT SITE SET UP

Party wall scaffold

Lower level entrance into building

No scaffold fan will be required; all scaffold facing/affecting members of the public will be protected with double boards with polythene sandwiched between boards and debris netting fitted

Solid site hoarding to prevent neighbouring access into the site

Site hoarding and Road Closure

All outbuildings to be demolished to form site compound. Shed to be relocated

Scaffold line

Fire Curtain around Recycling area if 6 meter clearance can not be achieved

Site hoarding line to 1500mm for pedestrian access.

Fully enclosed skips and recycling area

Welfare units placed as not to block neighbouring light. Welfare units to be connected to the existing foul drain below

Car parking space for drop off and collection

Pedestrian Separation Barrier

Site lockable entrance gates; gates to be placed to follow existing car parking white lines

Emergency muster point

COSHH and Refill Area

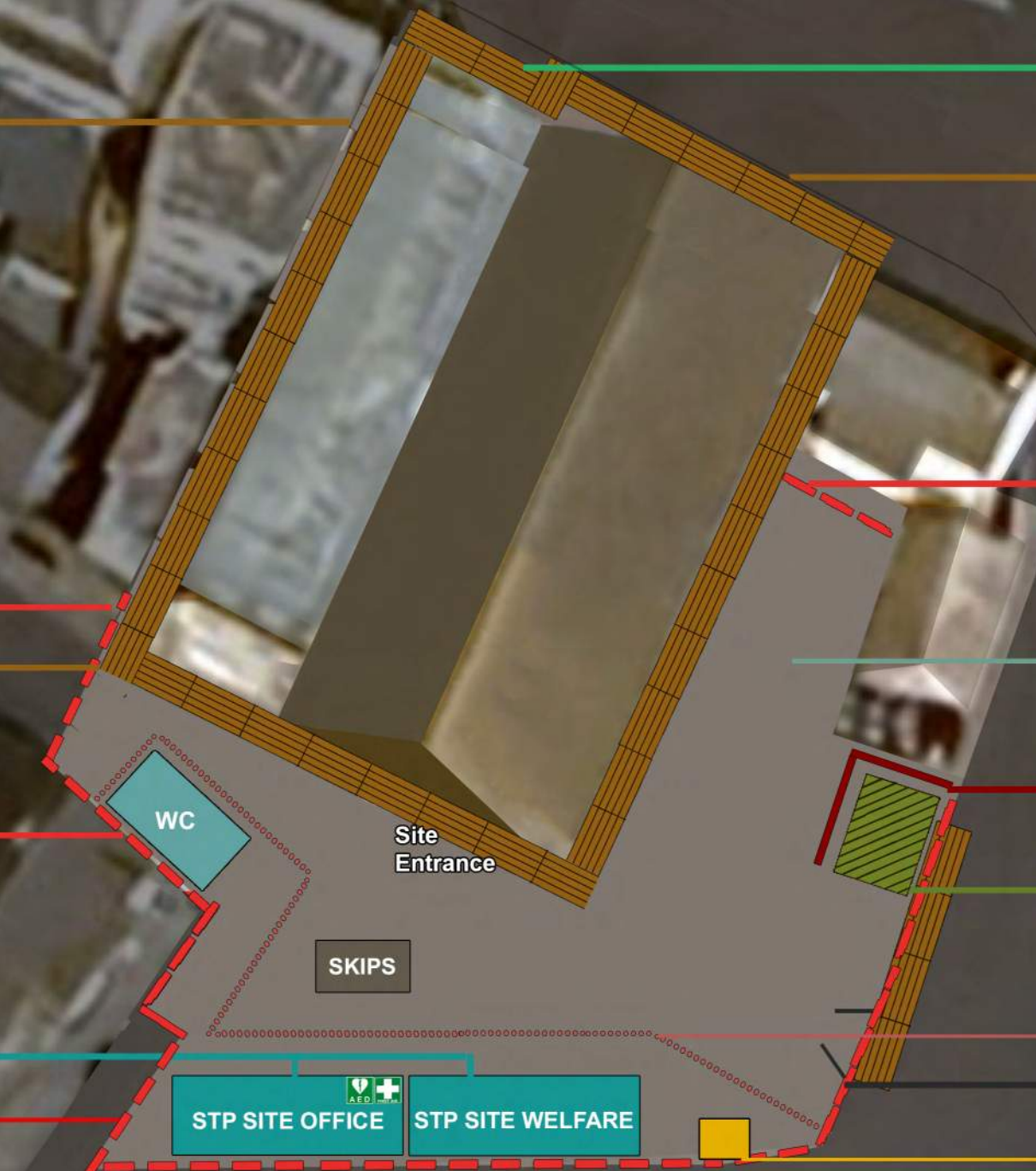



# SECOND PHASED PROPOSED SITE SET-UP

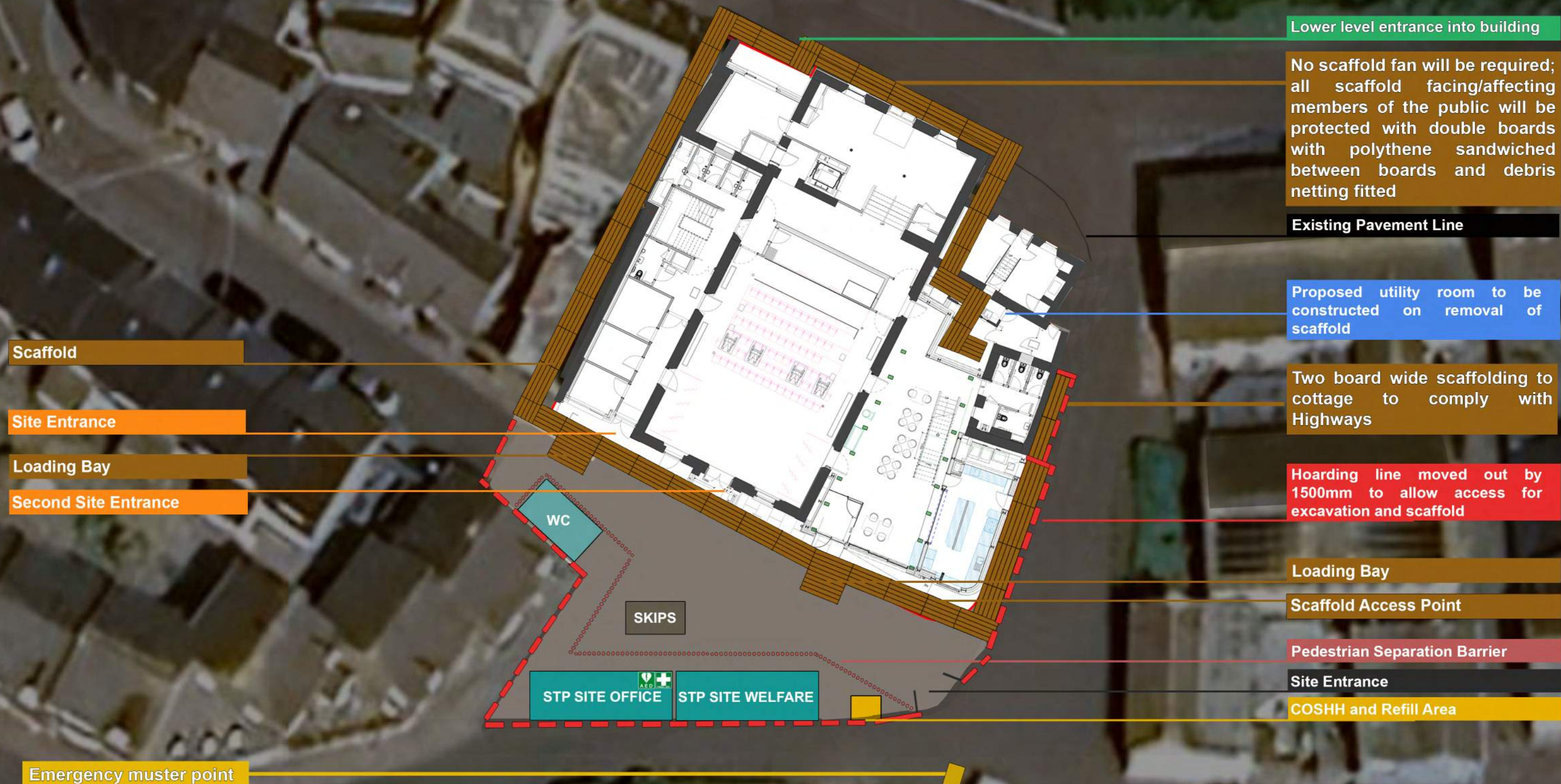



# FINAL PROPOSED SITE SET-UP





# STORAGE YARD

Storage Yard

Isles of Scilly Culture  
Centre and Museum



# Accommodation Village (indicative)

During Main Works



Bespoke Sleeper Unit



Bespoke Junior Diner



Defender V Mesh Temporary Fencing with BraceBlok - 2.4m



Vehicle Gates

## Stepnell Accommodation During Main Works

Isles of Scilly

2386-STP-XX-XX-DR-PM-1001

General Arrangement Plan

Stoneyard, Moorwell Lane, St Mary's  
Block Plan - SYBP1

Date: 13.06.24

Drawn by: AS

Scale @ A1 1:50

Check by: SH

Rev: 01

Project No: 2386

**STEPNELL**

COMPLETE CONSTRUCTION PARTNER