

Existing Section A-A / SW Elevation
1:100

Datum 0.00m A.D.D

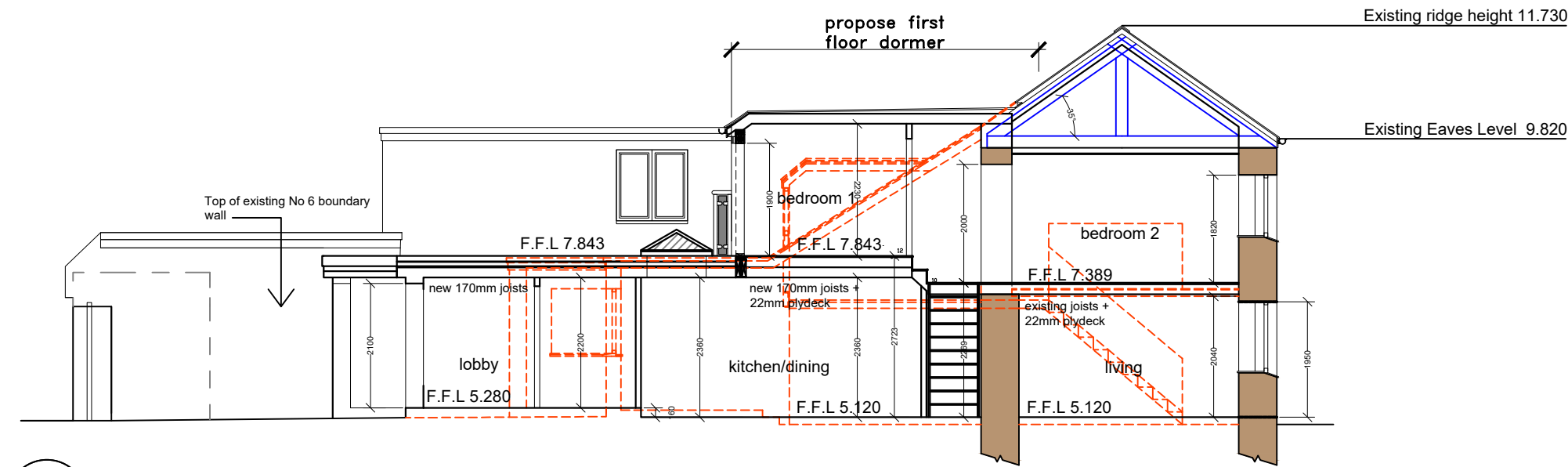

Proposed Section A-A / SW Elevation
1:100

Datum 0.00m A.D.D

GENERAL NOTES.

THIS DRAWING IS PROTECTED BY 'COPYRIGHT' AND MUST NOT BE COPIED WITHOUT PRIOR PERMISSION FROM LIVING DESIGNS

THIS DRAWING HAS BEEN PREPARED TO OBTAIN PLANNING CONSENT ONLY THEREFORE THESE PLANS SHOULD NOT BE USED FOR CONSTRUCTIONAL PPURPOSES.

THESE PLANS MUST BE READ IN CONJUNCTION WITH ALL DRAWINGS, DETAILS, CALCULATIONS & SPECIFICATIONS ISSUED FOR CONSTRUCTIONAL PURPOSES BY LIVING DESIGNS, THE STRUCTURAL ENGINEER AND ALL RELEVANT SUPPLIERS AND MANUFACTURERS.

ANY WORKS CARRIED OUT ON SITE BY THE CLIENT OR HIS MAIN/SUB CONTRACTORS PRIOR TO APPROVAL (OR THE SUBMISSION OF ANY ADDITIONAL INFORMATION OR DETAILS OR SAMPLES OR CALCULATIONS OR REPORTS REQUESTED BY THE PLANNING DEPARTMENT IN ANY CONDITIONAL APPROVAL) IS CARRIED OUT ENTIRELY AT THEIR OWN RISK.

IT SHALL BE BOTH THE CLIENTS AND PRINCIPLE CONTRACTORS RESPONSIBILITY TO EMPLOY A FULLY QUALIFIED CDM COORDINATOR, OR ALTERNATIVELY NOTIFY HSE TO ENSURE THE REQUIREMENTS OF THE CURRENT LEGISLATION COVERED BY THE CONSTRUCTION (DESIGN AND MANAGEMENT) REGULATIONS 2015 & THE HEALTH AND SAFETY AT WORK ACT AS WELL AS THE MANAGEMENT OF HEALTH AND SAFETY AT WORK ACT ARE COMPLIED WITH BY ALL SITE STAFF/SUPPLIERS ETC DURING THE VARIOUS STAGES OF THE DESIGN AND CONSTRUCTION WORKS.

IF IN DOUBT ASK

RECEIVED
By Tom.Anderton at 11:18 am, Oct 23, 2025

B	Project title amended	21.10.25
A	Roof terrace removed and lantern to replace skylights	20.10.25

Revisions

Demolition of ground floor extensions.
Proposed replacement ground floor extension.
Proposed first floor dormer.
Internal alterations.

Site Address:
7 Buzza Street,
St Mary's,
Isles of Scilly,
TR21 0HX

Client:
Mr Tony Fleming

Drawing Title:
Existing and Proposed Section A-A

PLANNING		
Scale	Drawn by	Date
1:100 @A3	KB	21/10/25
Drawing No	Rev	Purpose
KB0489.10	B	FOR APPROVAL